

TRACT 44698 - Portion of Block 24, West Delta Area, Plaquemines Parish, Louisiana

The beds and bottoms of all water bodies belonging to the State of Louisiana located in Block 24, West Delta Area, together with any present lands formed by accretion to the shoreline or islands formed therein, located in Plaquemines Parish, Louisiana, owned by and not presently under mineral lease as of April 12, 2017, from the State of Louisiana, the geographical area of which is more fully described as follows: Beginning at a point on the Three Mile Line, as decreed by the Supreme Court of the United States, as determined by a Special Master appointed therein, in litigation styled *United States v. State of Louisiana et al No. 9 Original*, in 1975, having Coordinates of X = 2,581,526 and Y = 187,531; thence along said Three Mile Line the following courses: Northwesterly along an arc to the right having a radius of 18,240.60 feet and centered at X = 2,589,100 and Y = 204,125 to a point having Coordinates of X = 2,579,034 and Y = 188,914, Northwesterly along a straight line to a point having Coordinates of X = 2,577,635 and Y = 189,839, Northwesterly along an arc to the right having a radius of 18,240.60 feet and centered at X = 2,583,790 and Y = 207,010 to a point having Coordinates of X = 2,576,863 and Y = 190,136, and Northwesterly along a straight line to a point having Coordinates of X = 2,572,518 and Y = 191,920; thence North 6,669.97 feet to a point having Coordinates of X = 2,572,518.00 and Y = 198,589.97; thence East 12,038.87 feet to a point having Coordinates of X = 2,584,556.86 and Y = 198,589.97; thence South 5,902.00 feet to a point having Coordinates of X = 2,584,556.86 and Y = 192,687.97; thence West 3,030.87 feet to a point having Coordinates of X = 2,581,526.00 and Y = 192,687.97; thence South 5,156.97 feet to the point of beginning, containing approximately **2,208.91 acres, LESS AND EXCEPT** that portion thereof, if any, lying seaward of the line three nautical miles from the coast line of Louisiana, as said three mile line has been decreed by the Supreme Court of the United States, as determined by a Special Master appointed therein, in litigation styled **United States v. State of Louisiana et al No. 9 Original**, in 1975, all as more particularly outlined on a plat in the Office of Mineral Resources, Department of Natural Resources. All bearings, distances and coordinates are based on the Louisiana Coordinate System of 1927, (South Zone).

NOTE: The above description of the Tract nominated for the purpose of acquiring a mineral lease or a geophysical agreement has been provided and corrected, where required, exclusively by the nominating party. Any mineral lease or geophysical agreement selected from this Tract and awarded by the Louisiana State Mineral and Energy Board shall be without warranty of any kind, either express, implied or statutory including, but not limited to, title or the implied warranties of merchantability and fitness for a particular purpose.

An error or omission in the nominating party's Tract description may require that a State mineral lease or geophysical agreement be modified, canceled or abrogated due to the existence of conflicting leases,



operating agreements, private claims or other future obligations or conditions within the Tract described. In such case, however, the Louisiana State Mineral and Energy Board shall not be obligated to refund any consideration paid by the Lessee prior to such modification, cancellation or abrogation including, but not limited to, bonuses, rentals and royalties.

NOTE: The State of Louisiana does hereby reserve, and this lease shall be subject to, the imprescriptible right of surface use in the nature of a servitude in favor of the Department of Natural Resources, including its Offices and Commissions, for the sole purpose of implementing, constructing, servicing and maintaining approved coastal zone management and/or restoration projects. Utilization of any and all rights derived under this lease by the mineral lessee, its agents, successors or assigns, shall not interfere with nor hinder the reasonable surface use by the Department of Natural Resources, its Offices or Commissions, as herein above reserved.

Applicant: MARK A. O'NEAL AND ASSOCIATES, INC.

Bidder	Cash Payment	Price/Acre	Rental	Oil	Gas	Other

Legend

-  17040006
-  Blocks
-  Active_Leases

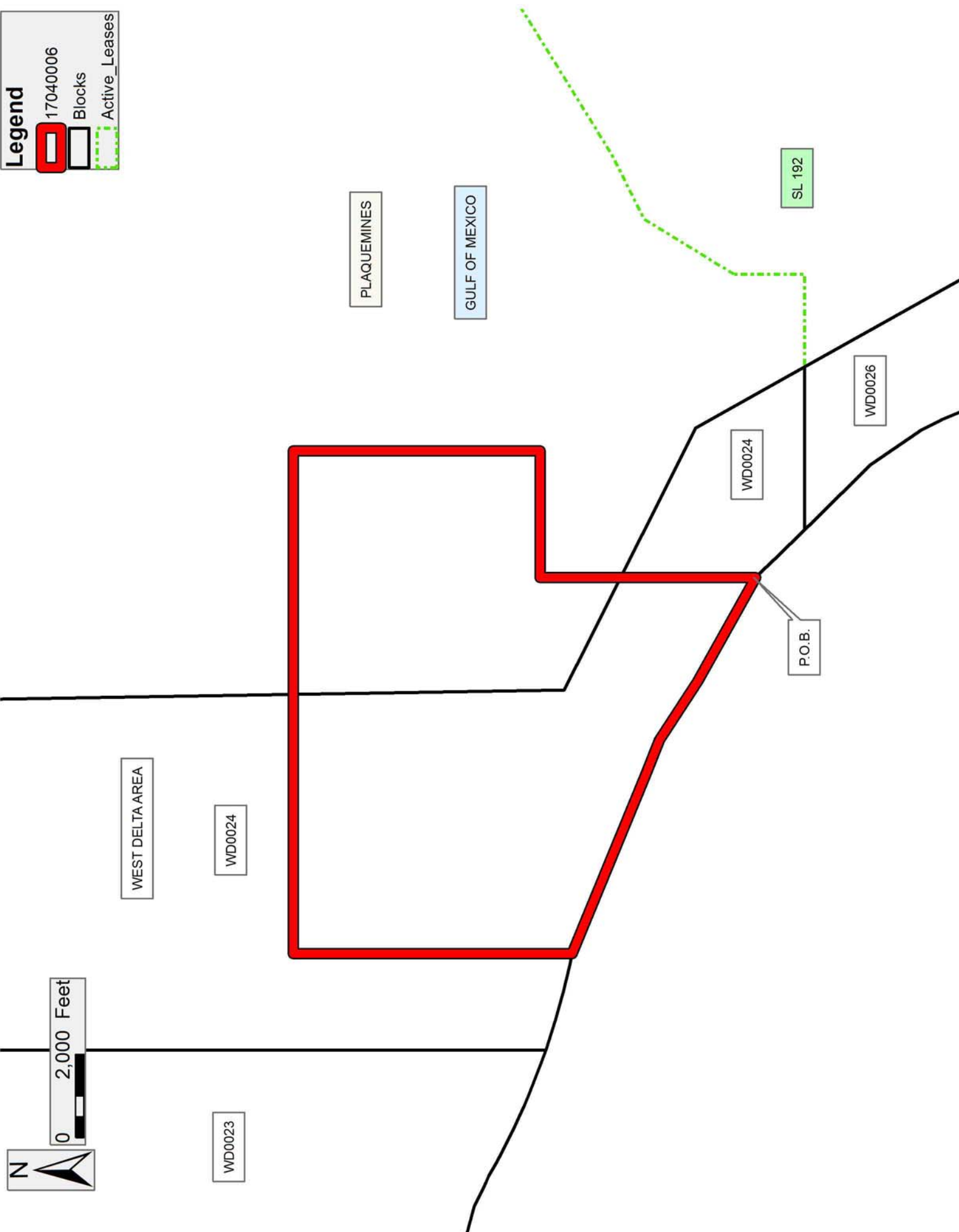

PLAQUEMINES

GULF OF MEXICO

WEST DELTA AREA

WD0024

WD0023

WD0024

WD0026

SL 192

P.O.B.

TRACT 44699 - Portion of Plaquemines Parish, Louisiana

The beds and bottoms of all water bodies belonging to the State of Louisiana located in together with any present lands formed by accretion to the shoreline or islands formed therein, located in Plaquemines Parish, Louisiana, owned by and not presently under mineral lease as of April 12, 2017, from the State of Louisiana, the geographical area of which is more fully described as follows: Beginning at a point on the Louisiana Coastline, as decreed by the Supreme Court of the United States, as determined by a Special Master appointed therein, in litigation styled *United States v. State of Louisiana et al No. 9 Original*, in 1975, having Coordinates of X = 2,596,225.77 and Y = 198,589.93; thence along said Coastline the following courses: Southeasterly on a straight line to a point having Coordinates of X = 2,598,335 and Y = 196,450; Southeasterly on a straight line to a point having Coordinates of X = 2,600,780 and Y = 192,900, Southeasterly on a straight line to a point having Coordinates of X = 2,601,940 and Y = 190,595, Southeasterly on a straight line to a point having Coordinates of X = 2,602,425 and Y = 189,395, Southeasterly on a straight line to a point having Coordinates of X = 2,602,860 and Y = 188,615, Southeasterly on a straight line to a point being on the boundary of State Lease No. 3263 having Coordinates of X = 2,603,028.85 and Y = 188,035.11; thence Westerly approximately 248 feet along the boundary of said State Lease No. 3263 to a point of intersection with State Lease No. 192, as amended; thence along the boundary of said State Lease No. 192, as amended, the following courses: Northwesterly and Southwesterly to a point having Coordinates of X = 2,597,250.00 and Y = 195,200.00; thence continue along the boundary of State Lease No. 192, as amended, the following courses: South 42 degrees 26 minutes 10 seconds West 2,371.18 feet to a point having Coordinates X = 2,595,650.00 and Y = 193,450.00, and South 58 degrees 15 minutes 10 seconds West 1,448.25 feet to a point having Coordinates X = 2,594,418.44 and Y = 192,687.97; thence West 9,861.58 feet to a point having Coordinates of X = 2,584,556.86 and Y = 192,687.97; thence North 5,902.00 feet to a point having Coordinates of X = 2,584,556.86 and Y = 198,589.97; thence East 11,668.91 feet to the point of beginning, **LESS AND EXCEPT** any portion of State Lease No. 192, as amended, that may lie within the above described tract, containing approximately **1,734 acres**, all as more particularly outlined on a plat on file in the Office of Mineral Resources, Department of Natural Resources. All bearings, distances and coordinates are based on Louisiana Coordinate System of 1927, (North or South Zone).

NOTE: The above description of the Tract nominated for the purpose of acquiring a mineral lease or a geophysical agreement has been provided and corrected, where required, exclusively by the nominating party. Any mineral lease or geophysical agreement selected from this Tract and awarded by the Louisiana State Mineral and Energy Board shall be without warranty of any kind, either express, implied or statutory including, but not limited to, title or the implied warranties of merchantability and fitness for a particular purpose.



An error or omission in the nominating party's Tract description may require that a State mineral lease or geophysical agreement be modified, canceled or abrogated due to the existence of conflicting leases, operating agreements, private claims or other future obligations or conditions within the Tract described. In such case, however, the Louisiana State Mineral and Energy Board shall not be obligated to refund any consideration paid by the Lessee prior to such modification, cancellation or abrogation including, but not limited to, bonuses, rentals and royalties.

NOTE: The State of Louisiana does hereby reserve, and this lease shall be subject to, the imprescriptible right of surface use in the nature of a servitude in favor of the Department of Natural Resources, including its Offices and Commissions, for the sole purpose of implementing, constructing, servicing and maintaining approved coastal zone management and/or restoration projects. Utilization of any and all rights derived under this lease by the mineral lessee, its agents, successors or assigns, shall not interfere with nor hinder the reasonable surface use by the Department of Natural Resources, its Offices or Commissions, as herein above reserved.

Applicant: MARK A. O'NEAL AND ASSOCIATES, INC.

Bidder	Cash Payment	Price/Acre	Rental	Oil	Gas	Other

Legend

-  17040004
-  Blocks
-  Active_Leases

N

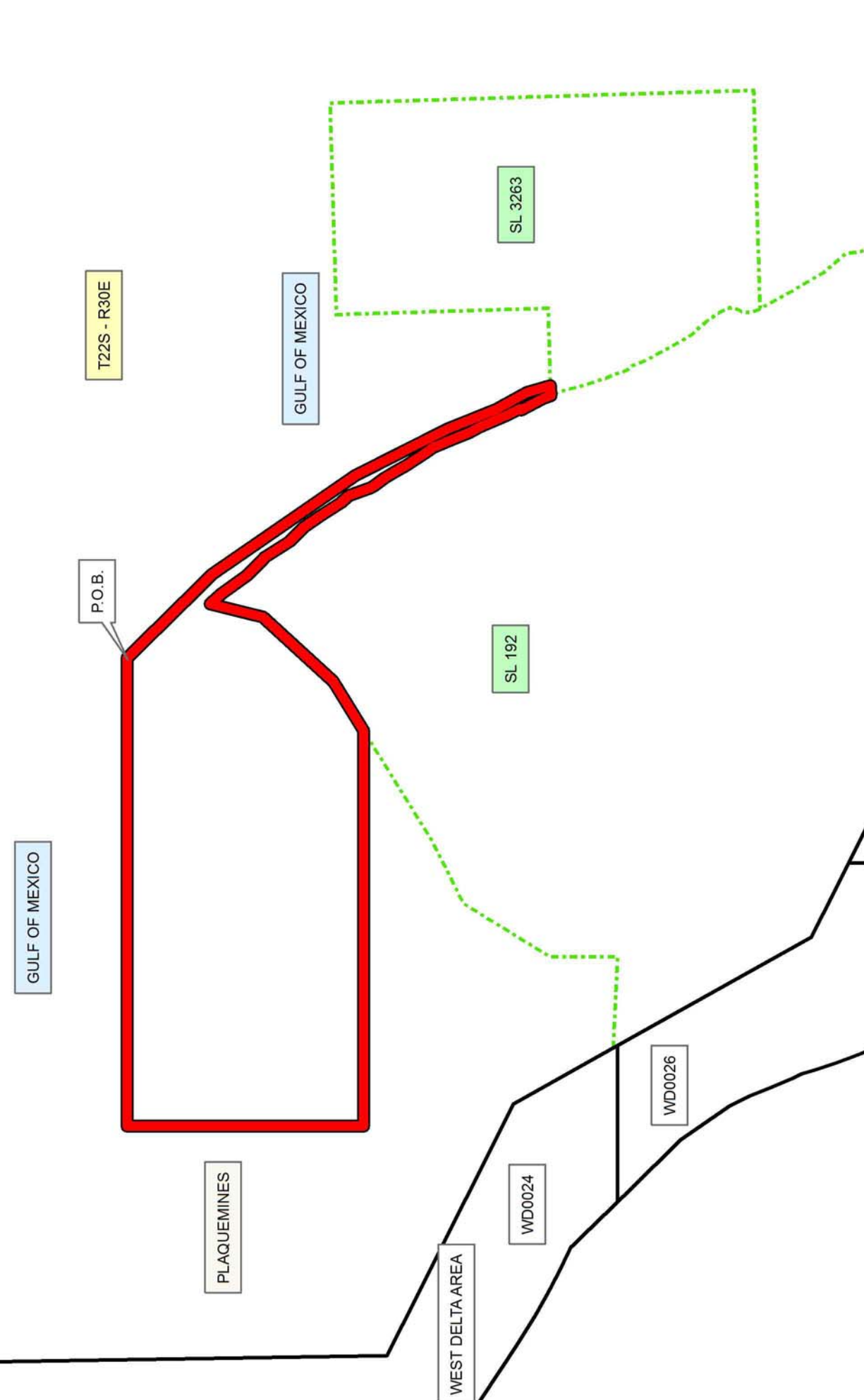

0 2,500 Feet

TRACT 44700 - Portion of Blocks 24, 25, and 26, West Delta Area, Plaquemines Parish, Louisiana

The beds and bottoms of all water bodies belonging to the State of Louisiana located in Blocks 24, 25, and 26, West Delta Area, together with any present lands formed by accretion to the shoreline or islands formed therein, located in Plaquemines Parish, Louisiana, owned by and not presently under mineral lease as of April 12, 2017, from the State of Louisiana, the geographical area of which is more fully described as follows: Beginning at a point on the Northwest boundary of State Lease No. 192, as amended, having Coordinates of X = 2,594,418.44 and Y = 192,687.97; thence along the boundary of said State Lease No. 192, as amended, the following: South 58 degrees 15 minutes 10 seconds West 3,255.54 feet to a point having Coordinates of X = 2,591,650.00 and Y = 190,975.00, South 63 degrees 26 minutes 06 seconds West 1,732.95 feet to a point having Coordinates of X = 2,590,100.00 and Y = 190,200.00, South 31 degrees 31 minutes 10 seconds West 2,522.11 feet to a point having Coordinates of X = 2,588,781.47 and Y = 188,050.00, South 1,689.50 feet to a point having Coordinates of X = 2,588,781.47 and Y = 186,360.50, North 87 degrees 19 minutes 55 seconds West 2,281.89 feet to a point having Coordinates of X = 2,586,502.05 and Y = 186,466.72, South 29 degrees 15 minutes 11 seconds East 5,658.48 feet to a point having Coordinates of X = 2,589,267.16 and Y = 181,529.86, and South 63 degrees 27 minutes 30 seconds East 11,285.33 feet to a point having Coordinates of X = 2,599,363.12 and Y = 176,487.00; thence West 11,384.12 feet to a point on the Three Mile Line, as decreed by the Supreme Court of the United States, as determined by a Special Master appointed therein, in litigation styled *United States v. State of Louisiana et al No. 9 Original*, in 1975, having Coordinates of X = 2,587,979 and Y = 176,487; thence along said Three Mile Line the following courses: Northwesterly along an arc to the right having a radius of 18,240.60 feet and centered at X = 2,604,220 and Y = 184,790 to a point having Coordinates of X = 2,587,325 and Y = 177,913, Northwesterly along a straight line to a point having Coordinates of X = 2,586,460 and Y = 180,038, Northwesterly along an arc to the right having a radius of 18,240.60 feet and centered at X = 2,603,355 and Y = 186,915 to a point having Coordinates of X = 2,585,856 and Y = 181,767, Northwesterly along an arc to the right having a radius of 18,240.60 feet and centered at X = 2,602,425 and Y = 189,395 to a point having Coordinates of X = 2,585,513 and Y = 182,560, thence Northwesterly along a straight line to a point having Coordinates of X = 2,585,309 and Y = 183,065, thence Northwesterly along a straight line to a point having Coordinates of X = 2,585,048 and Y = 183,583, thence Northwesterly along a straight line to a point having Coordinates of X = 2,584,220 and Y = 184,785, thence Northwesterly along a straight line to a point having Coordinates of X = 2,581,909 and Y = 187,130, and Northwesterly along an arc to the right having a radius of 18,240.60 feet and centered at X = 2,594,900 and Y = 199,935 to a point having Coordinates of X = 2,581,526 and Y = 187,531; thence North 5,156.97 feet to a point having Coordinates of X = 2,581,526.00 and Y = 192,687.97; thence East 12,892.44 feet to the point of beginning, containing approximately **2,497.67 acres, LESS AND**

EXCEPT that portion thereof, if any, lying seaward of the line three nautical miles from the coast line of Louisiana, as said three mile line has been decreed by the Supreme Court of the United States, as determined by a Special Master appointed therein, in litigation styled **United States v. State of Louisiana et al No. 9 Original**, in 1975, all as more particularly outlined on a plat in the Office of Mineral Resources, Department of Natural Resources. All bearings, distances and coordinates are based on the Louisiana Coordinate System of 1927, (South Zone).

NOTE: The above description of the Tract nominated for the purpose of acquiring a mineral lease or a geophysical agreement has been provided and corrected, where required, exclusively by the nominating party. Any mineral lease or geophysical agreement selected from this Tract and awarded by the Louisiana State Mineral and Energy Board shall be without warranty of any kind, either express, implied or statutory including, but not limited to, title or the implied warranties of merchantability and fitness for a particular purpose.

An error or omission in the nominating party's Tract description may require that a State mineral lease or geophysical agreement be modified, canceled or abrogated due to the existence of conflicting leases, operating agreements, private claims or other future obligations or conditions within the Tract described. In such case, however, the Louisiana State Mineral and Energy Board shall not be obligated to refund any consideration paid by the Lessee prior to such modification, cancellation or abrogation including, but not limited to, bonuses, rentals and royalties.

NOTE: The State of Louisiana does hereby reserve, and this lease shall be subject to, the imprescriptible right of surface use in the nature of a servitude in favor of the Department of Natural Resources, including its Offices and Commissions, for the sole purpose of implementing, constructing, servicing and maintaining approved coastal zone management and/or restoration projects. Utilization of any and all rights derived under this lease by the mineral lessee, its agents, successors or assigns, shall not interfere with nor hinder the reasonable surface use by the Department of Natural Resources, its Offices or Commissions, as herein above reserved.

Applicant: MARK A. O'NEAL AND ASSOCIATES, INC.

Bidder	Cash Payment	Price/Acre	Rental	Oil	Gas	Other

Legend

- 17040003
- Active_Leases
- Blocks

