

TRACT 44539 - Pointe Coupee Parish, Louisiana

A certain Tract of land, excluding the beds and bottoms of all navigable waters, belonging to and not presently under mineral lease from Town Of Livonia on April 13, 2016, being more fully described as follows: Those certain tracts or parcels of land situated in Section 119, Township 6 South, Range 9 East, covering 4.534 acres in Pointe Coupee Parish, Louisiana more particularly described as follows:

Tract 1: A certain tract or parcel of land located in Section 119, Township 6 South, Range 9 East, containing approximately 0.93 acres, more or less. Said tract is described as having a front of approximately 330' on Bayou Grosse Tete, and is bounded now or formerly as follows: West by Bayou Grosse Tete; North by Stuart W. Wooddy; East by property of Livonia High School and John A. Pinsonat, et al; and South by John A. Pinsonat, et al. A portion of said lot is described in Cash Sale from Pointe Coupee Parish School Board to Village of Livonia, dated July 31, 1962, under Entry No. 238; and in Cash Sale from Stuart W. Wooddy to Village of Livonia, dated December 15, 1975, in CB 129, under Entry No. 36. Said lot is also shown as "Tract II" and "Village of Livonia" on a plat of survey by Daryl B. Patin, C.E., dated March 16, 1971, which is recorded with an act of sale by Catherine Love Hurst LeBlanc, et al, to Stuart W. Wooddy, dated March 26, 1971, filed at CB 97, Entry No. 133 of the official records of Pointe Coupee Parish, Louisiana.

Tract 2: A certain tract or parcel of land located in Section 119, Township 6 South, Range 9 East, containing approximately 1.472 acres, more or less, and being known and designated as Lot J-12-A of Richfield Subdivision on a plat of survey by Charles R. St. Romain, dated January 26, 1989, designated as a "Map Showing Survey of Resubdivision of Lot J-12 and Water Well Site into Lots J-12-A and J-12-B", a copy of said survey plat being filed at CB 335, Entry No. 85 and at Map Book 5, Map No. 143 of the official records of Pointe Coupee Parish, Louisiana. Being the same property acquired from Charles Gordon Chauvin by Cash Sale dated October 28, 2008, duly recorded under Entry No. 005 of Book 548 of the conveyance records of Pointe Coupee Parish, Louisiana.

Tract 3: A certain tract or parcel of land containing approximately 0.882 acres, more or less, situated in Section 119, Township 6 South, Range 9 East, Pointe Coupee Parish, Louisiana. Said tract is a portion of Newfield Avenue, being 60' (sixty feet) in width, beginning at a point being 1,536' from Louisiana Highway No. 78, and in an Easterly direction for approximately 640' (six hundred forty feet) to the intersection of Newfield Avenue and Richfield Drive per the "Composite Map of Showing Survey of Lots 55, 56, 60 & 65 thru 68 (Richfield Subdivision Phase II)" created by Joseph Garrett, R.L.S., dated May 1986 and recorded in Map Book 5, Entry Number 41 of the Clerk of Courts Office in Pointe Coupee Parish, Louisiana.

Tract 4: A certain tract or parcel of land containing approximately 0.5 acres, more or less, situated in Section 119, Township 6 South, Range 9 East, Pointe Coupee Parish, Louisiana. Said tract is all of Berthier Street, being 60' (sixty feet) in width and approximately 365' (three hundred sixty-five feet) in length, to the intersection of David Street.

Tract 5: A certain tract or parcel of land containing approximately 0.75 acres, more or less, situated in Section 119, Township 6 South, Range 9 East, Pointe Coupee Parish, Louisiana. Said tract is all of Bouquet Street, being 60' (sixty feet) in width and approximately 548' (five hundred forty-eight feet) in length, to the intersection of David Street.

Tracts 1-5 comprising approximately **4.534 acres**, more or less, all as more particularly outlined on a plat on file in the Office of Mineral Resources, Department of Natural Resources. The description is based on information provided by the State Agency regarding location and ownership of surface and mineral rights. All bearings, distances and coordinates, if applicable, are based on Louisiana Coordinate System of 1927, (North or South Zone).

NOTE: The above description of the Tract nominated for the purpose of acquiring a mineral lease or a geophysical agreement has been provided and corrected, where required, exclusively by the nominating party. Any mineral lease or geophysical agreement selected from this Tract and awarded by the Louisiana State Mineral and Energy Board shall be without warranty of any kind, either express, implied or statutory including, but not limited to, title or the implied warranties of merchantability and fitness for a particular purpose.

An error or omission in the nominating party's Tract description may require that a State mineral lease or geophysical agreement be modified, canceled or abrogated due to the existence of conflicting leases, operating agreements, private claims or other future obligations or conditions within the Tract described. In such case, however, the Louisiana State Mineral and Energy Board shall not be obligated to refund any consideration paid by the Lessee prior to such modification, cancellation or abrogation including, but not limited to, bonuses, rentals and royalties.

Applicant: CYPRESS ENERGY CORPORATION to Agency and by Resolution from the Town Of Livonia authorizing the Mineral Board to act in its behalf

Bidder	Cash Payment	Price/Acre	Rental	Oil	Gas	Other

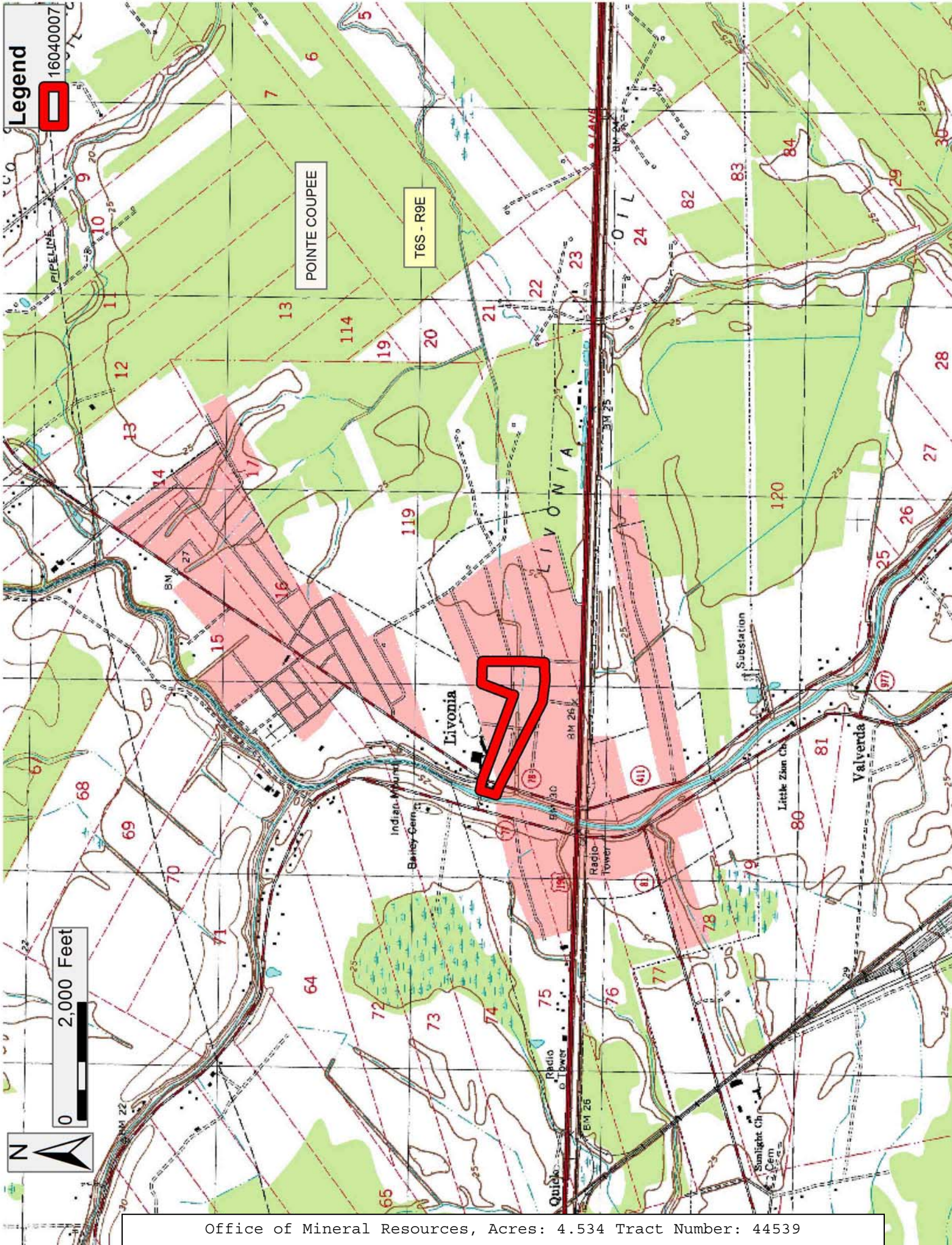

Legend
16040007

POINTE COUPEE

T6S - R9E

2,000 Feet



Office of Mineral Resources, Acres: 4.534 Tract Number: 44539