

TRACT 40882 - Portion of Blocks 18, and 22, East Cameron Area, Revised, Cameron Parish, Louisiana

The beds and bottoms of all water bodies belonging to the State of Louisiana located in Blocks 18, and 22, East Cameron Area, Revised, together with any present lands formed by accretion to the shoreline or islands formed therein, located in Cameron Parish, Louisiana, owned by and not presently under mineral lease as of April 8, 2009, from the State of Louisiana, the geographical area of which is more fully described as follows: Beginning at a point in Block 18, East Cameron Area, having Coordinates of X = 1,561,421.38 and Y = 331,341.05; thence North approximately 11,275 feet to a point of intersection with the South boundary of the Rockefeller Wildlife Refuge having a Coordinate of X = 1,561,421.38; thence Southeasterly along the southern boundary of said Refuge to a point of intersection with a North South line having a Coordinate of X = 1,568,548.29, also being a point on the east line of said Block 18; thence South approximately 10,925 feet to a point on the East line of Block 22, East Cameron having Coordinates of X = 1,568,548.29 and Y = 329,370.49; thence North 74 degrees 32 minutes 39 seconds West 7,394.32 feet to the Point of Beginning, containing approximately **1,813 acres**, all as more particularly outlined on a plat on file in the Office of Mineral Resources, Department of Natural Resources. All bearings, distances and coordinates are based on Louisiana Coordinate System of 1927, (North or South Zone).

NOTE: The above description of the Tract nominated for lease has been provided and corrected, where required, exclusively by the nomination party. Any mineral lease selected from this Tract and awarded by the Louisiana State Mineral Board shall be without warranty of any kind, either express, implied, or statutory, including, but not limited to, the implied warranties of merchantability and fitness for a particular purpose. Should the mineral lease awarded by the Louisiana State Mineral Board be subsequently modified, cancelled or abrogated due to the existence of conflicting leases, operating agreements, private claims or other future obligations or conditions which may affect all or any portion of the leased Tract, it shall not relieve the Lessee of the obligation to pay any bonus due thereon to the Louisiana State Mineral Board, nor shall the Louisiana State Mineral Board be obligated to refund any consideration paid by the Lessor prior to such modification, cancellation, or abrogation, including, but not limited to, bonuses, rentals and royalties.

NOTE: The State of Louisiana does hereby reserve, and this lease shall be subject to, the imprescriptible right of surface use in the nature of a servitude in favor of the Department of Natural Resources, including its Offices and Commissions, for the sole purpose of implementing, constructing, servicing and maintaining approved coastal zone management and/or restoration projects. Utilization of any and all rights derived under this lease by the mineral lessee, its agents, successors or assigns, shall not interfere with nor hinder the reasonable surface use by the Department of Natural Resources, its Offices or Commissions, as herein above reserved.

Applicant: CYPRESS ENERGY CORPORATION

Bidder	Cash Payment	Price/ Acre	Rental	Oil	Gas	Other

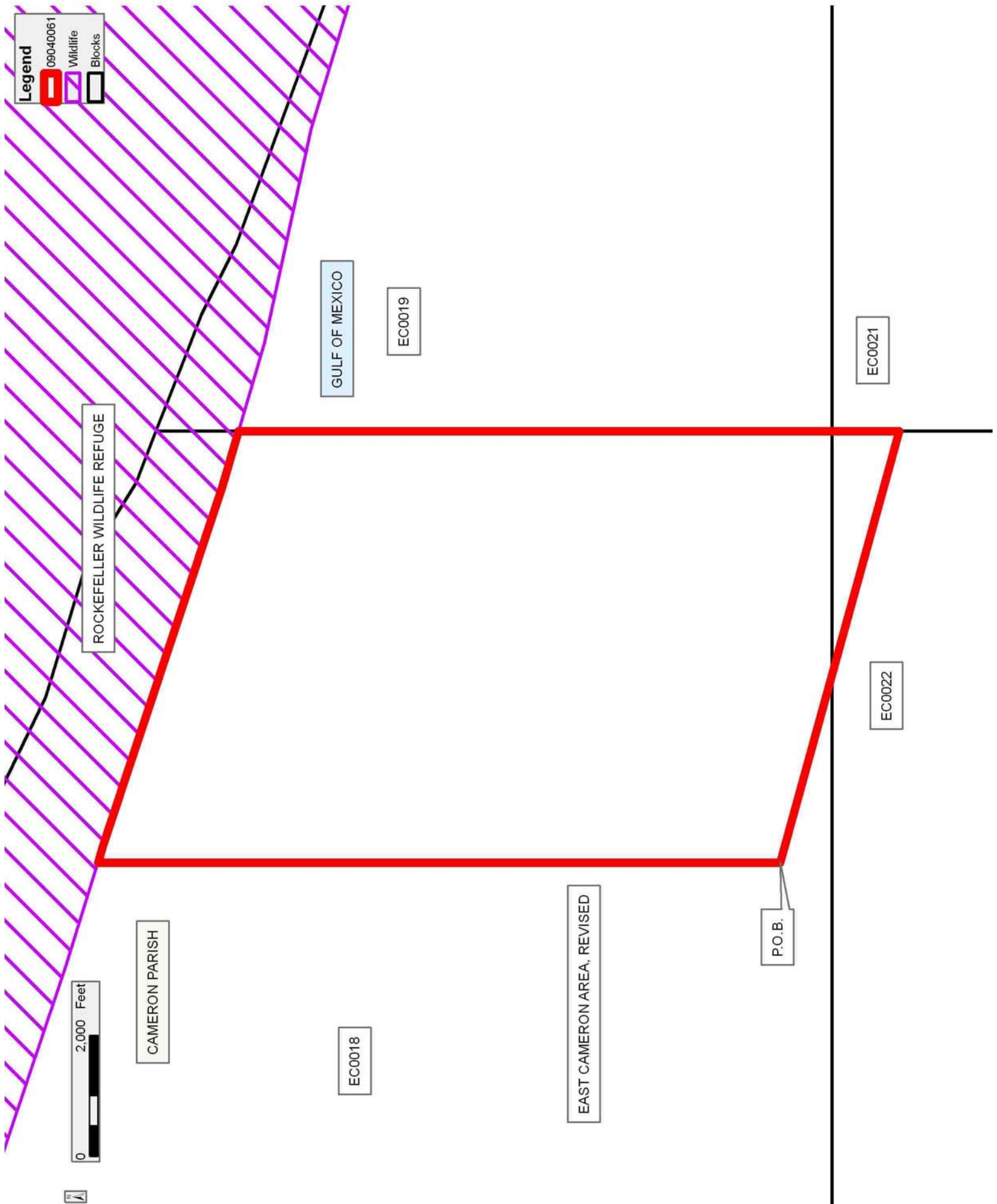

TRACT 40883 - Portion of Blocks 19, and 21, East Cameron Area, Revised, Cameron Parish, Louisiana

The beds and bottoms of all water bodies belonging to the State of Louisiana located in Blocks 19, and 21, East Cameron Area, Revised, together with any present lands formed by accretion to the shoreline or islands formed therein, located in Cameron Parish, Louisiana, owned by and not presently under mineral lease as of April 8, 2009, from the State of Louisiana, the geographical area of which is more fully described as follows: Beginning at a point on the West line of Block 21, East Cameron Area, having Coordinates of X = 1,568,548.29 and Y = 329,370.49; thence North approximately 10,925 feet along the West line of said Block 21 and West line of Block 19, East Cameron Area to a point of intersection with the South boundary of the Rockefeller Wildlife Refuge having a Coordinate of X = 1,568,548.29; thence Southeasterly along the southern boundary of said Refuge to a point of intersection with a North South line having a Coordinate of X = 1,575,919.66; thence South approximately 11,048 feet to a point in said Block 21 having Coordinates of X = 1,575,919.66 and Y = 327,332.34; thence North 74 degrees 32 minutes 39 seconds West 7,647.95 feet to the Point of Beginning, containing approximately **1,863 acres**, all as more particularly outlined on a plat on file in the Office of Mineral Resources, Department of Natural Resources. All bearings, distances and coordinates are based on Louisiana Coordinate System of 1927, (North or South Zone).

NOTE: The above description of the Tract nominated for lease has been provided and corrected, where required, exclusively by the nomination party. Any mineral lease selected from this Tract and awarded by the Louisiana State Mineral Board shall be without warranty of any kind, either express, implied, or statutory, including, but not limited to, the implied warranties of merchantability and fitness for a particular purpose. Should the mineral lease awarded by the Louisiana State Mineral Board be subsequently modified, cancelled or abrogated due to the existence of conflicting leases, operating agreements, private claims or other future obligations or conditions which may affect all or any portion of the leased Tract, it shall not relieve the Lessee of the obligation to pay any bonus due thereon to the Louisiana State Mineral Board, nor shall the Louisiana State Mineral Board be obligated to refund any consideration paid by the Lessor prior to such modification, cancellation, or abrogation, including, but not limited to, bonuses, rentals and royalties.

NOTE: The State of Louisiana does hereby reserve, and this lease shall be subject to, the imprescriptible right of surface use in the nature of a servitude in favor of the Department of Natural Resources, including its Offices and Commissions, for the sole purpose of implementing, constructing, servicing and maintaining approved coastal zone management and/or restoration projects. Utilization of any and all rights derived under this lease by the mineral lessee, its agents, successors or assigns, shall not interfere with nor hinder the reasonable surface use by the

Department of Natural Resources, its Offices or Commissions, as herein above reserved.

Applicant: CYPRESS ENERGY CORPORATION

Bidder	Cash Payment	Price/ Acre	Rental	Oil	Gas	Other

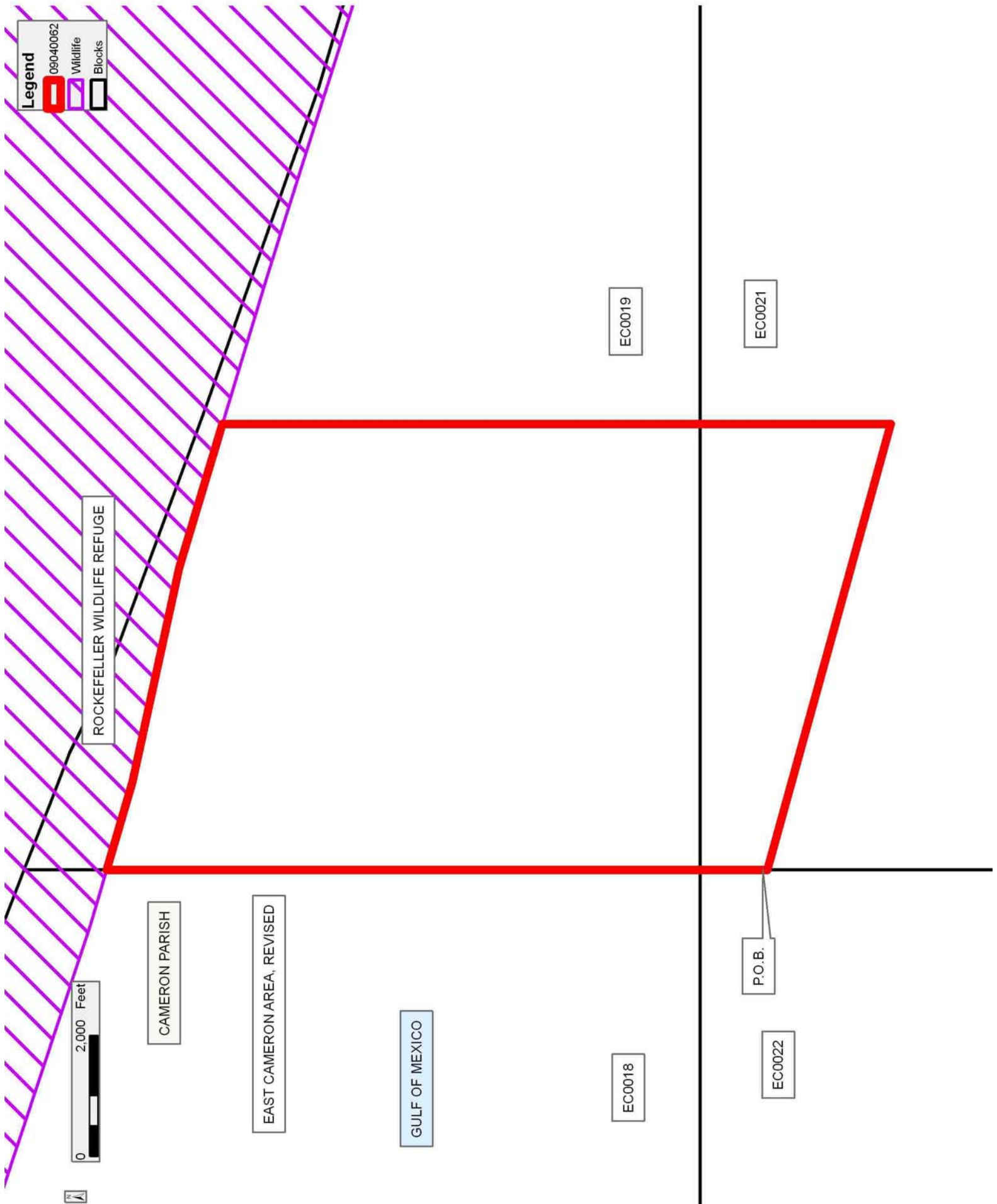

Legend

09040062

Wildlife

Blocks

ROCKEFELLER WILDLIFE REFUGE

CAMERON PARISH

EAST CAMERON AREA, REVISED

GULF OF MEXICO

EC0019

EC0021

P.O.B.

EC0022

EC0018

TRACT 40884 - Portion of Blocks 19, and 21, East Cameron Area, Revised, Cameron Parish, Louisiana

The beds and bottoms of all water bodies belonging to the State of Louisiana located in Blocks 19, and 21, East Cameron Area, Revised, together with any present lands formed by accretion to the shoreline or islands formed therein, located in Cameron Parish, Louisiana, owned by and not presently under mineral lease as of April 8, 2009, from the State of Louisiana, the geographical area of which is more fully described as follows: Beginning at a point in Block 21, East Cameron Area, having Coordinates of X = 1,575,919.66 and Y = 327,332.34; thence North approximately 11,048 feet to a point of intersection with the South boundary of the Rockefeller Wildlife Refuge having a Coordinate of X = 1,575,919.66; thence Southeasterly along the southern boundary of said Refuge to a point of intersection with a North South line having a Coordinate of X = 1,583,306.34, also being a point on the east line of Block 19, East Cameron Area; thence South approximately 10,786 feet along the east line of said Block 19 to a point on the East line of said Block 21 having Coordinates of X = 1,583,306.34 and Y = 325,289.96; thence North 74 degrees 32 minutes 39 seconds West 7,663.83 feet to the Point of Beginning, containing approximately **1,854 acres**, all as more particularly outlined on a plat on file in the Office of Mineral Resources, Department of Natural Resources. All bearings, distances and coordinates are based on Louisiana Coordinate System of 1927, (North or South Zone).

NOTE: The above description of the Tract nominated for lease has been provided and corrected, where required, exclusively by the nomination party. Any mineral lease selected from this Tract and awarded by the Louisiana State Mineral Board shall be without warranty of any kind, either express, implied, or statutory, including, but not limited to, the implied warranties of merchantability and fitness for a particular purpose. Should the mineral lease awarded by the Louisiana State Mineral Board be subsequently modified, cancelled or abrogated due to the existence of conflicting leases, operating agreements, private claims or other future obligations or conditions which may affect all or any portion of the leased Tract, it shall not relieve the Lessee of the obligation to pay any bonus due thereon to the Louisiana State Mineral Board, nor shall the Louisiana State Mineral Board be obligated to refund any consideration paid by the Lessor prior to such modification, cancellation, or abrogation, including, but not limited to, bonuses, rentals and royalties.

NOTE: The State of Louisiana does hereby reserve, and this lease shall be subject to, the imprescriptible right of surface use in the nature of a servitude in favor of the Department of Natural Resources, including its Offices and Commissions, for the sole purpose of implementing, constructing, servicing and maintaining approved coastal zone management and/or restoration projects. Utilization of any and all rights derived under this lease by the mineral lessee, its agents, successors or assigns, shall not interfere with nor hinder the reasonable surface use by the

Department of Natural Resources, its Offices or Commissions, as herein above reserved.

Applicant: CYPRESS ENERGY CORPORATION

Bidder	Cash Payment	Price/ Acre	Rental	Oil	Gas	Other

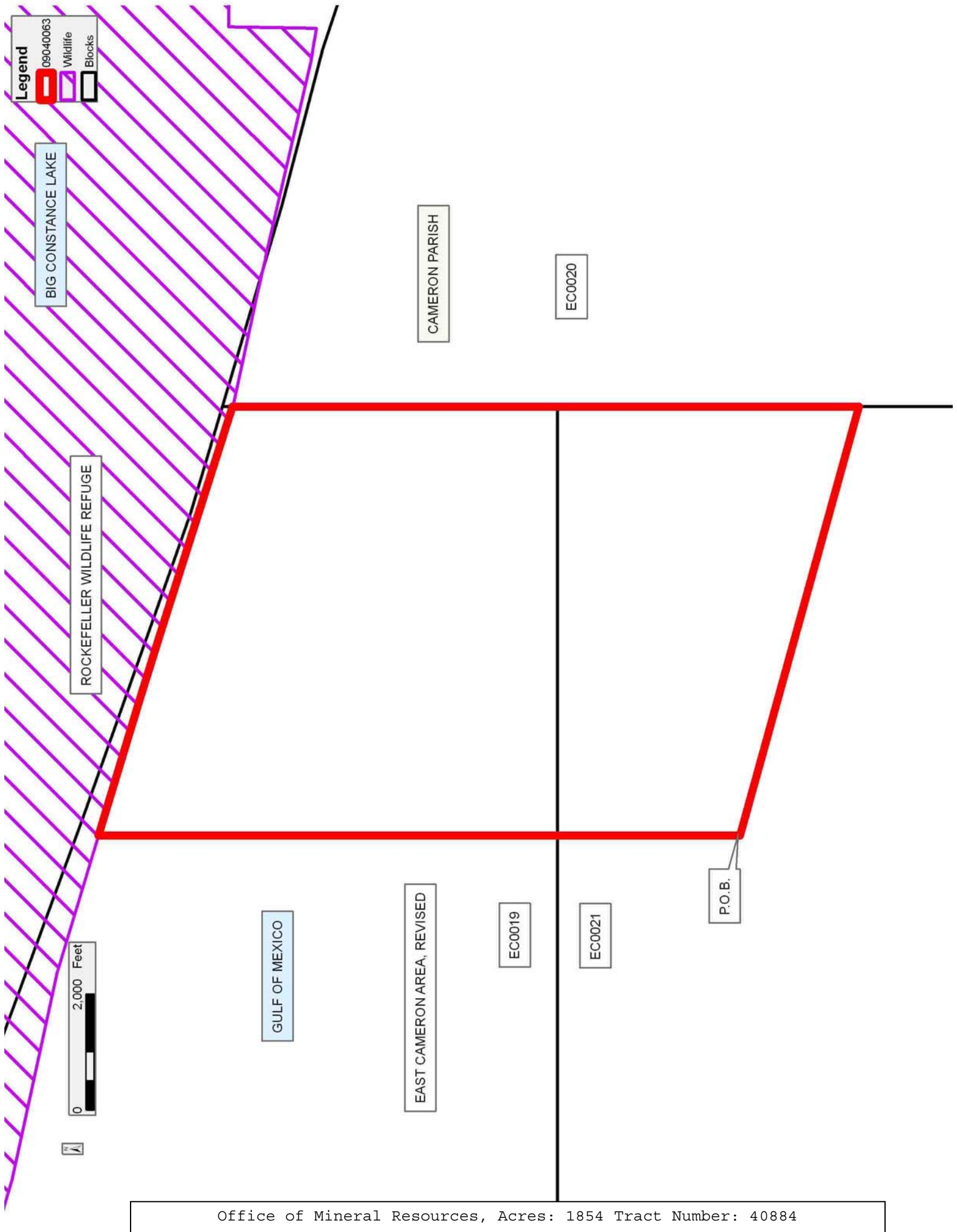

TRACT 40885 - Portion of Block 20, East Cameron Area, Revised, Cameron Parish, Louisiana

The beds and bottoms of all water bodies belonging to the State of Louisiana located in Block 20, East Cameron Area, Revised, together with any present lands formed by accretion to the shoreline or islands formed therein, located in Cameron Parish, Louisiana, owned by and not presently under mineral lease as of April 8, 2009, from the State of Louisiana, the geographical area of which is more fully described as follows: Beginning at a point on the West line of Block 20, East Cameron Area, having Coordinates of X = 1,583,306.34 and Y = 325,289.96; thence North approximately 10,786 feet to a point of intersection with the South boundary of the Rockefeller Wildlife Refuge having a Coordinate of X = 1,583,306.34; thence Southeasterly along the southern boundary of said Refuge to a point of intersection with the Louisiana Coastline, as decreed by the Supreme Court of the United States, as determined by a Special Master appointed therein, in litigation styled *United States v. State of Louisiana et al No. 9 Original*, in 1975, having Coordinates of X = 1,585,660.93 and Y = 335,551.73; thence along a straight line to a point having Coordinates of X = 1,586,780.00 and Y = 335,220.00; thence along a straight line to a point having Coordinates of X = 1,589,460.00 and Y = 334,525.00; thence along a straight line to a point of intersection with the South boundary of the Rockefeller Wildlife Refuge; thence Southerly and Easterly to a point of intersection with the East line of said Block 20; thence South 00 degrees 38 minutes 34 seconds West approximately 8,524 feet to a point having Coordinates of X = 1,591,201.95 and Y = 323,106.86; thence North 74 degrees 32 minutes 39 seconds West 8,191.86 to the Point of Beginning, containing approximately **1,984 acres**, all as more particularly outlined on a plat on file in the Office of Mineral Resources, Department of Natural Resources. All bearings, distances and coordinates are based on Louisiana Coordinate System of 1927, (North or South Zone).

NOTE: The above description of the Tract nominated for lease has been provided and corrected, where required, exclusively by the nomination party. Any mineral lease selected from this Tract and awarded by the Louisiana State Mineral Board shall be without warranty of any kind, either express, implied, or statutory, including, but not limited to, the implied warranties of merchantability and fitness for a particular purpose. Should the mineral lease awarded by the Louisiana State Mineral Board be subsequently modified, cancelled or abrogated due to the existence of conflicting leases, operating agreements, private claims or other future obligations or conditions which may affect all or any portion of the leased Tract, it shall not relieve the Lessee of the obligation to pay any bonus due thereon to the Louisiana State Mineral Board, nor shall the Louisiana State Mineral Board be obligated to refund any consideration paid by the Lessor prior to such modification, cancellation, or abrogation, including, but not limited to, bonuses, rentals and royalties.

NOTE: The State of Louisiana does hereby reserve, and this lease shall be subject to, the imprescriptible right of surface use in the nature of a servitude in favor of the Department of Natural Resources, including its Offices and Commissions, for the sole purpose of implementing, constructing, servicing and maintaining approved coastal zone management and/or restoration projects. Utilization of any and all rights derived under this lease by the mineral lessee, its agents, successors or assigns, shall not interfere with nor hinder the reasonable surface use by the Department of Natural Resources, its Offices or Commissions, as herein above reserved.

Applicant: CYPRESS ENERGY CORPORATION

Bidder	Cash Payment	Price/ Acre	Rental	Oil	Gas	Other

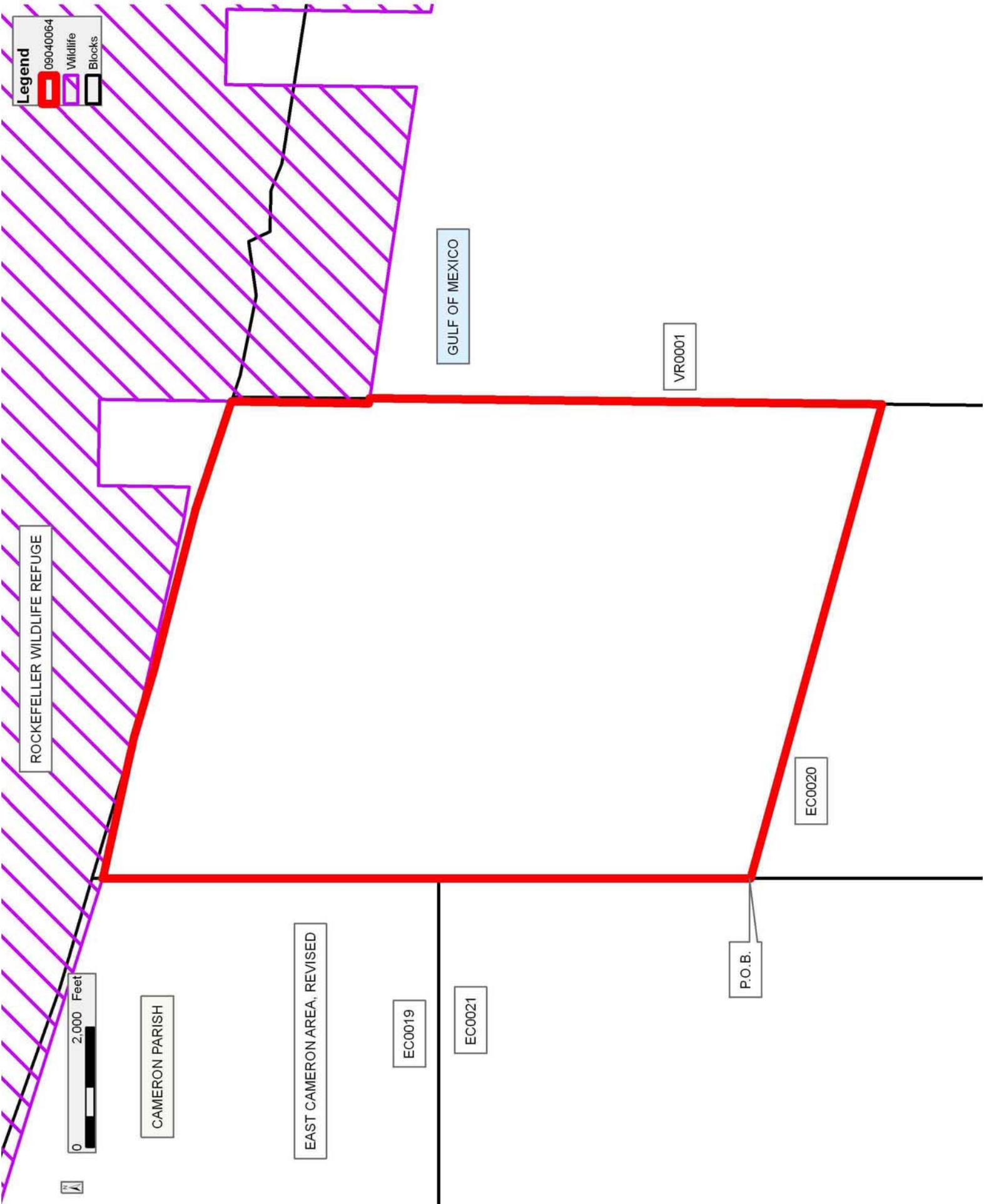

TRACT 40886 - Portion of Block 1, Vermilion Area, Revised, Cameron and Vermilion Parishes, Louisiana

The beds and bottoms of all water bodies belonging to the State of Louisiana located in Block 1, Vermilion Area, Revised, together with any present lands formed by accretion to the shoreline or islands formed therein, located in Cameron and Vermilion Parishes, Louisiana, owned by and not presently under mineral lease as of April 8, 2009, from the State of Louisiana, the geographical area of which is more fully described as follows: Beginning at a point on the West line of Block 1, Vermilion Area, having Coordinates of X = 1,591,201.95 and Y = 323,106.86; thence Northerly approximately 8,524 feet along the west line of said Block 1 to a point of intersection with the South boundary of the Rockefeller Wildlife Refuge; thence Southeasterly and Northerly along the southern boundary of said Refuge to a point of intersection with the Louisiana Coastline, as decreed by the Supreme Court of the United States, as determined by a Special Master appointed therein, in litigation styled *United States v. State of Louisiana et al No. 9 Original*, in 1975; thence Southeasterly along said coastline approximately 1,265 feet to a point of intersection with the South boundary of the Rockefeller Wildlife Refuge; thence Southerly and Southeasterly along said Refuge to a North South line having a Coordinate of X = 1,603,108.03, also being a point on the east line of said Block 1; thence South approximately 8,729 feet along the east line of said Block 1 to a point having Coordinates of X = 1,603,108.03 and Y = 320,834.59; thence North 79 degrees 11 minutes 42 seconds West 12,120.97 feet to the Point of Beginning, containing approximately **2,430 acres**, all as more particularly outlined on a plat on file in the Office of Mineral Resources, Department of Natural Resources. All bearings, distances and coordinates are based on Louisiana Coordinate System of 1927, (North or South Zone).

NOTE: The above description of the Tract nominated for lease has been provided and corrected, where required, exclusively by the nomination party. Any mineral lease selected from this Tract and awarded by the Louisiana State Mineral Board shall be without warranty of any kind, either express, implied, or statutory, including, but not limited to, the implied warranties of merchantability and fitness for a particular purpose. Should the mineral lease awarded by the Louisiana State Mineral Board be subsequently modified, cancelled or abrogated due to the existence of conflicting leases, operating agreements, private claims or other future obligations or conditions which may affect all or any portion of the leased Tract, it shall not relieve the Lessee of the obligation to pay any bonus due thereon to the Louisiana State Mineral Board, nor shall the Louisiana State Mineral Board be obligated to refund any consideration paid by the Lessor prior to such modification, cancellation, or abrogation, including, but not limited to, bonuses, rentals and royalties.

NOTE: The State of Louisiana does hereby reserve, and this lease shall be subject to, the imprescriptible right of surface use in the nature of a servitude in favor of the Department of Natural Resources, including its

Offices and Commissions, for the sole purpose of implementing, constructing, servicing and maintaining approved coastal zone management and/or restoration projects. Utilization of any and all rights derived under this lease by the mineral lessee, its agents, successors or assigns, shall not interfere with nor hinder the reasonable surface use by the Department of Natural Resources, its Offices or Commissions, as herein above reserved.

Applicant: CYPRESS ENERGY CORPORATION

Bidder	Cash Payment	Price/ Acre	Rental	Oil	Gas	Other

Legend

- 09040065
- Wildlife
- Blocks
- Counties

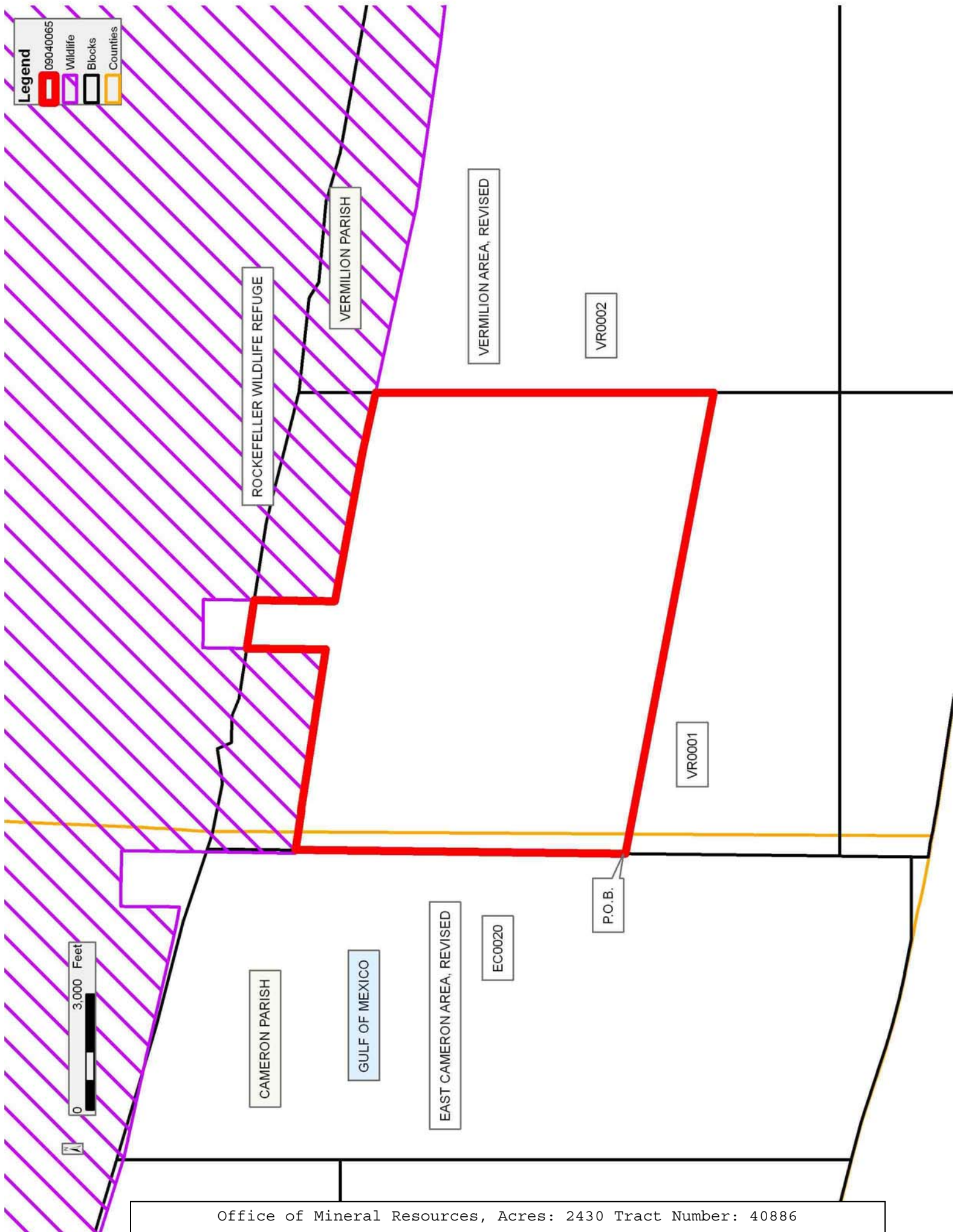

TRACT 40887 - Portion of Block 2, Vermilion Area, Revised, Vermilion Parish, Louisiana

The beds and bottoms of all water bodies belonging to the State of Louisiana located in Block 2, Vermilion Area, Revised, together with any present lands formed by accretion to the shoreline or islands formed therein, located in Vermilion Parish, Louisiana, owned by and not presently under mineral lease as of April 8, 2009, from the State of Louisiana, the geographical area of which is more fully described as follows: Beginning at a point on the West line of Block 2, Vermilion Area, having Coordinates of X = 1,603,108.03 and Y = 320,834.59; thence North approximately 8,729 feet along the west line of said Block 2 to a point of intersection with the South boundary of the Rockefeller Wildlife Refuge having a Coordinate of X = 1,603,108.03; thence Southeasterly along said Refuge to a North South line having a Coordinate of X = 1,615,651.44; thence South approximately 8,021 feet to a point having Coordinates of X = 1,615,651.44 and Y = 319,452.69; thence North 83 degrees 42 minutes 47 seconds West 12,619.30 feet to the Point of Beginning, containing approximately **2,370 acres**, all as more particularly outlined on a plat on file in the Office of Mineral Resources, Department of Natural Resources. All bearings, distances and coordinates are based on Louisiana Coordinate System of 1927, (North or South Zone).

NOTE: The above description of the Tract nominated for lease has been provided and corrected, where required, exclusively by the nomination party. Any mineral lease selected from this Tract and awarded by the Louisiana State Mineral Board shall be without warranty of any kind, either express, implied, or statutory, including, but not limited to, the implied warranties of merchantability and fitness for a particular purpose. Should the mineral lease awarded by the Louisiana State Mineral Board be subsequently modified, cancelled or abrogated due to the existence of conflicting leases, operating agreements, private claims or other future obligations or conditions which may affect all or any portion of the leased Tract, it shall not relieve the Lessee of the obligation to pay any bonus due thereon to the Louisiana State Mineral Board, nor shall the Louisiana State Mineral Board be obligated to refund any consideration paid by the Lessor prior to such modification, cancellation, or abrogation, including, but not limited to, bonuses, rentals and royalties.

NOTE: The State of Louisiana does hereby reserve, and this lease shall be subject to, the imprescriptible right of surface use in the nature of a servitude in favor of the Department of Natural Resources, including its Offices and Commissions, for the sole purpose of implementing, constructing, servicing and maintaining approved coastal zone management and/or restoration projects. Utilization of any and all rights derived under this lease by the mineral lessee, its agents, successors or assigns, shall not interfere with nor hinder the reasonable surface use by the Department of Natural Resources, its Offices or Commissions, as herein above reserved.

Applicant: CYPRESS ENERGY CORPORATION

Bidder	Cash Payment	Price/ Acre	Rental	Oil	Gas	Other

Legend

09040066

Wildlife

Blocks

ROCKEFELLER WILDLIFE REFUGE

VERMILION PARISH

GULF OF MEXICO

VERMILION AREA, REVISED

P.O.B.

VR0003

VR0002

VR0018

VR0019

VR0001

VR0020



TRACT 40888 - Portion of Blocks 2, and 3, Vermilion Area, Revised, Vermilion Parish, Louisiana

The beds and bottoms of all water bodies belonging to the State of Louisiana located in Blocks 2, and 3, Vermilion Area, Revised, together with any present lands formed by accretion to the shoreline or islands formed therein, located in Vermilion Parish, Louisiana, owned by and not presently under mineral lease as of April 8, 2009, from the State of Louisiana, the geographical area of which is more fully described as follows: Beginning at a point in Block 2, Vermilion Area, having Coordinates of X = 1,615,651.44 and Y = 319,452.69; thence North approximately 8,021 feet to a point of intersection with the South boundary of the Rockefeller Wildlife Refuge having a Coordinate of X = 1,615,651.44; thence Southeasterly along said Rockefeller Wildlife Refuge to its Southeast corner; thence Southerly approximately 8,116 feet to a point having Coordinates of X = 1,628,463.49 and Y = 318,041.19; thence North 83 degrees 42 minutes 47 seconds West 12,889.57 feet to the Point of Beginning, containing approximately **2,340 acres**, all as more particularly outlined on a plat on file in the Office of Mineral Resources, Department of Natural Resources. All bearings, distances and coordinates are based on Louisiana Coordinate System of 1927, (North or South Zone).

NOTE: The above description of the Tract nominated for lease has been provided and corrected, where required, exclusively by the nomination party. Any mineral lease selected from this Tract and awarded by the Louisiana State Mineral Board shall be without warranty of any kind, either express, implied, or statutory, including, but not limited to, the implied warranties of merchantability and fitness for a particular purpose. Should the mineral lease awarded by the Louisiana State Mineral Board be subsequently modified, cancelled or abrogated due to the existence of conflicting leases, operating agreements, private claims or other future obligations or conditions which may affect all or any portion of the leased Tract, it shall not relieve the Lessee of the obligation to pay any bonus due thereon to the Louisiana State Mineral Board, nor shall the Louisiana State Mineral Board be obligated to refund any consideration paid by the Lessor prior to such modification, cancellation, or abrogation, including, but not limited to, bonuses, rentals and royalties.

NOTE: The State of Louisiana does hereby reserve, and this lease shall be subject to, the imprescriptible right of surface use in the nature of a servitude in favor of the Department of Natural Resources, including its Offices and Commissions, for the sole purpose of implementing, constructing, servicing and maintaining approved coastal zone management and/or restoration projects. Utilization of any and all rights derived under this lease by the mineral lessee, its agents, successors or assigns, shall not interfere with nor hinder the reasonable surface use by the Department of Natural Resources, its Offices or Commissions, as herein above reserved.

Applicant: CYPRESS ENERGY CORPORATION

Bidder	Cash Payment	Price/ Acre	Rental	Oil	Gas	Other

Legend

09040067

Wildlife

Blocks

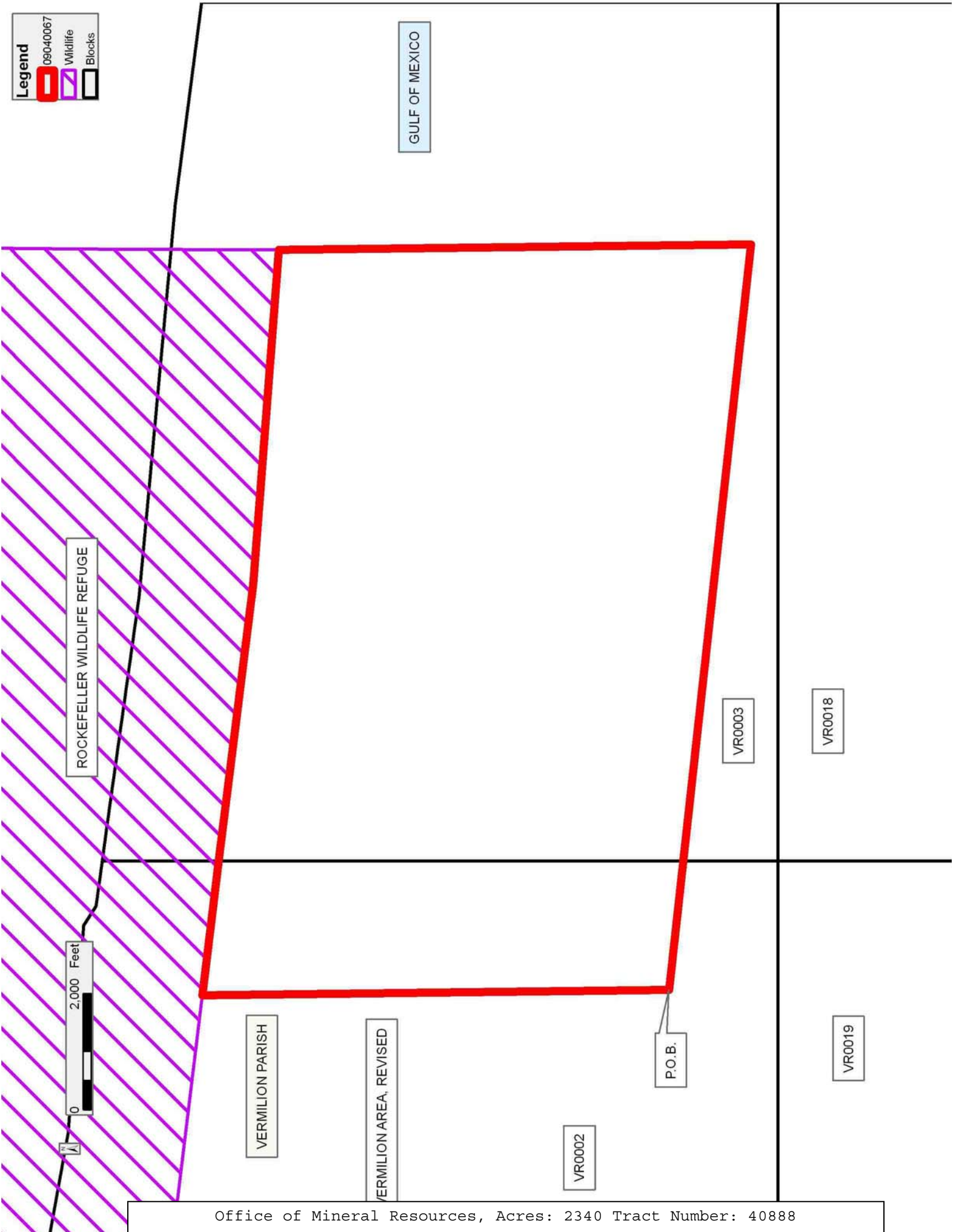

TRACT 40889 - Portion of Blocks 17, 18, 3, and 4, Vermilion Area, Revised, Vermilion Parish, Louisiana

The beds and bottoms of all water bodies belonging to the State of Louisiana located in Blocks 17, 18, 3, and 4, Vermilion Area, Revised, together with any present lands formed by accretion to the shoreline or islands formed therein, located in Vermilion Parish, Louisiana, owned by and not presently under mineral lease as of April 8, 2009, from the State of Louisiana, the geographical area of which is more fully described as follows: Beginning at a point in Block 3, Vermilion Area, having Coordinates of X = 1,628,463.49 and Y = 318,041.19; thence Northerly approximately 8,116 feet on a straight line to the Southeast corner of the Rockefeller Wildlife Refuge; thence South Easterly approximately 13,318 feet on a straight line to a point having Coordinates of X = 1,641,564.20 and Y = 324,315.28, being a point in Block 4, Vermilion Area; thence South 7,807.12 feet to a point having Coordinates of X = 1,641,564.20 and Y = 316,508.15, being a point in Block 17, Vermilion Area; thence North 83 degrees 19 minutes 32 seconds West 13,190.10 feet to the Point of Beginning, containing approximately **2,401 acres**, all as more particularly outlined on a plat on file in the Office of Mineral Resources, Department of Natural Resources. All bearings, distances and coordinates are based on Louisiana Coordinate System of 1927, (North or South Zone).

NOTE: The above description of the Tract nominated for lease has been provided and corrected, where required, exclusively by the nomination party. Any mineral lease selected from this Tract and awarded by the Louisiana State Mineral Board shall be without warranty of any kind, either express, implied, or statutory, including, but not limited to, the implied warranties of merchantability and fitness for a particular purpose. Should the mineral lease awarded by the Louisiana State Mineral Board be subsequently modified, cancelled or abrogated due to the existence of conflicting leases, operating agreements, private claims or other future obligations or conditions which may affect all or any portion of the leased Tract, it shall not relieve the Lessee of the obligation to pay any bonus due thereon to the Louisiana State Mineral Board, nor shall the Louisiana State Mineral Board be obligated to refund any consideration paid by the Lessor prior to such modification, cancellation, or abrogation, including, but not limited to, bonuses, rentals and royalties.

NOTE: The State of Louisiana does hereby reserve, and this lease shall be subject to, the imprescriptible right of surface use in the nature of a servitude in favor of the Department of Natural Resources, including its Offices and Commissions, for the sole purpose of implementing, constructing, servicing and maintaining approved coastal zone management and/or restoration projects. Utilization of any and all rights derived under this lease by the mineral lessee, its agents, successors or assigns, shall not interfere with nor hinder the reasonable surface use by the Department of Natural Resources, its Offices or Commissions, as herein above reserved.

Applicant: CYPRESS ENERGY CORPORATION

Bidder	Cash Payment	Price/ Acre	Rental	Oil	Gas	Other

Legend

09040071

Wildlife

Blocks

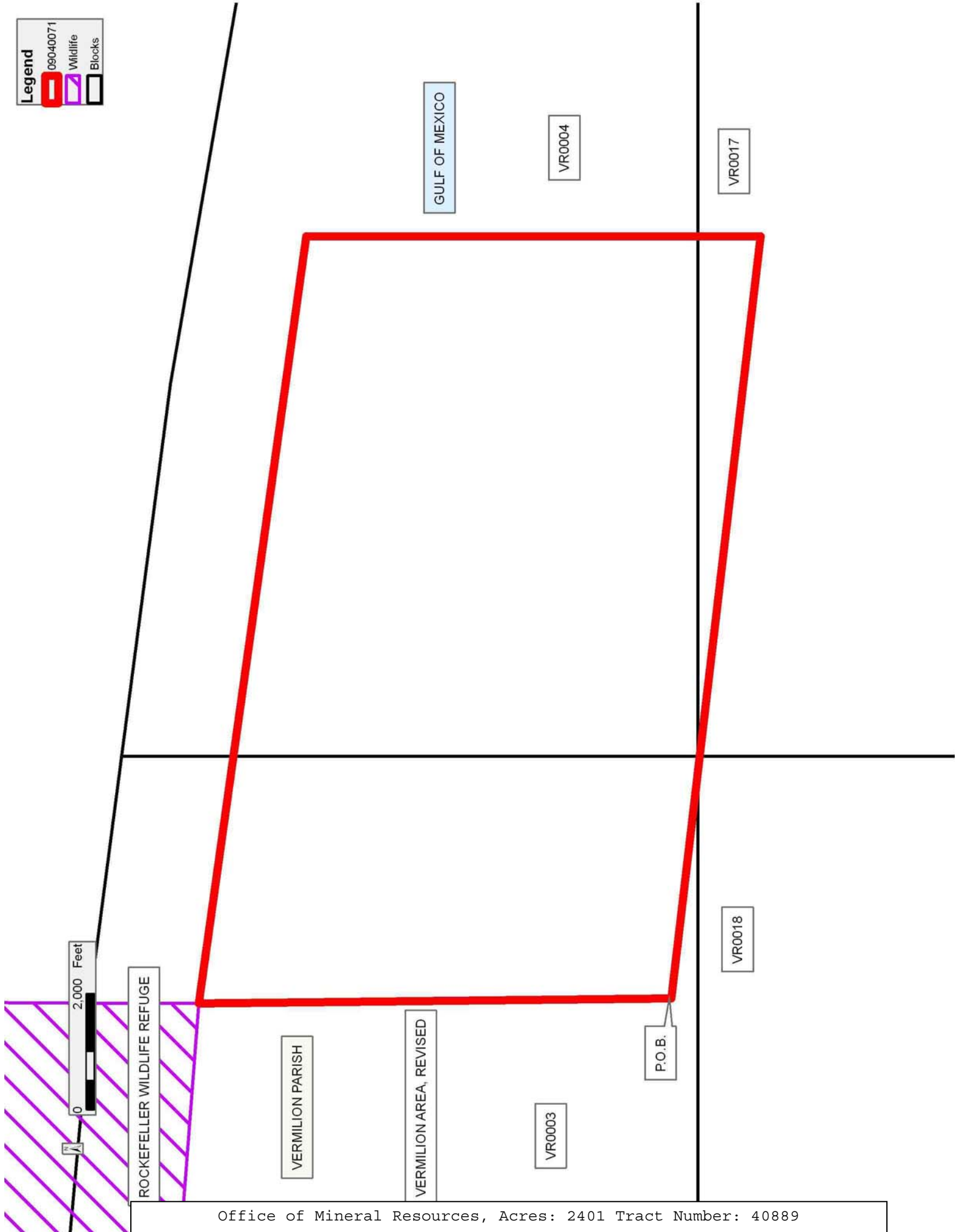

TRACT 40890 - Portion of Blocks 1, and 20, Vermilion Area, Revised, Cameron and Vermilion Parishes, Louisiana

The beds and bottoms of all water bodies belonging to the State of Louisiana located in Blocks 1, and 20, Vermilion Area, Revised, together with any present lands formed by accretion to the shoreline or islands formed therein, located in Cameron and Vermilion Parishes, Louisiana, owned by and not presently under mineral lease as of April 8, 2009, from the State of Louisiana, the geographical area of which is more fully described as follows: Beginning at a point on the West line of Block 1, Vermilion Area, having Coordinates of X = 1,591,201.95 and Y = 323,106.86; thence South 79 degrees 11 minutes 42 seconds East 12,120.97 feet to a point on the East line of said Block 1 having Coordinates of X = 1,603,108.03 and Y = 320,834.59; thence South 7,820.52 feet along the East line of said Block 1 to a point of intersection with the Three Mile Line, as decreed by the Supreme Court of the United States, as determined by a Special Master appointed therein, in litigation styled *United States v. State of Louisiana et al No. 9 Original*, in 1975, having Coordinates of X = 1,603,108.03 and Y = 313,014.08, also being a point on the East line of Block 20, Vermilion Area; thence along an arc having a radius of 18,240.60 feet and a center at X = 1,605,965 and Y = 331,030 to a point having Coordinates of X = 1,601,325 and Y = 313,389; thence on a straight line to a point having Coordinates of X = 1,601,195 and Y = 313,403; thence along an arc having a radius of 18,240.60 feet and a center at X = 1,603,140 and Y = 331,540 to a point having Coordinates of X = 1,598,672 and Y = 313,855; thence on a straight line to a point having Coordinates of X = 1,596,370 and Y = 314,437; thence on a straight line to a point having Coordinates of X = 1,596,179 and Y = 314,483; thence on a straight line to a point having Coordinates of X = 1,592,424 and Y = 315,063; thence along an arc having a radius of 18,240.60 feet and a center at X = 1,595,210 and Y = 333,090 to a point having Coordinates of X = 1,591,479 and Y = 315,235; thence along an arc having a radius of 18,240.60 feet and a center at X = 1,594,075 and Y = 333,290 to a point having Coordinates of X = 1,591,114.25 and Y = 315,291.17, also being a point on the West line of said Block 20; thence North 00 degrees 38 minutes 34 seconds East 7,816.18 feet along the West line of said Block 20 to the Point of Beginning, containing approximately **2135.68 acres, LESS AND EXCEPT** that portion thereof, if any, lying seaward of the line three nautical miles from the coast line of Louisiana, as said three mile line has been decreed by the Supreme Court of the United States, as determined by a Special Master appointed therein, in litigation styled **United States v. State of Louisiana et al No. 9 Original**, in 1975, all as more particularly outlined on a plat in the Office of Mineral Resources, Department of Natural Resources. All bearings, distances and coordinates are based on the Louisiana Coordinate System of 1927, (South Zone).

NOTE: The above description of the Tract nominated for lease has been provided and corrected, where required, exclusively by the nomination party. Any mineral lease selected from this Tract and awarded by the Louisiana State Mineral Board shall be without warranty of any kind,

either express, implied, or statutory, including, but not limited to, the implied warranties of merchantability and fitness for a particular purpose. Should the mineral lease awarded by the Louisiana State Mineral Board be subsequently modified, cancelled or abrogated due to the existence of conflicting leases, operating agreements, private claims or other future obligations or conditions which may affect all or any portion of the leased Tract, it shall not relieve the Lessee of the obligation to pay any bonus due thereon to the Louisiana State Mineral Board, nor shall the Louisiana State Mineral Board be obligated to refund any consideration paid by the Lessor prior to such modification, cancellation, or abrogation, including, but not limited to, bonuses, rentals and royalties.

NOTE: The State of Louisiana does hereby reserve, and this lease shall be subject to, the imprescriptible right of surface use in the nature of a servitude in favor of the Department of Natural Resources, including its Offices and Commissions, for the sole purpose of implementing, constructing, servicing and maintaining approved coastal zone management and/or restoration projects. Utilization of any and all rights derived under this lease by the mineral lessee, its agents, successors or assigns, shall not interfere with nor hinder the reasonable surface use by the Department of Natural Resources, its Offices or Commissions, as herein above reserved.

Applicant: CYPRESS ENERGY CORPORATION

Bidder	Cash Payment	Price/ Acre	Rental	Oil	Gas	Other

Legend

09040070

Blocks

Counties

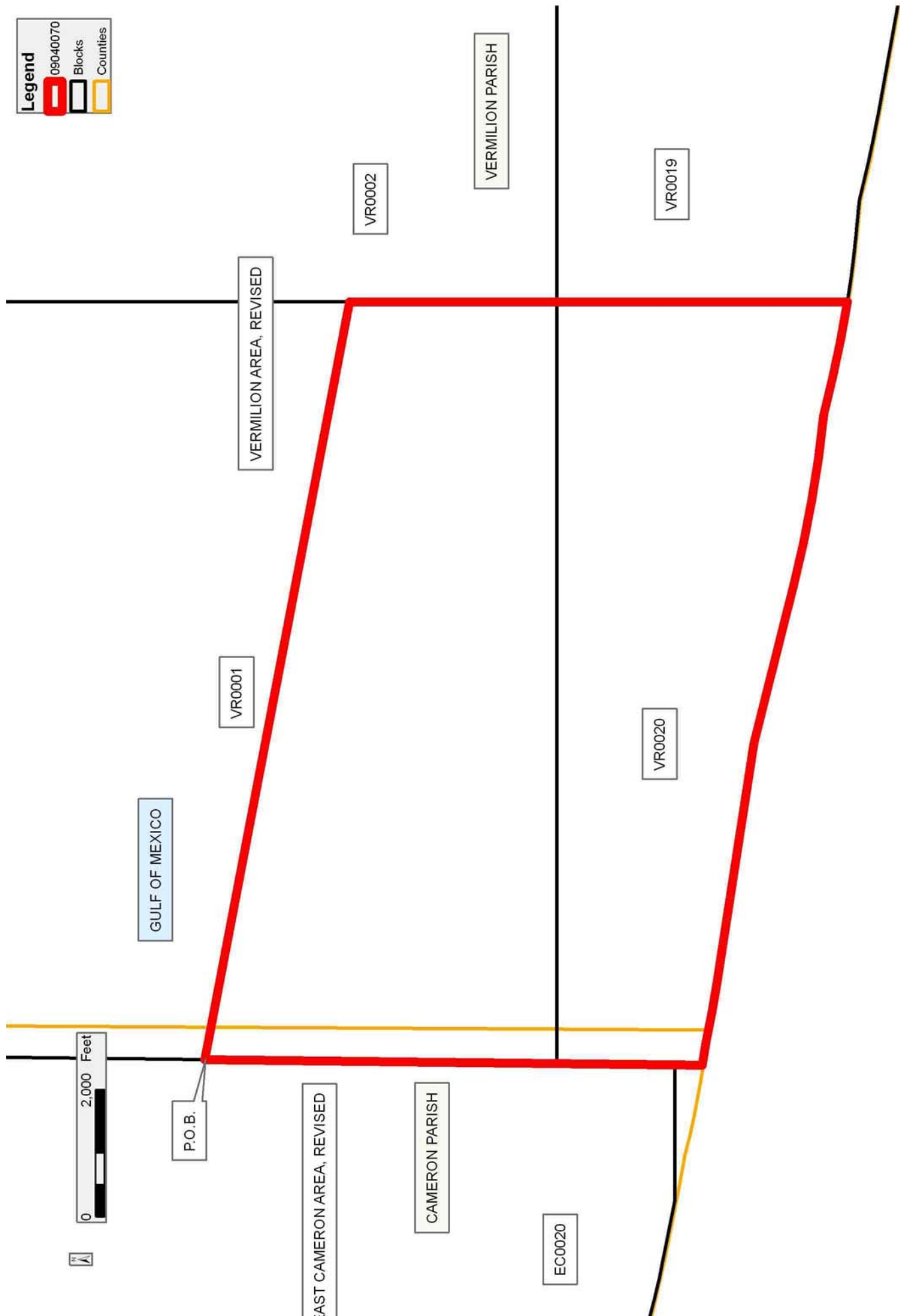

TRACT 40891 - Portion of Blocks 19, and 2, Vermilion Area, Revised, Vermilion Parish, Louisiana

The beds and bottoms of all water bodies belonging to the State of Louisiana located in Blocks 19, and 2, Vermilion Area, Revised, together with any present lands formed by accretion to the shoreline or islands formed therein, located in Vermilion Parish, Louisiana, owned by and not presently under mineral lease as of April 8, 2009, from the State of Louisiana, the geographical area of which is more fully described as follows: Beginning at a point on the West line of Block 2, Vermilion Area, having Coordinates of X = 1,603,108.03 and Y = 320,834.59; thence South 83 degrees 42 minutes 47 seconds East 12,619.30 feet to a point having Coordinates of X = 1,615,651.44 and Y = 319,452.69; thence South 00 degrees 37 minutes 54 seconds East 8,382.97 feet to a point of intersection with the Three Mile Line, as decreed by the Supreme Court of the United States, as determined by a Special Master appointed therein, in litigation styled *United States v. State of Louisiana et al No. 9 Original*, in 1975, having Coordinates of X = 1,615,743.85 and Y = 311,070.23, also being a point in Block 19, Vermilion Area; thence on a straight line to a point having Coordinates of X = 1,614,565 and Y = 311,235; thence along an arc having a radius of 18,240.60 feet and a center at X = 1,617,090 and Y = 329,300 to a point having Coordinates of X = 1,613,148 and Y = 311,491; thence on a straight line to a point having Coordinates of X = 1,611,814 and Y = 311,591; thence along an arc having a radius of 18,240.60 feet and a center at X = 1,613,190 and Y = 329,780 to a point having Coordinates of X = 1,609,960 and Y = 311,828; thence on a straight line to a point having Coordinates of X = 1,606,070 and Y = 312,528; thence along an arc having a radius of 18,240.60 feet and a center at X = 1,609,300 and Y = 330,480 to a point having Coordinates of X = 1,604,702 and Y = 312,829; thence on a straight line to a point having Coordinates of X = 1,604,290 and Y = 312,866; thence along an arc having a radius of 18,240.60 feet and a center at X = 1,605,965 and Y = 331,030 to a point having Coordinates of X = 1,603,108.03 and Y = 313,014.08, also being a point on the West line of said Block 19; thence North 7,820.52 feet along the West line of said Block 19 to the Point of Beginning, containing approximately **2352.75 acres, LESS AND EXCEPT** that portion thereof, if any, lying seaward of the line three nautical miles from the coast line of Louisiana, as said three mile line has been decreed by the Supreme Court of the United States, as determined by a Special Master appointed therein, in litigation styled **United States v. State of Louisiana et al No. 9 Original**, in 1975, all as more particularly outlined on a plat in the Office of Mineral Resources, Department of Natural Resources. All bearings, distances and coordinates are based on the Louisiana Coordinate System of 1927, (South Zone).

NOTE: The above description of the Tract nominated for lease has been provided and corrected, where required, exclusively by the nomination party. Any mineral lease selected from this Tract and awarded by the Louisiana State Mineral Board shall be without warranty of any kind, either express, implied, or statutory, including, but not limited to, the

implied warranties of merchantability and fitness for a particular purpose. Should the mineral lease awarded by the Louisiana State Mineral Board be subsequently modified, cancelled or abrogated due to the existence of conflicting leases, operating agreements, private claims or other future obligations or conditions which may affect all or any portion of the leased Tract, it shall not relieve the Lessee of the obligation to pay any bonus due thereon to the Louisiana State Mineral Board, nor shall the Louisiana State Mineral Board be obligated to refund any consideration paid by the Lessor prior to such modification, cancellation, or abrogation, including, but not limited to, bonuses, rentals and royalties.

NOTE: The State of Louisiana does hereby reserve, and this lease shall be subject to, the imprescriptible right of surface use in the nature of a servitude in favor of the Department of Natural Resources, including its Offices and Commissions, for the sole purpose of implementing, constructing, servicing and maintaining approved coastal zone management and/or restoration projects. Utilization of any and all rights derived under this lease by the mineral lessee, its agents, successors or assigns, shall not interfere with nor hinder the reasonable surface use by the Department of Natural Resources, its Offices or Commissions, as herein above reserved.

Applicant: CYPRESS ENERGY CORPORATION

Bidder	Cash Payment	Price/ Acre	Rental	Oil	Gas	Other

Legend

09040069

Blocks

