

TRACT 33336 - PORTION OF BLOCK 6, GRAND ISLE AREA, Jefferson Parish, Louisiana

That portion of Block 6, Grand Isle Area, Jefferson Parish, Louisiana, belonging to the State of Louisiana and not under mineral lease on April 1, 2001, described as follows: Beginning at the Northeast corner of Block 6, Grand Isle Area, having Coordinates of X = 2,442,901.85 and Y = 215,051.47; thence South 14,758.04 feet on the East line of said Block 6 to its Southeast corner having Coordinates of X = 2,442,901.85 and Y = 200,293.43; thence West 7,379.02 feet on the South line of said Block 6 to a point having Coordinates of X = 2,435,522.83 and Y = 200,293.43; thence North 13,229.42 feet to a point having Coordinates of X = 2,435,522.83 and Y = 213,522.85; thence Northeasterly on a straight line to a point having Coordinates of X = 2,436,419 and Y = 214,125; thence Northeasterly on a straight line to a point on the North line of said Block 6 having Coordinates of X = 2,437,398.76 and Y = 215,051.47; thence East 5,503.09 feet on the North line of said Block 6 to the point of beginning, containing approximately 2,464.32 acres, as shown outlined in red on a plat on file in the Office of Mineral Resources, Department of Natural Resources, as provided by the applicant. All bearings, distances and coordinates are based on Louisiana Coordinate System of 1977 (South Zone).

NOTE: The boundary description and plat for this tract as shown and advertised were supplied by the nominating party and have not been checked for accuracy by the staff of the Office of Mineral Resources. Anything which may affect the acreage, the shape or the location of the tract, such as non-closure of or incorrect X, Y coordinates or title disputed acreage, or which may affect the status of the tract for leasing, such as overlap of prior leases or nominated tracts, or which may affect potential operations on leases taken, such as inclusion in areas under the jurisdiction of the Department of Wildlife and Fisheries, will not be specifically determined unless and until a bid on this tract is accepted by the Mineral Board; which bid will be accepted on a per acre basis and which acceptance will be conditional upon such specific determinations being made. Once a bid is conditionally accepted by the Mineral Board, the staff will, within a period following the date of the lease sale, determine the acreage, shape and location of the potential lease area of the tract, the status for leasing of all or any portion thereof, and any conditions which may affect potential operations thereon. These determinations may render all or a portion of the bid area unleaseable or may increase or decrease the State claimed acreage such that the total bonus/rental ultimately required may either exceed the bonus/rental paid at the lease sale, which will require additional payment by the successful bidder, or allow the successful bidder a refund of excessive payment. The successful bidder will be notified of the determinations by the staff and given an opportunity to view the bid area acreage, configuration and location as it has been specifically determined. If all or a portion of the bid area is unleaseable due to overlap of an existing lease, the successful bidder will be given an opportunity to accept or reject a new lease on that portion of the bid area which is not unleaseable. If rejected, the bid and all monies accompanying the bid will be returned to the successful bidder and no lease will be issued. In all other cases:

a new lease will be issued and any additional per acre bonus/rental, 10% administration fee or \$10 and \$5 per acre fees due as a result of staff determination of more State acreage in the bid area than determined by the successful bidder will be paid prior to the lease being issued. A determination of less State acreage in the bid area will result in a return to the successful bidder of any overpayment.

NOTE: The State of Louisiana does hereby reserve, and this lease shall be subject to, the imprescriptible right of surface use in the nature of a servitude in favor of the Department of Natural Resources, including its Offices and Commissions, for the sole purpose of implementing, constructing, servicing and maintaining approved coastal zone management and/or restoration projects. Utilization of any and all rights derived under this lease by the mineral lessee, its agents, successors or assigns, shall not interfere with or hinder the reasonable surface use by the Department of Natural Resources, its Offices or Commissions, as hereinabove reserved.

Applicant: South Padre Energy, Inc.

Bidder	Cash Payment	Price / Acre	Rental	Oil	Gas	Other

BIk. 4

BIk. 3

2.

P. O. B.
X= 2,442,901.85
Y= 215,051.47

BIk. 6

TR 33336
2,464.32 +/- ACS.
APRIL 2001

BIk. 7

GULF OF MEXICO

BIk. 11

BIk. 10

NAD 27 LAMBERT LA. SOUTH ZONE



Revised:

Grand Isle Area
Jefferson Parish, Louisiana

2000 0 2000



Scale in Feet

TRACT 33337 - PORTION OF BLOCK 6, GRAND ISLE AREA, Jefferson Parish, Louisiana

That portion of Block 6, Grand Isle Area, Jefferson Parish, Louisiana, belonging to the State of Louisiana and not under mineral lease on April 1, 2001, described as follows: Beginning at the Southwest corner of Block 6, Grand Isle Area, having Coordinates of X = 2,428,143.81 and Y = 200,293.43; thence North 8,208.79 feet on the West line of said Block 6 to its most Westerly Northwest corner having Coordinates of X = 2,428,143.81 and Y = 208,502.22; thence Northeasterly on a straight line to a point having Coordinates of X = 2,428,924 and Y = 208,999; thence Northeasterly on a straight line to a point having Coordinates of X = 2,430,176 and Y = 209,960; thence Northeasterly on a straight line to a point having Coordinates of X = 2,433,051 and Y = 211,862; thence Northeasterly on a straight line to a point having Coordinates of X = 2,435,522.83 and Y = 213,522.85; thence South 13,229.42 feet to a point on the South line of said Block 6 having Coordinates of X = 2,435,522.83 and Y = 200,293.43; thence West 7,379.02 feet on the South line of said Block 6 to the point of beginning, containing approximately **1,820.14 acres**, as shown outlined in red on a plat on file in the Office of Mineral Resources, Department of Natural Resources, as provided by the applicant. All bearings, distances and coordinates are based on the Louisiana Coordinate System of 1927 (South Zone).

NOTE: The boundary description and plat for this tract as shown and advertised were supplied by the nominating party and have not been checked for accuracy by the staff of the Office of Mineral Resources. Anything which may affect the acreage, the shape or the location of the tract, such as non-closure of or incorrect X, Y coordinates, title disputed acreage, or which may affect the status of the tract for leasing, such as overlap of prior leases or nominated tracts, which may affect potential operations on leases taken, such as inclusion in areas under the jurisdiction of the Department of Wildlife and Fisheries, will not be specifically determined unless and until a bid on this tract is accepted by the Mineral Board; which bid will be accepted on a per acre basis and which acceptance will be conditional upon such specific determinations being made. Once a bid is conditionally accepted by the Mineral Board, the staff will, within a period following the date of the lease sale, determine the acreage, shape and location of the potential lease area of the tract, the status for leasing of all or any portion thereof, and all conditions which may affect potential operations thereon. The determinations may render all or a portion of the bid area unleaseable or may increase or decrease the State claimed acreage such that the total bonus/rental ultimately required may either exceed the bonus/rental paid at the lease sale, which will require additional payment by the successful bidder, or allow the successful bidder a refund of excessive payment. The successful bidder will be notified of the determinations by the staff and given an opportunity to visit the bid area acreage, configuration and location as it has been specifically determined. If all or a portion of the bid area is unleaseable due to overlap of an existing lease, the successful bidder will be given an opportunity to accept or reject a new lease on that portion of the bid area which is not unleaseable. If rejected, the bid and all monies accompanying the bid will be returned to the

successful bidder and no lease will be issued. In all other cases a new lease will be issued and any additional per acre bonus/rental, 10% administration fee or \$10 and \$5 per acre fees due as a result of staff determination of more State acreage in the bid area than determined by the successful bidder will be paid prior to the lease being issued. A determination of less State acreage in the bid area will result in a return to the successful bidder of any overpayment.

NOTE: The State of Louisiana does hereby reserve, and this lease shall be subject to, the imprescriptible right of surface use in the nature of a servitude in favor of the Department of Natural Resources, including its Offices and Commissions, for the sole purpose of implementing, constructing, servicing and maintaining approved coastal zone management and/or restoration projects. Utilization of any and all rights derived under this lease by the mineral lessee, its agents, successors or assigns, shall not interfere with or hinder the reasonable surface use by the Department of Natural Resources, its Offices or Commissions, as hereinabove reserved.

Applicant: South Padre Energy, Inc.

Bidder	Cash Payment	Price / Acre	Rental	Oil	Gas	Other

GULF OF MEXICO

Bik. 6

Bik. 5

P. O. B.
X= 2,428,143.81
Y= 200,293.43

Bik. 12

TR 33337
1,820.14 +/- ACS.
APRIL, 2001

Bik. 11

Grand Isle Area
Jefferson Parish, Louisiana

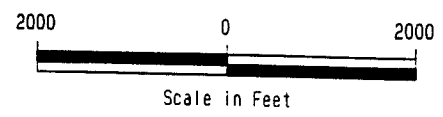

Scale in Feet



Revised:

TRACT 33338 - PORTION OF BLOCK 5, GRAND ISLE AREA, Jefferson Parish, Louisiana

That portion of Block 5, Grand Isle Area, Jefferson Parish, Louisiana, belonging to the State of Louisiana and not under mineral lease on April 1, 2001, described as follows: Beginning at the Southeast corner of Block 5, Grand Isle Area, having Coordinates of X = 2,428,143.81 and Y = 200,293.43; thence West 11,730.20 feet on the South line of said Block 5 to a point having Coordinates of X = 2,416,413.61 and Y = 200,293.43; thence Northeasterly on a straight line to a point having Coordinates of X = 2,416,442 and Y = 200,331; thence Northeasterly on a straight line to a point having Coordinates of X = 2,418,510 and Y = 202,105; thence Northeasterly on a straight line to a point having Coordinates of X = 2,423,068 and Y = 205,322; thence Northeasterly on a straight line to a point having Coordinates of X = 2,426,997 and Y = 207,772; thence Northeasterly on a straight line to the Northeast corner of said Block 5 having Coordinates of X = 2,428,143.81 and Y = 208,502.22; thence South 8,208.79 feet on said East line of said Block 5 to the point of beginning, containing approximately **1,172.32 acres**, as shown outlined in red on a plat on file in the Office of Mineral Resources, Department of Natural Resources, as provided by the applicant. All bearings, distances and coordinates are based on Louisiana Coordinate System of 1927 (South Zone).

NOTE: The boundary description and plat for this tract as shown and advertised were supplied by the nominating party and have not been checked for accuracy by the staff of the Office of Mineral Resources. Anything which may affect the acreage, the shape or the location of the tract, such as non-closure of or incorrect X, Y coordinates, title disputed acreage, or which may affect the status of the tract for leasing, such as overlap of prior leases or nominated tracts, which may affect potential operations on leases taken, such as inclusion in areas under the jurisdiction of the Department of Wildlife and Fisheries, will not be specifically determined unless and until a bid on this tract is accepted by the Mineral Board; which bid will be accepted on a per acre basis and which acceptance will be conditional upon such specific determinations being made. Once a bid is conditionally accepted by the Mineral Board, the staff will within a period following the date of the lease sale, determine the acreage, shape and location of the potential lease area of the tract, the status for leasing of all or any portion thereof, and the conditions which may affect potential operations thereon. The determinations may render all or a portion of the bid area unleaseable or may increase or decrease the State claimed acreage such that the total bonus/rental ultimately required may either exceed the bonus/rental paid at the lease sale, which will require additional payment by the successful bidder, or allow the successful bidder a refund of excessive payment. The successful bidder will be notified of the determinations by the staff and given an opportunity to visit the bid area acreage, configuration and location as it has been specifically determined. If all or a portion of the bid area is unleaseable due to overlap of an existing lease, the successful bidder will be given an opportunity to accept or reject a new lease on that portion of the bid area which is not unleaseable. If rejected, the bid and all monies accompanying the bid will be returned to the

successful bidder and no lease will be issued. In all other cases a new lease will be issued and any additional per acre bonus/rental, 10% administration fee or \$10 and \$5 per acre fees due as a result of staff determination of more State acreage in the bid area than determined by the successful bidder will be paid prior to the lease being issued. A determination of less State acreage in the bid area will result in a return to the successful bidder of any overpayment.

NOTE: The State of Louisiana does hereby reserve, and this lease shall be subject to, the imprescriptible right of surface use in the nature of a servitude in favor of the Department of Natural Resources, including its Offices and Commissions, for the sole purpose of implementing, constructing, servicing and maintaining approved coastal zone management and/or restoration projects. Utilization of any and all rights derived under this lease by the mineral lessee, its agents, successors or assigns, shall not interfere with or hinder the reasonable surface use by the Department of Natural Resources, its Offices or Commissions, as hereinabove reserved.

Applicant: South Padre Energy, Inc.

Bidder	Cash Payment	Price / Acre	Rental	Oil	Gas	Other

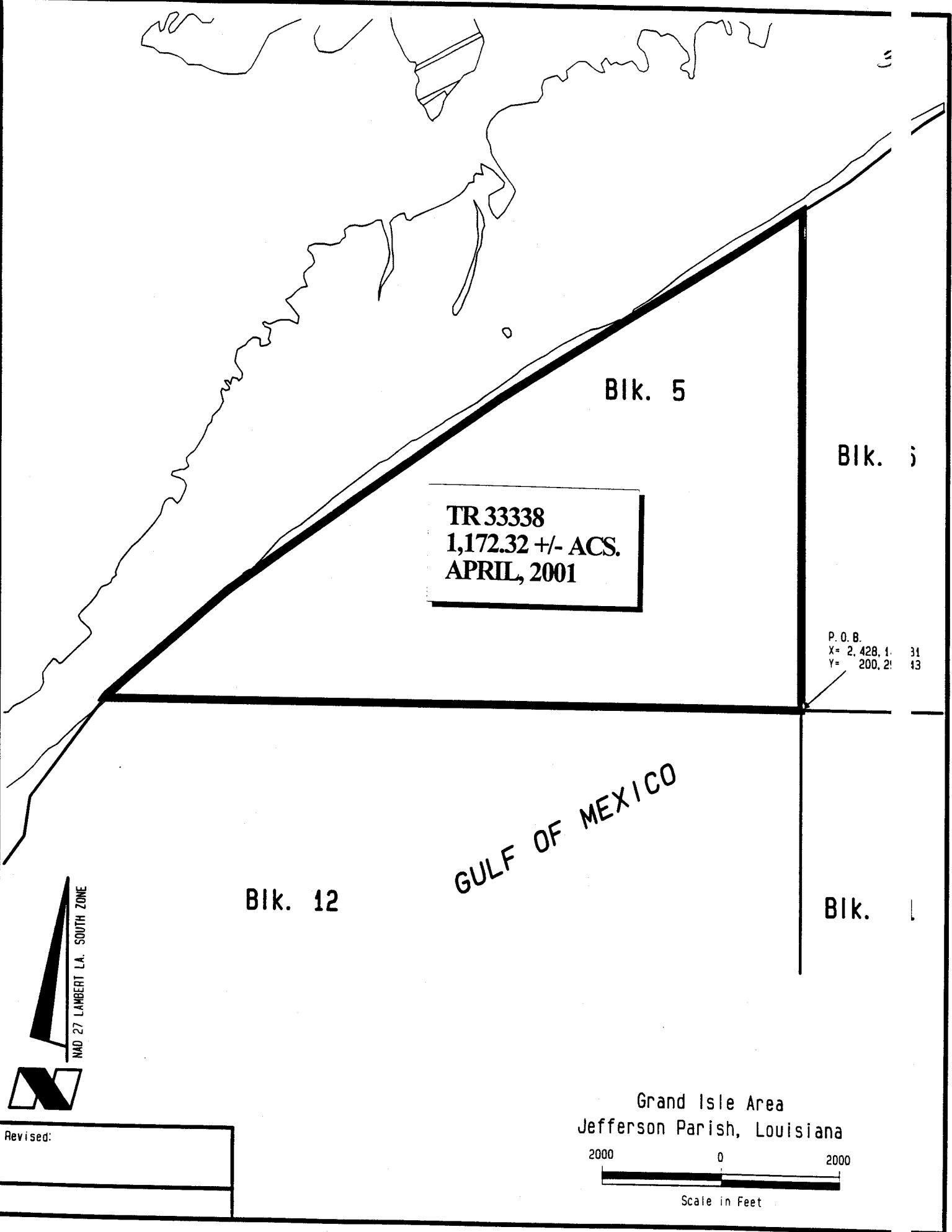

Bik. 5

Bik. 1

TR 33338
1,172.32 +/- ACS.
APRIL, 2001

P. O. B.
X= 2,428.1 31
Y= 200.2 13

GULF OF MEXICO

Bik. 12

Bik. 1



Grand Isle Area
Jefferson Parish, Louisiana

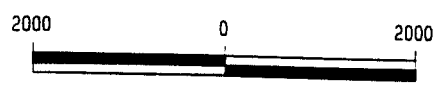

Scale in Feet

Revised:

TRACT 33339 - PORTION OF BLOCK 12, GRAND ISLE AREA, Jefferson Parish, Louisiana

That portion of Block 12, Grand Isle Area, Jefferson Parish, Louisiana, belonging to the State of Louisiana and not under mineral lease on April 1, 2001, described as follows: Beginning at the Northeast corner of Block 12, Grand Isle Area, having Coordinates of X = 2,428,143.81 and Y = 200,293.43; thence South 6,375.41 feet along the East line of said Block 12 to the Northeast corner of State Lease No. 16477 having Coordinates of X = 2,428,143.81 and Y = 193,918.02; thence along the boundary of said State Lease No. 16477 the following courses: West 3,115.00 feet and South 4,400.00 feet to its Southwest corner, also being a point on the North line of State Lease No. 14031 having Coordinates of X = 2,245,028.81 and Y = 189,518.02; thence West 3,885.00 feet along the North line of said State Lease No. 14031 to its Northwest corner, also being a point on the East line of State Lease No. 16476 having Coordinates of X = 2,421,143.81 and Y = 189,518.02; thence North 6,717.37 feet along the East line of said State Lease No. 16476 to its Northeast corner having Coordinates of X = 2,421,143.81 and Y = 196,235.04; thence North 4,058.04 feet to a point on the North line of said Block 12 having Coordinates of X = 2,421,143.81 and Y = 200,293.43; thence East 7,000.00 feet along the North line of said Block 12 to the point of beginning, containing approximately **1,416.94 acres**, as shown outlined in red on a plat on file in the Office of Mineral Resources, Department of Natural Resources, as provided by the applicant. All bearings, distances and coordinates are based on Louisiana Coordinate System of 1927 (South Zone)

NOTE: The boundary description and plat for this tract as shown and advertised were supplied by the nominating party and have not been checked for accuracy by the staff of the Office of Mineral Resources. Anything which may affect the acreage, the shape or the location of the tract, such as non-closure of or incorrect X, Y coordinates, title disputed acreage, or which may affect the status of the tract for leasing, such as overlap of prior leases or nominated tracts, which may affect potential operations on leases taken, such as inclusion in areas under the jurisdiction of the Department of Wildlife and Fisheries, will not be specifically determined unless and until a bid on this tract is accepted by the Mineral Board; which bid will be accepted on a per acre basis and which acceptance will be conditional upon such specific determinations being made. Once a bid is conditionally accepted by the Mineral Board, the staff will within a period following the date of the lease sale, determine the acreage, shape and location of the potential lease area of the tract, the status for leasing of all or any portion thereof, and all conditions which may affect potential operations thereon. The determinations may render all or a portion of the bid area unleaseable or may increase or decrease the State claimed acreage such that the total bonus/rental ultimately required may either exceed the bonus/rental paid at the lease sale, which will require additional payment by the successful bidder, or allow the successful bidder a refund of excessive payment. The successful bidder will be notified of the determinations by the staff and given an opportunity to visit the bid area acreage, configuration and location as it has been specifically determined. If all or a portion of the bid area is unleaseable due to overlap of an existing lease, the successful bidder

will be given an opportunity to accept or reject a new lease on that portion of the bid area which is not unleaseable. If rejected, the bid and all monies accompanying the bid will be returned to the successful bidder and no lease will be issued. In all other cases a new lease will be issued and any additional per acre bonus/rental, 10% administration fee or \$10 and \$5 per acre fees due as a result of staff determination of more State acreage in the bid area than determined by the successful bidder will be paid prior to the lease being issued. A determination of less State acreage in the bid area will result in a return to the successful bidder of any overpayment.

NOTE: The State of Louisiana does hereby reserve, and this lease shall be subject to, the imprescriptible right of surface use in the nature of a servitude in favor of the Department of Natural Resources, including its Offices and Commissions, for the sole purpose of implementing, constructing, servicing and maintaining approved coastal zone management and/or restoration projects. Utilization of any and all rights derived under this lease by the mineral lessee, its agents, successors or assigns, shall not interfere with or hinder the reasonable surface use by the Department of Natural Resources, its Offices or Commissions, as hereinabove reserved.

Applicant: South Padre Energy, Inc.

Bidder	Cash Payment	Price / Acre	Rental	Oil	Gas	Other

Blk. 5

Blk. 6

P. O. B.
X= 2,428,143.81
Y= 200,293.43

TR 33339
1,416.94 +/- ACS.
APRIL, 2001

Blk. 12

Blk. 11

SL 16476

SL 16477

SL 14031

GULF OF MEXICO

NAD 27 LAMBERT LA. SOUTH ZONE



Revised:

Grand Isle Area
Jefferson Parish, Louisiana

2000 0 2000



Scale in Feet

TRACT 33340 - PORTION OF BLOCK 12, GRAND ISLE AREA, Jefferson Parish, Louisiana

That portion of Block 12, Grand Isle Area, Jefferson Parish, Louisiana, belonging to the State of Louisiana and not under mineral lease on April 1, 2001, described as follows: Beginning at the Southwest corner of Block 12, Grand Isle Area, having Coordinates of X = 2,413,385.77 and Y = 185,535.39; thence North 10,439.67 feet on the East line of said Block 12 to its Northwest corner having Coordinates of X = 2,413,385.77 and Y = 195,975.00; thence Northeasterly on a straight line to a point having Coordinates of X = 2,413,785 and Y = 196,242; thence Northeasterly on a straight line to a point having Coordinates of X = 2,415,068 and Y = 197,994; thence Northeasterly on a straight line to a point having Coordinates of X = 2,415,162 and Y = 198,637; thence Northeasterly on a straight line to a point on the North line of said Block 12 having Coordinates of X = 2,416,413.61 and Y = 200,293.43; thence East 4,730.20 feet on the North line of said Block 12 to a point having Coordinates of X = 2,421,143.81 and Y = 200,293.43; thence South 4,058.04 feet to the Northeast corner of State Lease No. 16476 having Coordinates of X = 2,421,143.81 and Y = 196,235.39; thence along the boundary of said State Lease No. 16476 the following courses: West 3,945.00 feet and South 10,700.00 feet to its Southwest corner having Coordinates of X = 2,417,198.81 and Y = 185,535.39; thence West 3,813.04 feet along the South line of said Block 12 to the point of beginning, containing approximately **1,499.42 acres**, as shown outlined in red on a plat on file in the Office of Mineral Resources, Department of Natural Resources, as provided by the applicant. All bearings, distances and coordinates are based on Louisiana Coordinate System of 1927 (South Zone).

NOTE: The boundary description and plat for this tract as shown and advertised were supplied by the nominating party and have not been checked for accuracy by the staff of the Office of Mineral Resources. Anything which may affect the acreage, the shape or the location of the tract, such as non-closure of or incorrect X, Y coordinates or title disputed acreage, or which may affect the status of the tract for leasing, such as overlap of prior leases or nominated tracts, or which may affect potential operations on leases taken, such as inclusion in areas under the jurisdiction of the Department of Wildlife and Fisheries, will not be specifically determined unless and until a bid on this tract is accepted by the Mineral Board; which bid will be accepted on a per acre basis and which acceptance will be conditional upon such specific determinations being made. Once a bid is conditionally accepted by the Mineral Board, the staff will, within a period following the date of the lease sale, determine the acreage, shape and location of the potential lease area of the tract, the status for leasing of all or any portion thereof, and any conditions which may affect potential operations thereon. The determinations may render all or a portion of the bid area unleaseable or may increase or decrease the State claimed acreage such that the total bonus/rental ultimately required may either exceed the bonus/rental paid at the lease sale, which will require additional payment by the successful bidder, or allow the successful bidder a refund of excessive payment. The successful bidder will be notified of the determinations by the staff and given an opportunity to view the bid area acreage, configuration and location as it has been

specifically determined. If all or a portion of the bid area is unleaseable due to overlap of an existing lease, the successful bidder will be given an opportunity to accept or reject a new lease on that portion of the bid area which is not unleaseable. If rejected, the bid and all monies accompanying the bid will be returned to the successful bidder and no lease will be issued. In all other cases a new lease will be issued and any additional per acre bonus/rental, 10% administration fee or \$10 and \$5 per acre fees due as a result of staff determination of more State acreage in the bid area than determined by the successful bidder will be paid prior to the lease being issued. A determination of less State acreage in the bid area will result in a return to the successful bidder of any overpayment.

NOTE: The State of Louisiana does hereby reserve, and this lease shall be subject to, the imprescriptible right of surface use in the nature of a servitude in favor of the Department of Natural Resources, including its Offices and Commissions, for the sole purpose of implementing, constructing, servicing and maintaining approved coastal zone management and/or restoration projects. Utilization of any and all rights derived under this lease by the mineral lessee, its agents, successors or assigns, shall not interfere with or hinder the reasonable surface use by the Department of Natural Resources, its Offices or Commissions, as hereinabove reserved.

Applicant: South Padre Energy, Inc.

Bidder	Cash Payment	Price / Acre	Rental	Oil	Gas	Other

TR 33340
1,499.42 +/- ACS.
APRIL, 2001

SL 15077

Blk. 12

GULF OF MEXICO
SL 16476

Blk. 13

SL 14031

P. O. B.
X= 2,413,385.77
Y= 185,535.39

NAD 27 LAMBERT LA. SOUTH ZONE



Grand Isle Area
Jefferson Parish, Louisiana

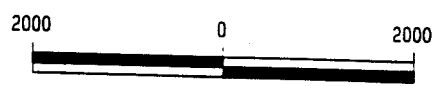

Scale in Feet

Revised:

TRACT 33341 - PORTION OF BLOCK 13, GRAND ISLE AREA, Jefferson Parish Louisiana

That portion of Block 13, Grand Isle Area, Jefferson Parish, Louisiana, belonging to the State of Louisiana and not under mineral lease on April 1, 2001, described as follows: Beginning at the Southeast corner of Block 13, Grand Isle Area, having Coordinates of X = 2,413,385.77 and Y = 185,535.3; thence West 11,456.74 feet on the South line of said Block 13 to a point having Coordinates of X = 2,401,929.03 and Y = 185,535.39; thence Northeasterly on a straight line to a point having Coordinates of X = 2,406,890 and Y = 189,733; thence Northeasterly on a straight line to the Southwest corner of State Lease No. 15077 having Coordinates of X = 2,410,3 and Y = 192,644; thence East 3,055.77 feet on the South line of said State Lease No. 15077 to its Southeast corner, also being a point on the East line of said Block 13 having Coordinates of X = 2,413,385.77 and Y = 192,644.0; thence South 7,108.61 feet on the East line of said Block 13 to the point beginning, containing approximately 1,184.14 acres, as shown outlined in red on a plat on file in the Office of Mineral Resources, Department of Natural Resources, as provided by the applicant. All bearings, distances and coordinates are based on Louisiana Coordinate System of 1927 (South Zone)

NOTE: The boundary description and plat for this tract as shown and advertised were supplied by the nominating party and have not been checked for accuracy by the staff of the Office of Mineral Resources. Anything which may affect the acreage, the shape or the location of the tract, such as non-closure of or incorrect X, Y coordinates of title disputed acreage, or which may affect the status of the tract for leasing, such as overlap of prior leases or nominated tracts, or which may affect potential operations on leases taken, such as inclusion in areas under the jurisdiction of the Department of Wildlife and Fisheries, will not be specifically determined unless and until a bid on this tract is accepted by the Mineral Board; which bid will be accepted on a per acre basis and which acceptance will be conditional upon such specific determinations being made. Once a bid is conditionally accepted by the Mineral Board, the staff will within a period following the date of the lease sale, determine the acreage, shape and location of the potential lease area of the tract, the status for leasing of all or any portion thereof, and any conditions which may affect potential operations thereon. These determinations may render all or a portion of the bid area unleaseable or may increase or decrease the State claimed acreage such that the total bonus/rental ultimately required may either exceed the bonus/rental paid at the lease sale, which will require additional payment by the successful bidder, or allow the successful bidder a refund of excessive payment. The successful bidder will be notified of the determinations by the staff and given an opportunity to view the bid area acreage, configuration and location as it has been specifically determined. If all or a portion of the bid area is unleaseable due to overlap of an existing lease, the successful bidder will be given an opportunity to accept or reject a new lease on that portion of the bid area which is not unleaseable. If rejected, the bid and all monies accompanying the bid will be returned to the successful bidder and no lease will be issued. In all other cases a new lease will be issued and any additional per acre bonus/rental