

NOT TO BE USED WITH A PORTION BID
FOR INFORMATIONAL PURPOSES ONLY!

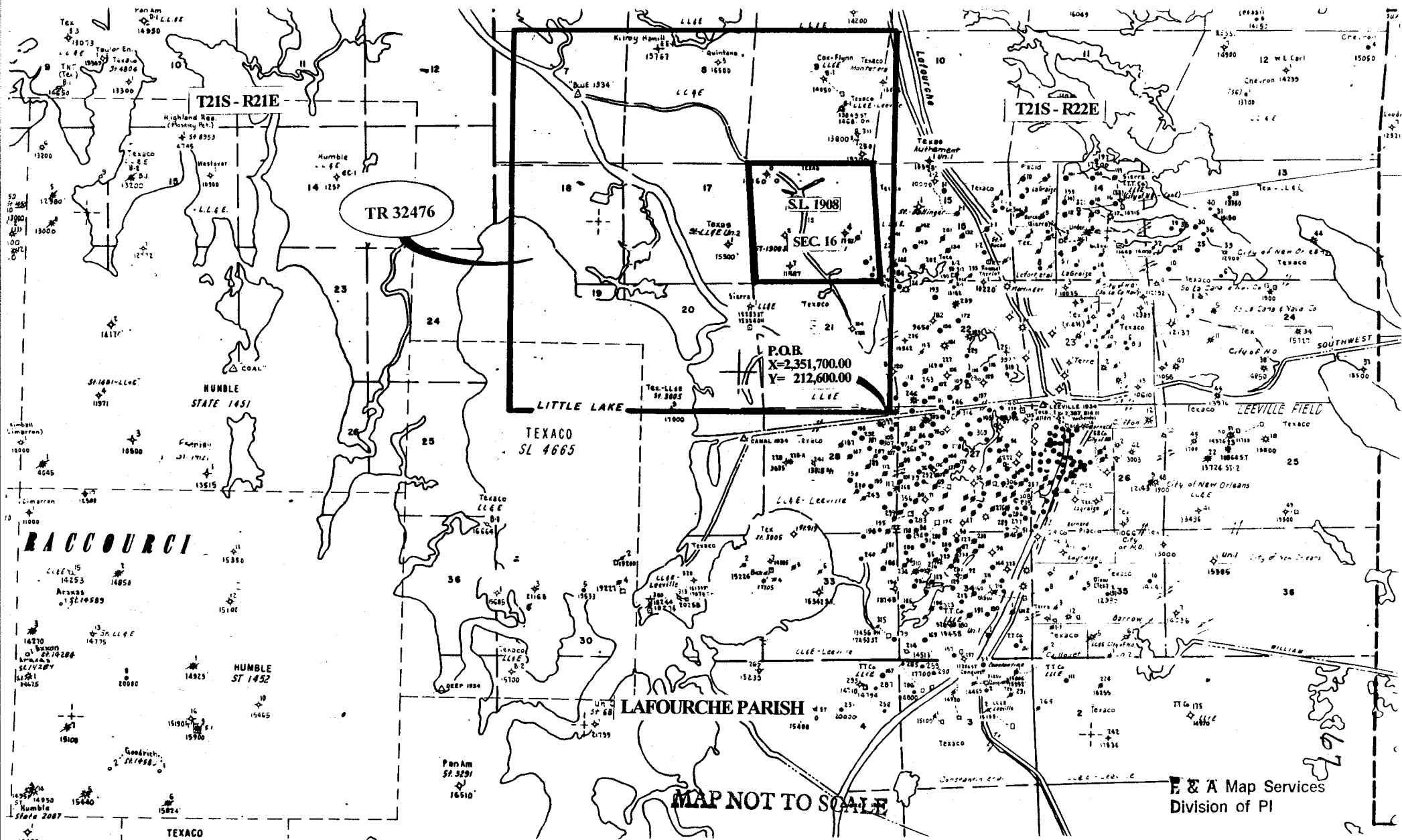

TRACT 32476 - STATE AGENCY - Lafourche Parish, Louisiana

A certain tract of land belonging to and not under mineral lease from the Louisiana Department of Transportation and Development, on April 12, 2000, being more fully described as follows: Beginning at a point having Coordinates of X = 2,351,700.00 and Y = 212,600.00; thence West 15,000.00 feet to a point having Coordinates of X = 2,336,700.00 and Y = 212,600.00; thence North 15,000.00 feet to a point having Coordinates of X = 2,336,700.00 and Y = 227,600.00; thence East 15,000.00 feet to a point having Coordinates of X = 2,351,700.00 and Y = 227,600.00; thence South 15,000.00 feet to the point of beginning, excluding beds and bottoms of all navigable waters, containing approximately 2 acres, as shown outlined in red on a plat on file in the Office of Mineral Resources, Department of Natural Resources. All bearings, distances and coordinates are based on Louisiana Coordinate System of 1927 (South Zone).

NOTE: The above tract is located in or near an oyster restricted area and all operations in such area must be conducted in strict conformity with the stipulations and/or regulations of the Louisiana Department of Wildlife and Fisheries.

NOTE: The State of Louisiana does hereby reserve, and this lease shall be subject to, the imprescriptible right of surface use in the nature of a servitude in favor of the Department of Natural Resources, including its Offices and Commissions, for the sole purpose of implementing, constructing, servicing and maintaining approved coastal zone management and/or restoration projects. Utilization of any and all rights derived under this lease by the mineral lessee, its agents, successors or assigns, shall not interfere with nor hinder the reasonable surface use by the Department of Natural Resources, its Offices or Commissions, as hereinabove reserved.

Applicant: R.A. Ransonet to Agency and by Letter of Authorization from the Louisiana Department of Transportation and Development authorizing the Mineral Board to act in its behalf.

Bidder	Cash Payment	Price / Acre	Rental	Oil	Gas	Other

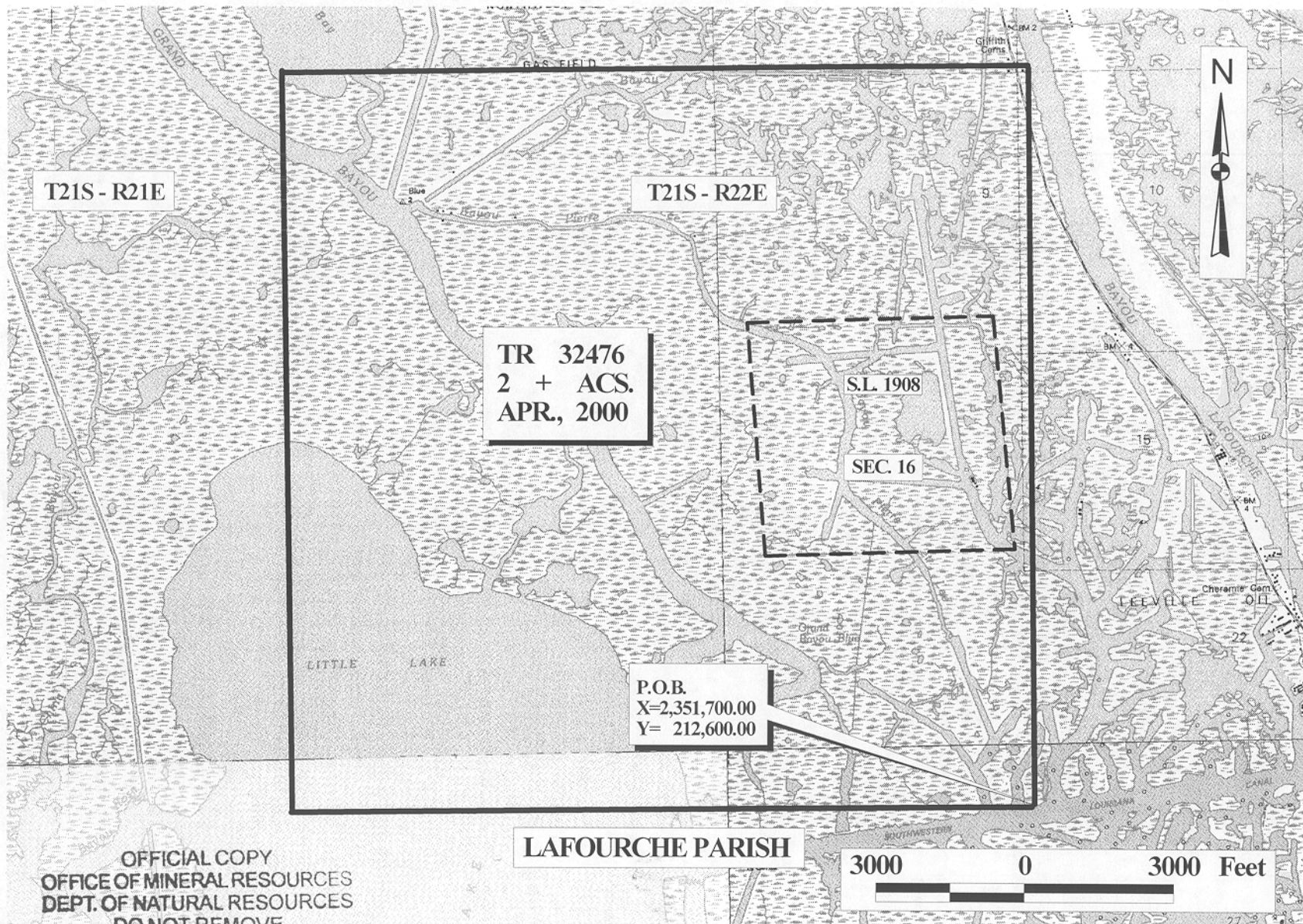

NOT TO BE USED WITH A PORTION BID
FOR INFORMATIONAL PURPOSES ONLY!

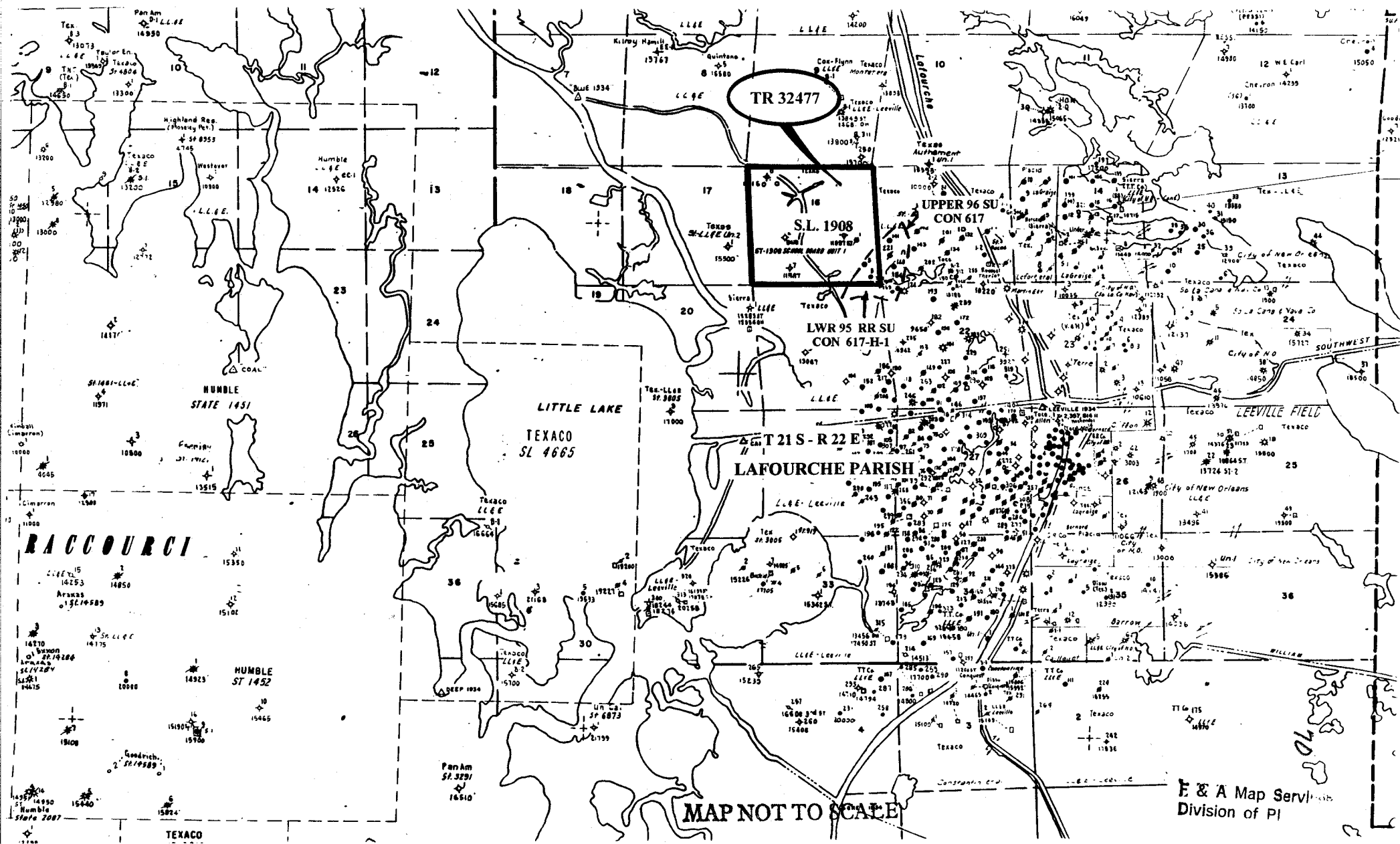

E & A Map Serv
Division of PI

TRACT 32477 - STATE AGENCY - Lafourche Parish, Louisiana

The State Mineral Board acting on behalf of the Lafourche Parish School Board, pursuant to Resolution adopted by that body and in accordance with Louisiana Revised Statutes 30:121-136 and 151-156, as amended, and Article 12, Section 18 of the Louisiana Constitution of 1921, as amended, which by Section 16 (A) 9, and 16 (B) of Article XIV of the 1974 Constitution is continued as a statute subject to arrangement in proper statutory form or modification provided by law, advertises the following described lands not under mineral lease on April 12, 2000: All of Section 16, Township 21 South, Range 22 East, Lafourche Parish, Louisiana, **LESS AND EXCEPT** State Lease No. 1908, as amended, and the composite acreage of the UPPER 96 SU, created by Conservation Order No. 617 and L L WR 95 RR SU, created by Conservation Order No. 617-H-1, falling within the above described tract, excluding beds and bottoms of all navigable waters located in said section, containing approximately 504.46 acres, as shown outlined in red on a plat on file in the Office of Mineral Resources, Department of Natural Resources.

NOTE: Lessor will accept not less than one-fourth royalties on all minerals.

NOTE: The Lessee shall conduct its operations in such a manner as to reasonably minimize any interference with or disruption of Lessor's use of the surface of the leased property or is use by Lessor's Lessees of hunting, trapping and/or pasturage rights.

NOTE: The above tract is located in or near an oyster restricted area and all operations in such area must be conducted in strict conformity with the stipulations and/or regulations of the Louisiana Department of Wildlife and Fisheries.

NOTE: The State of Louisiana does hereby reserve, and this lease shall be subject to, the imprescriptible right of surface use in the nature of a servitude in favor of the Department of Natural Resources, including its Offices and Commissions, for the sole purpose of implementing, constructing, servicing and maintaining approved coastal zone management and/or restoration projects. Utilization of any and all rights derived under this lease by the mineral lessee, its agents, successors or assigns, shall not interfere with nor hinder the reasonable surface use by the Department of Natural Resources, its Offices or Commissions, as hereinabove reserved.

Applicant: R.A. Ransonet to Agency and by Resolution from the Lafourche Parish School Board authorizing the Mineral Board to act in its behalf.

Bidder	Cash Payment	Price / Acre	Rental	Oil	Gas	Other

TR 32477
504.46 + ACS.
APR., 2000

S.L. 1908

UPPER 96 SU
CON 617 15

LWR 95 RRSU
CON 617-H-1

LAFOURCHE PARISH
T21S - R22E

OFFICIAL COPY
OFFICE OF MINERAL RESOURCES
DEPT. OF NATURAL RESOURCES
DO NOT REMOVE

2000 0 2000 Feet