

TRACT 32469 - Plaquemines Parish, Louisiana

All of the lands now or formerly constituting the beds and bottoms of all water bodies of every nature and description and all islands and other lands formed by accretion or reliction, except tax lands, owned by and not under mineral lease from the State of Louisiana on April 12, 2000, situated in Plaquemines Parish, Louisiana, within the following described boundaries: Beginning at a point having Coordinates of X = 2,511,000.00 and Y = 344,800.00; thence West 9,460.00 feet to a point having Coordinates of X = 2,501,540.00 and Y = 344,800.00; thence Northerly approximately 463 feet to the Southeast corner of State Lease No. 1212, as amended; thence Northerly along the East boundary of said State Lease No. 1212 approximately 1,403 feet to the Southwest corner of State Lease No. 16568; thence along the boundary of said State Lease No. 16568 North 88 degrees 51 minutes 16 seconds East approximately 3,840 feet to its Southeast corner having Coordinates of X = 2,505,316.00 and Y = 346,742.00; thence along the boundary of said State Lease No. 16568 North 01 degrees 33 minutes 29 seconds West 2,353.87 feet to its Northeast corner having Coordinates of X = 2,505,252.00 and Y = 349,095.00; thence along the boundary of said State Lease No. 16568 South 88 degrees 51 minutes 16 seconds West approximately 3,880 feet to its Northwest corner, also being a point on the East boundary of said State Lease No. 1212; thence Northerly along the East boundary of said State Lease No. 1212 approximately 2,783 feet to the Southwest corner of State Lease No. 16567; thence along the boundary of said State Lease No. 16567 North 85 degrees 03 minutes 51 seconds East approximately 1,010 feet to its Southeast corner having Coordinates of X = 2,502,355.00 and Y = 351,887.00; thence along the boundary of said State Lease No. 16567 North 03 degrees 12 minutes 55 seconds 2,033.02 feet to its Northeast corner having Coordinates of X = 2,502,240.97 and Y = 353,916.82; thence Westerly along the boundary of said State Lease No. 16567 approximately 819 feet to its Northwest corner, also being the most Eastern Northeast corner of said State Lease No. 1212; thence Northerly approximately 1,850 feet to the Southeast corner of State Lease No. 16566 having Coordinates of X = 2,501,489.00 and Y = 355,719.00; thence along the East line of said State Lease No. 16566 North 02 degrees 01 minutes 30 seconds East 1,499.94 feet to its Northeast corner having Coordinates of X = 2,501,542.00 and Y = 357,218.00, also being the Southwest corner of State Lease No. 16340; thence along the boundary of said State Lease No. 16340 North 86 degrees 46 minutes 08 seconds East 2,235.55 feet to its Southeast corner having Coordinates of X = 2,503,774.00 and Y = 357,344.00; thence North 86 degrees 44 minutes 45 seconds East 3,294.31 feet to a point having Coordinates of X = 2,507,063.00 and Y = 357,531.00; thence South 01 degrees 13 minutes 39 seconds West 2,114.88 feet to a point on the North boundary of State Lease No. 16341 having Coordinates of X = 2,507,017.69 and Y = 355,416.61; thence along the boundary of said State Lease No. 16341 South 88 degrees 28 minutes 17 seconds West 1,522.23 feet to its Northwest corner having Coordinates of X = 2,505,496.00 and Y = 355,376.00; thence along the boundary of said State Lease No. 16341 South 01 degrees 44 minutes 23 seconds East 3,030.40 feet to its Southwest corner having Coordinates of X = 2,505,588.00 and Y = 352,347.00; thence along the boundary of said State Lease No. 16341 North 86 degrees 33 minutes 14 seconds East 5,421.80 feet to a point having Coordinates of X = 2,511,000.00 and Y = 352,672.91; thence South 7,872.91 feet to the point of beginning, **LESS AND EXCEPT** any portion of State Lease No. 1212, as amended, that may lie within the above described tract, containing approximately 1,021 acres, as shown outlined in red on a plat on file in the Office of Mineral Resources, Department of Natural Resources. All bearings, distances and coordinates are based on Louisiana Coordinate System of 1927 (South Zone).

NOTE: The above tract is located in or near an oyster restricted area and all operations in such area must be conducted in strict conformity with the stipulations and/or regulations of the Louisiana Department of Wildlife and Fisheries.

NOTE: The State of Louisiana does hereby reserve, and this lease shall be subject to, the imprescriptible right of surface use in the nature of a servitude in favor of the Department of Natural Resources, including its Offices and Commissions, for the sole purpose of implementing, constructing, servicing and maintaining approved coastal zone management and/or restoration projects. Utilization of any and all rights derived under this lease by the mineral lessee, its agents, successors or assigns, shall not interfere with nor hinder the reasonable surface use by the Department of Natural Resources, its Offices or Commissions, as hereinabove reserved.

Applicant: Core Energy Group, Inc.

Bidder	Cash Payment	Price / Acre	Rental	Oil	Gas	Other

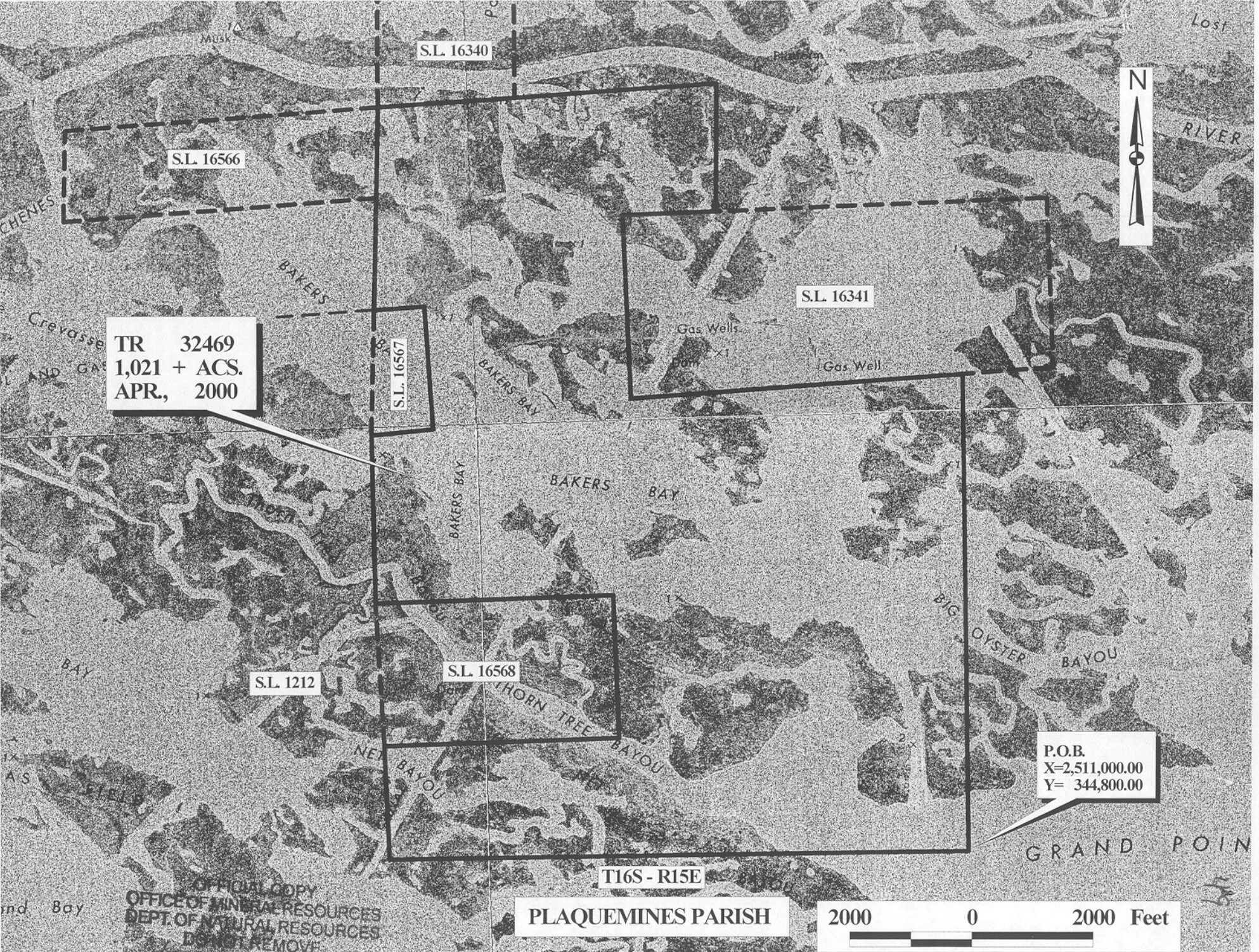

TR 32469
1,021 + ACS.
APR., 2000

S.L. 16340

S.L. 16566

S.L. 16341

S.L. 16567

S.L. 1212

S.L. 16568

P.O.B.
X=2,511,000.00
Y= 344,800.00

T16S - R15E

PLAQUEMINES PARISH

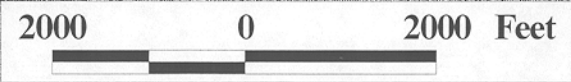

OFFICIAL COPY
OFFICE OF MINERAL RESOURCES
DEPT. OF NATURAL RESOURCES
DO NOT REMOVE

TRACT 32470 - WITHDRAWN - PER APPLICANT

Bidder	Cash Payment	Price / Acre	Rental	Oil	Gas	Other