

**TRACT 32459 - Terrebonne Parish, Louisiana**

All of the lands now or formerly constituting the beds and bottoms of all water bodies of every nature and description and all islands and other lands formed by accretion or reliction, except tax lands, owned by and not under mineral lease from the State of Louisiana on April 12, 2000, situated in Terrebonne Parish, Louisiana, within the following described boundaries: Beginning at a point having Coordinates of X = 2,203,385.94 and Y = 164,900.00; thence North 6,846.00 feet to a point having Coordinates of X = 2,203,385.94 and Y = 171,746.00; thence East approximately 1,500 feet to the Southwest corner of State Lease No. 199, as amended; thence along the Southern boundary of said State Lease No. 199 the following courses: East, North and East to the Northwest corner of State Lease No. 16510; thence South on the West line of said State Lease No. 16510 to its Southwest corner; thence West approximately 2,620 feet to a point having Coordinates of X = 2,209,930.00 and Y = 167,890.00; thence South 2,990.00 feet to a point having Coordinates of X = 2,209,930.00 and Y = 164,900.00; thence West 6,544.06 feet to the point of beginning, **LESS AND EXCEPT** any portion of State Lease No. 199, as amended, and State Lease No. 16510 that may lie within the above described tract, containing approximately 1,268 acres, as shown outlined in red on a plat on file in the Office of Mineral Resources, Department of Natural Resources. All bearings, distances and coordinates are based on Louisiana Coordinate System of 1927 (South Zone).

NOTE: The above tract is located in or near an oyster restricted area and all operations in such area must be conducted in strict conformity with the stipulations and/or regulations of the Louisiana Department of Wildlife and Fisheries.

NOTE: The State of Louisiana does hereby reserve, and this lease shall be subject to, the imprescriptible right of surface use in the nature of a servitude in favor of the Department of Natural Resources, including its Offices and Commissions, for the sole purpose of implementing, constructing, servicing and maintaining approved coastal zone management and/or restoration projects. Utilization of any and all rights derived under this lease by the mineral lessee, its agents, successors or assigns, shall not interfere with nor hinder the reasonable surface use by the Department of Natural Resources, its Offices or Commissions, as hereinabove reserved.

Applicant: Louisiana Oil and Gas, Inc.

Bidder	Cash Payment	Price / Acre	Rental	Oil	Gas	Other

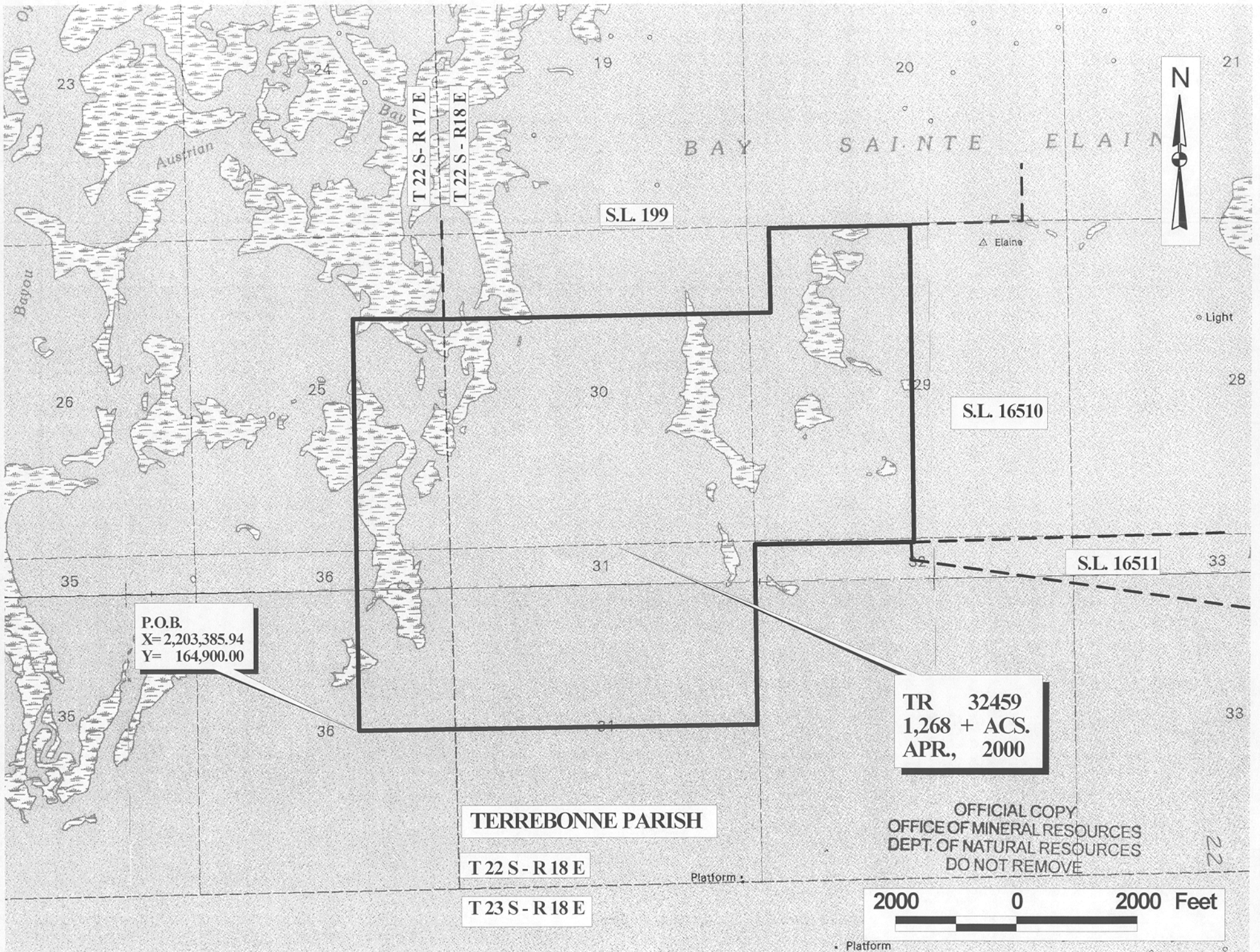

P.O.B.  
X= 2,203,385.94  
Y= 164,900.00

S.L. 16510

S.L. 16511

TR 32459  
1,268 + ACS.  
APR., 2000

TERREBONNE PARISH

T 22 S - R 18 E

T 23 S - R 18 E

OFFICIAL COPY  
OFFICE OF MINERAL RESOURCES  
DEPT. OF NATURAL RESOURCES  
DO NOT REMOVE

2000 0 2000 Feet

Platform

**TRACT 32460 - Terrebonne Parish, Louisiana**

All of the lands now or formerly constituting the beds and bottoms of all water bodies of every nature and description and all islands and other lands formed by accretion or reliction, except tax lands, owned by and not under mineral lease from the State of Louisiana on April 12, 2000, situated in Terrebonne Parish, Louisiana, within the following described boundaries: Beginning at a point having Coordinates of X = 2,203,385.94 and Y = 164,900.00; thence East 6,544.06 feet to a point having Coordinates of X = 2,209,930.00 and Y = 164,900.00; thence South approximately 5,280 feet to a point on the Northern boundary of State Lease No. 188, as amended, having a Coordinate of X = 2,209,930.00; thence along the boundary of said State Lease No. 188 the following courses: West, South, West, South and West approximately 2,800 feet to a point having a Coordinate of X = 2,203,385.94; thence North approximately 10,250 feet to the point of beginning, **LESS AND EXCEPT** any portion of State Lease No. 188, as amended, that may lie within the above described tract, containing approximately 1,224 acres, as shown outlined in red on a plat on file in the Office of Mineral Resources, Department of Natural Resources. All bearings, distances and coordinates are based on Louisiana Coordinate System of 1927 (South Zone).

NOTE: The above tract is located in or near an oyster restricted area and all operations in such area must be conducted in strict conformity with the stipulations and/or regulations of the Louisiana Department of Wildlife and Fisheries.

NOTE: The State of Louisiana does hereby reserve, and this lease shall be subject to, the imprescriptible right of surface use in the nature of a servitude in favor of the Department of Natural Resources, including its Offices and Commissions, for the sole purpose of implementing, constructing, servicing and maintaining approved coastal zone management and/or restoration projects. Utilization of any and all rights derived under this lease by the mineral lessee, its agents, successors or assigns, shall not interfere with nor hinder the reasonable surface use by the Department of Natural Resources, its Offices or Commissions, as hereinabove reserved.

Applicant: Louisiana Oil and Gas, Inc.

Bidder	Cash Payment	Price / Acre	Rental	Oil	Gas	Other

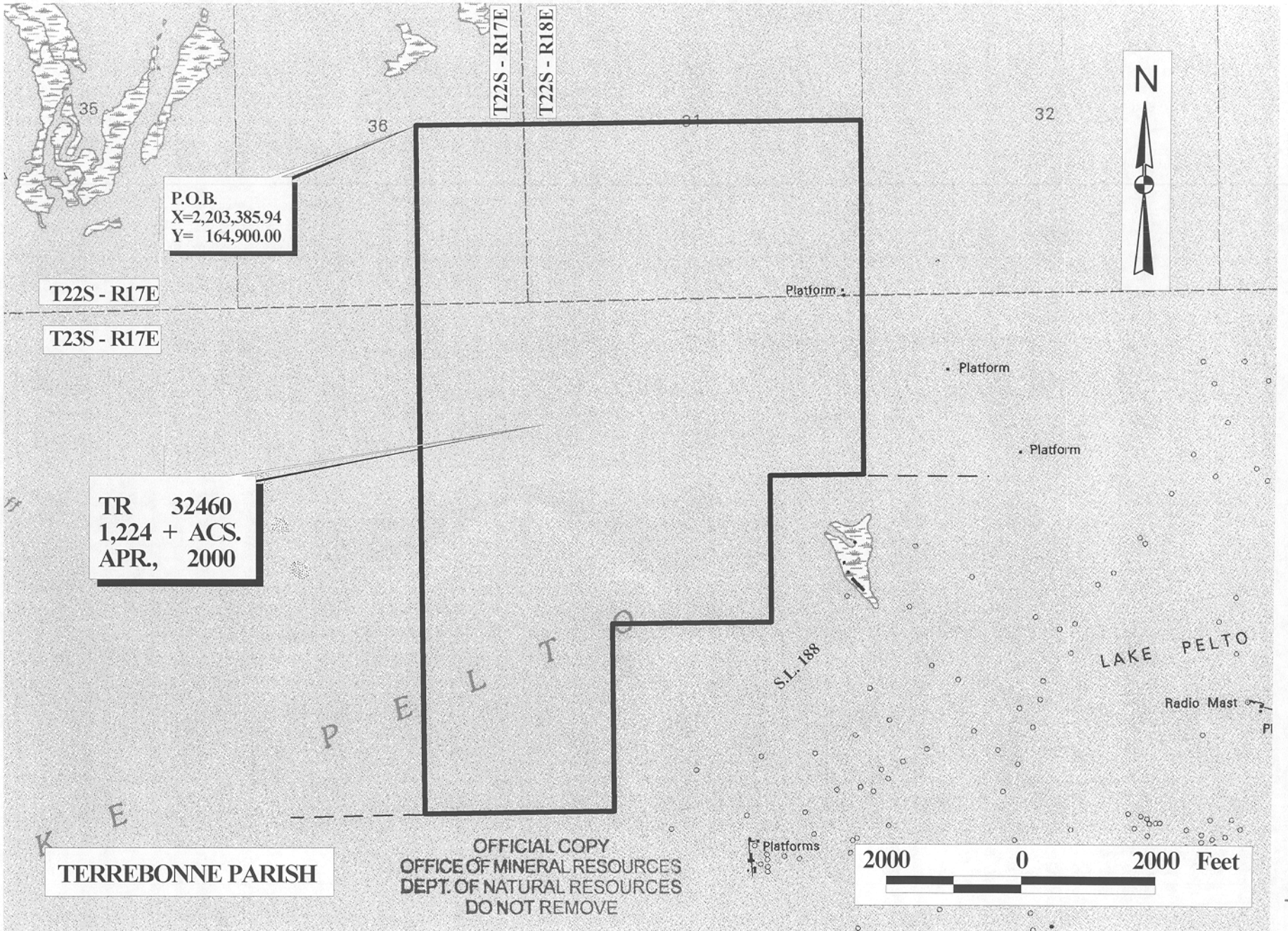

P.O.B.  
X=2,203,385.94  
Y= 164,900.00

T22S - R17E

T23S - R17E

TR 32460  
1,224 + ACS.  
APR., 2000

TERREBONNE PARISH

OFFICIAL COPY  
OFFICE OF MINERAL RESOURCES  
DEPT. OF NATURAL RESOURCES  
DO NOT REMOVE

2000 0 2000 Feet

**TRACT 32461 - Terrebonne Parish, Louisiana**

All of the lands now or formerly constituting the beds and bottoms of all water bodies of every nature and description and all islands and other lands formed by accretion or reliction, except tax lands, owned by and not under mineral lease from the State of Louisiana on April 12, 2000, situated in Terrebonne Parish, Louisiana, within the following described boundaries: Beginning at a point having Coordinates of X = 2,209,930.00 and Y = 167,890.00; thence East approximately 2,620 feet to the Northwest corner of State Lease No. 16511; thence South on the West line of said State Lease No. 16511 to its Southwest corner; thence Southeasterly on the South line of said State Lease No. 16511 to its Southeast corner, also being a point on the Western boundary of State Lease No. 2620, as amended; thence Southeasterly on the boundary of said State Lease No. 2620 to the most Northerly Northeast corner of State Lease No. 188, as amended; thence along the boundary of said State Lease No. 188 the following courses: West, South, West, South and West to a point having a Coordinate of X = 2,209,930.00; thence North approximately 8,270 feet to the point of beginning, **LESS AND EXCEPT** any portion of State Lease No. 188, as amended, State Lease No. 2620, as amended, and State Lease No. 16511 that may lie within the above described tract, containing approximately **1,019 acres**, as shown outlined in red on a plat on file in the Office of Mineral Resources, Department of Natural Resources. All bearings, distances and coordinates are based on Louisiana Coordinate System of 1927 (South Zone).

NOTE: The above tract is located in or near an oyster restricted area and all operations in such area must be conducted in strict conformity with the stipulations and/or regulations of the Louisiana Department of Wildlife and Fisheries.

NOTE: The State of Louisiana does hereby reserve, and this lease shall be subject to, the imprescriptible right of surface use in the nature of a servitude in favor of the Department of Natural Resources, including its Offices and Commissions, for the sole purpose of implementing, constructing, servicing and maintaining approved coastal zone management and/or restoration projects. Utilization of any and all rights derived under this lease by the mineral lessee, its agents, successors or assigns, shall not interfere with nor hinder the reasonable surface use by the Department of Natural Resources, its Offices or Commissions, as hereinabove reserved.

Applicant: Louisiana Oil and Gas, Inc.

Bidder	Cash Payment	Price / Acre	Rental	Oil	Gas	Other