

OFFICIAL COPY
OFFICE OF MINERAL RESOURCES
DEPT. OF NATURAL RESOURCES
DO NOT REMOVE

56

OIL

ELOI

Platforms

BLOCK 71

TR 32472
1,850 + ACS.
APR., 2000

S.L. 16009

BLOCK 71 GAS FIELD

S.L. 6618

S.L. 12503

P.O.B.
X=2,605,850.00
Y= 381,330.00

CHANDELEUR SOUND AREA

ST. BERNARD PARISH

OFFICIAL COPY
OFFICE OF MINERAL RESOURCES
DEPT. OF NATURAL RESOURCES
DO NOT REMOVE

SCALE: 1"=2000'

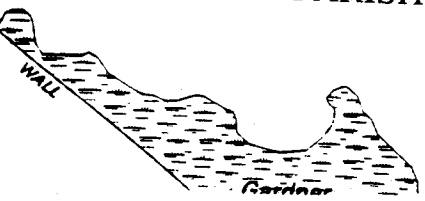
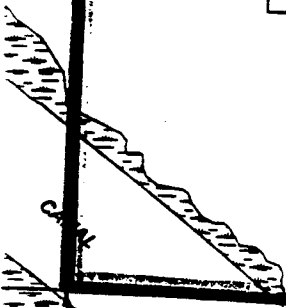

TRACT 32473 - PORTION OF BLOCK 3, MAIN PASS AREA, REVISED, St. Bernard Parish, Louisiana

All of the lands now or formerly constituting the beds and bottoms of all water bodies of every nature and description and all islands and other lands formed by accretion or reliction, except tax lands, belonging to the State of Louisiana and not under mineral lease on April 12, 2000, situated in St. Bernard Parish, Louisiana, and more particularly described as follows: Beginning at a point common to the North line of Block 3, Main Pass Area, Revised, and the Northeastern part of the 5900' Sand, as per that certain Conservation Order No. 1086-E, dated October 24, 1989, revised January 12, 1990, having Coordinates of X = 2,618,169.05 and Y = 381,330.00; thence continue along the boundaries of said 5900' Sand as follows: South 70 degrees 28 minutes 32 seconds East 980.55 feet, South 67 degrees 53 minutes 18 seconds East 585.45 feet, South 38 degrees 40 minutes 42 seconds West 173.07 feet, South 60 degrees 11 minutes 12 seconds West 200.07 feet, South 66 degrees 13 minutes 35 seconds West 405.06 feet, South 77 degrees 42 minutes 12 seconds West 390.80 feet, South 84 degrees 45 minutes 05 seconds West 479.47 feet, North 87 degrees 56 minutes 22 seconds West 406.62 feet, North 84 degrees 27 minutes 51 seconds West 304.86 feet, North 77 degrees 03 minutes 21 seconds West 300.22 feet, North 74 degrees 19 minutes 52 seconds West 292.18 feet, North 68 degrees 24 minutes 17 seconds West 687.82 feet, North 69 degrees 52 minutes 05 seconds West 405.34 feet, North 66 degrees 28 minutes 57 seconds West 620.98 feet, North 77 degrees 06 minutes 37 seconds West 205.35 feet, North 85 degrees 50 minutes 00 seconds West 294.26 feet, North 86 degrees 04 minutes 59 seconds West 502.83 feet, North 80 degrees 39 minutes 45 seconds West 302.86 feet and North 68 degrees 47 minutes 42 seconds West 253.58 feet to a point on the North line of said Block 3 having Coordinates of X = 2,613,720.08 and Y = 381,330.00; thence East 944.70 feet along the North line of said Block 3 to the most West corner of State Lease No. 12789, as amended, having Coordinates of X = 2,614,664.78 and Y = 381,330.00; thence along the Southern boundaries of said State Lease No. 12789 as follows: South 80 degrees 49 minutes 00 seconds East 896.27 feet, South 87 degrees 40 minutes 45 seconds East 484.76 feet, North 89 degrees 07 minutes 07 seconds East 700.88 feet, North 85 degrees 16 minutes 27 seconds East 501.53 feet and North 82 degrees 52 minutes 35 seconds East 891.62 feet to a point on the North line of said Block 3 having Coordinates of X = 2,618,119.28 and Y = 381,330.00; thence East along the North line of said Block 3 to the point of beginning, containing approximately 70.509 acres, as shown outlined in red on a plat on file in the Office of Mineral Resources, Department of Natural Resources. All bearings, distances and coordinates are based on Louisiana Coordinate System of 1927 (South Zone).

NOTE: The above tract is located in or near an oyster restricted area and all operations in such area must be conducted in strict conformity with the stipulations and/or regulations of the Louisiana Department of Wildlife and Fisheries.

NOTE: It appears, according to our records, that a portion of this tract is located within the restrictive safety fairway area as set out by the Corps of Engineers, U.S. Army.

NOTE: The State of Louisiana does hereby reserve, and this lease shall be subject to, the imprescriptible right of surface use in the nature of a servitude in favor of the Department of Natural Resources, including its Offices and Commissions, for the sole purpose of implementing, constructing, servicing and maintaining approved

coastal zone management and/or restoration projects. Utilization of any and all rights derived under this lease by the mineral lessee, its agents, successors or assigns, shall not interfere with nor hinder the reasonable surface use by the Department of Natural Resources, its Offices or Commissions, as hereinabove reserved.

Applicant: Cypress Energy Corporation

Bidder	Cash Payment	Price / Acre	Rental	Oil	Gas	Other

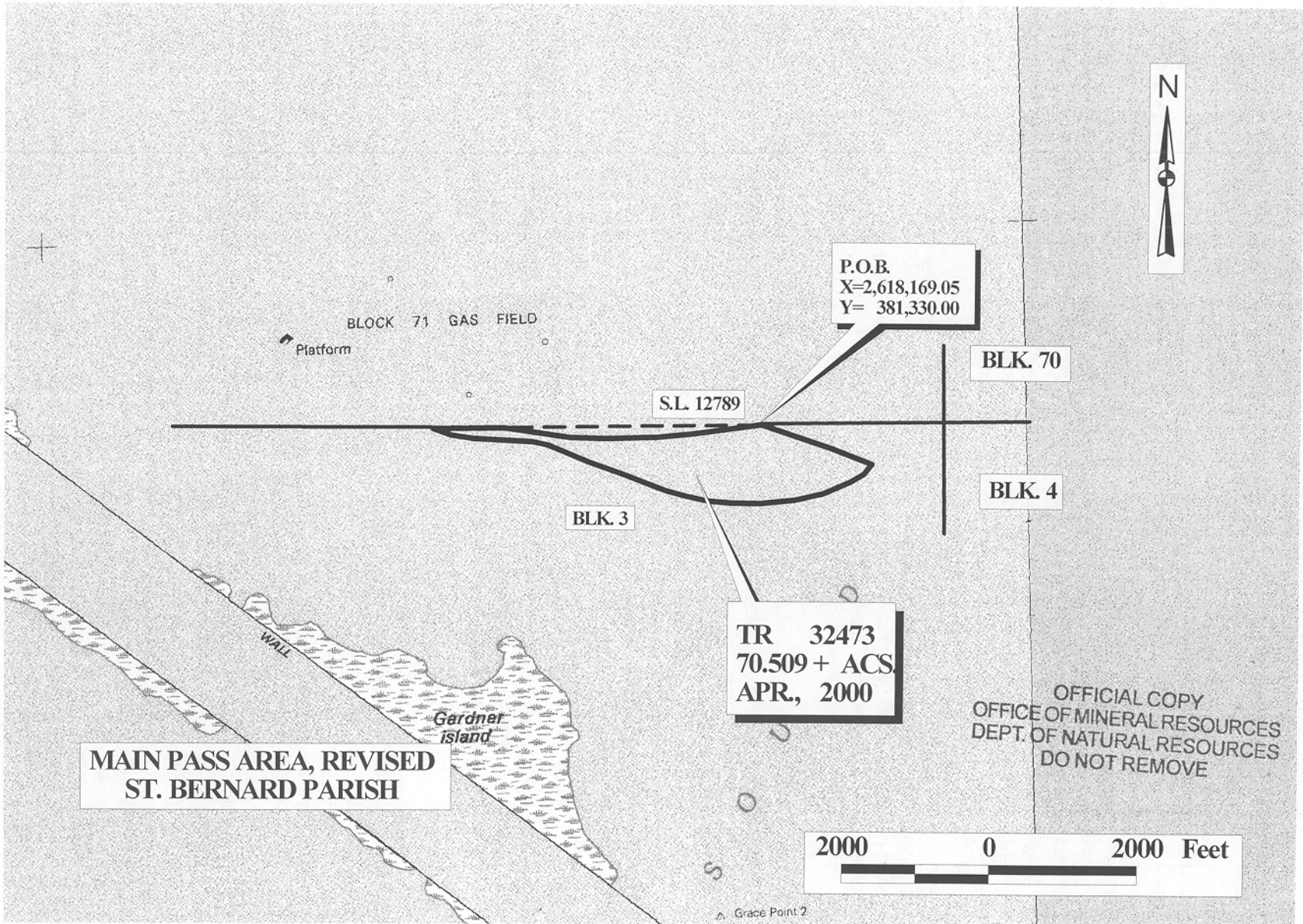

**MAIN PASS AREA, REVISED
ST. BERNARD PARISH**

BLOCK 71 GAS FIELD
Platform

**P.O.B.
X=2,618,169.05
Y= 381,330.00**

S.L. 12789

BLK. 70

BLK. 3

BLK. 4

**TR 32473
70.509 + ACS
APR., 2000**

OFFICIAL COPY
OFFICE OF MINERAL RESOURCES
DEPT. OF NATURAL RESOURCES
DO NOT REMOVE

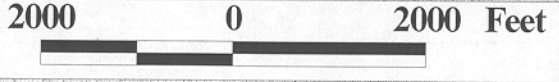

Grace Point 2