

TRACT 45079 - Portion of Blocks 39, and 48, Ship Shoal Area, Terrebonne Parish, Louisiana

The beds and bottoms of all water bodies belonging to the State of Louisiana located in Blocks 39, and 48, Ship Shoal Area, together with any present lands formed by accretion to the shoreline or islands formed therein, located in Terrebonne Parish, Louisiana, owned by and not presently under mineral lease as of March 13, 2019, from the State of Louisiana, the geographical area of which is more fully described as follows: Beginning at the Southeast corner of Block 48, Ship Shoal Area, having Coordinates of X = 2,124,800.00 and Y = 127,591.99; thence West 7,483.00 feet along the South line of said Block 48, Ship Shoal Area, to a point having Coordinates of X = 2,117,317.00 and Y = 127,591.99; thence North 15,899.01 feet to a point on the Louisiana Coastline, as decreed by the Supreme Court of the United States, as determined by a Special Master appointed therein, in litigation styled *United States v. State of Louisiana et al No. 9 Original*, in 1975, having Coordinates of X = 2,117,317 and Y = 143,491; thence along said Louisiana Coastline the following: Southeasterly along a straight line to a point having Coordinates of X = 2,118,065 and Y = 142,532, Southeasterly along a straight line to a point having Coordinates of X = 2,118,829 and Y = 141,971, Southeasterly along a straight line to a point having Coordinates of X = 2,122,523 and Y = 140,238, and Southeasterly along a straight line to a point having Coordinates of X = 2,124,800.00 and Y = 139,755.21, said point being on the East line of said Block 48, Ship Shoal Area; thence South 12,163.23 feet along said East line of said Block 48, Ship Shoal Area, to the to the point of beginning, containing approximately **2,316.21 acres**, all as more particularly outlined on a plat on file in the Office of Mineral Resources, Department of Natural Resources. All bearings, distances and coordinates are based on Louisiana Coordinate System of 1927, (North or South Zone).

NOTE: The above description of the Tract nominated for lease has been provided and corrected, where required, exclusively by the nomination party. Any mineral lease selected from this Tract and awarded by the Louisiana State Mineral and Energy Board shall be without warranty of any kind, either express, implied, or statutory, including, but not limited to, the implied warranties of merchantability and fitness for a particular purpose. Should the mineral lease awarded by the Louisiana State Mineral and Energy Board be subsequently modified, cancelled or abrogated due to the existence of conflicting leases, operating agreements, private claims or other future obligations or conditions which may affect all or any portion of the leased Tract, it shall not relieve the Lessee of the obligation to pay any bonus due thereon to the Louisiana State Mineral and Energy Board, nor shall the Louisiana State Mineral and Energy Board be obligated to refund any consideration paid by the Lessor prior to such modification, cancellation, or abrogation, including, but not limited to, bonuses, rentals and royalties.

NOTE: The State of Louisiana does hereby reserve, and this lease shall be subject to, the imprescriptible right of surface use in the nature of a servitude in favor of the Department of Natural Resources, including its Offices and Commissions, for the sole purpose of implementing, constructing,

servicing and maintaining approved coastal zone management and/or restoration projects. Utilization of any and all rights derived under this lease by the mineral lessee, its agents, successors or assigns, shall not interfere with nor hinder the reasonable surface use by the Department of Natural Resources, its Offices or Commissions, as herein above reserved.

NOTE: It appears, according to our records, that a portion of this Tract is located within the restrictive safety fairway area as set out by the Corps of Engineers, U.S. Army and/or the restrictive anchorage area as set out by the U.S. Coast Guard.

Applicant: ROBERT A. SCHROEDER, INC.

Bidder	Cash Payment	Price/ Acre	Rental	Oil	Gas	Other



0 2,500 Feet

Legend

19030036

Blocks

TERREBONNE

SS0039

T24S - R15E

SS0047

SHIP SHOAL AREA

GULF OF MEXICO

SS0048

P.O.B.

SS0063

SS0064

TRACT 45080 - Portion of Block 47, Ship Shoal Area, Terrebonne Parish, Louisiana

The beds and bottoms of all water bodies belonging to the State of Louisiana located in Block 47, Ship Shoal Area, together with any present lands formed by accretion to the shoreline or islands formed therein, located in Terrebonne Parish, Louisiana, owned by and not presently under mineral lease as of March 13, 2019, from the State of Louisiana, the geographical area of which is more fully described as follows: Beginning at a point having Coordinates of X = 2,124,800.00 and Y = 127,591.99 said point being the Southwest corner of Block 47, Ship Shoal Area; thence North 12,163.23 feet along the West line of said Block 47, Ship Shoal Area, to a point having Coordinates of X = 2,124,800.00 and Y = 139,755.21, said point being on the Louisiana Coastline, as decreed by the Supreme Court of the United States, as determined by a Special Master appointed therein, in litigation styled *United States v. State of Louisiana et al No. 9 Original*, in 1975; thence along said Louisiana Coastline the following: Southeasterly along a straight line to a point having Coordinates of X = 2,126,697 and Y = 139,353, Southeasterly along a straight line to a point having Coordinates of X = 2,128,819 and Y = 138,694, Southeasterly along a straight line to a point having Coordinates of X = 2,133,089 and Y = 136,940, Southeasterly along a straight line to a point having Coordinates of X = 2,134,210 and Y = 136,726, and Southeasterly along a straight line to a point having Coordinates of X = 2,138,231 and Y = 136,387; thence South 3,004.32 feet to a point being the Northwest corner of State Lease No. 21868 having Coordinates of X = 2,138,231.00 and Y = 133,382.68, said point being the Northeast corner of State Lease No. 21867; thence along the boundary of said State Lease No. 21867 the following: West 710.00 feet to a point having Coordinates of X = 2,137,521.00 and Y = 133,382.68; North 80 degrees 20 minutes 11 seconds West 3,222.95 feet to a point having Coordinates of X = 2,134,343.78 and Y = 133,923.70; South 84 degrees 46 minutes 24 seconds West 3,754.47 feet to a point having Coordinates of X = 2,130,604.92 and Y = 133,581.68, and South 102.04 feet to a point having Coordinates of X = 2,130,604.92 and Y = 133,479.64, said point being the Northeast corner of State Lease No. 21879 (Parcel 1); thence along the boundary of said State Lease No. 21879 (Parcel 1) the following: West 1,562.08 feet to a point having Coordinates of X = 2,129,042.84 and Y = 133,479.64, South 1,460.53 feet to a point having Coordinates of X = 2,129,042.84 and Y = 132,019.11, West 1,736.84 feet to a point having Coordinates of X = 2,127,306.00 and Y = 132,019.11, South 2,842.11 feet to a point having Coordinates of X = 2,127,306.00 and Y = 129,177.00, and North 59 degrees 30 minutes 38 seconds East 3,828.28 to a point being its Southeast corner having Coordinates of X = 2,130,604.92 and Y = 131,119.39, said also point being on the Western boundary of said State Lease No. 21867; thence along boundary of said State Lease No. 21867 the following: South 93.39 feet to a point having Coordinates of X = 2,130,604.92 and Y = 131,026.00 and North 53 degrees 12 minutes 13 seconds East 732.48 to a point having Coordinates of X = 2,131,191.46 and Y = 131,464.74, said point being the Southwest corner of State Lease No. 21879 (Parcel 3), and North 59 degrees 30 minutes 38 seconds East 962.08 along the boundary of said State Lease No. 21879 (Parcel 3) to a point having Coordinates of X = 2,132,020.51

and Y = 131,952.88, said point being on the Southern boundary of said State Lease No. 21867; thence East 901.86 feet along said Southern boundary of said State Lease No. 21867 to a point having Coordinates of X = 2,132,922.37 and Y = 131,952.88, said point being the Northwest corner of State Lease No. 21879 (Parcel 2); thence along the boundary of said State Lease No. 21879 (Parcel 2) the following: South 376.88 feet to a point having Coordinates of X = 2,132,922.37 and Y = 131,576.00, and East 1,302.63 feet to a point being its Southeast corner having Coordinates of X = 2,134,225.00 and Y = 131,576.00, said point also being on the Western boundary of State Lease No. 21634; thence South 1,853.24 feet along said Western boundary of said State Lease No. 21634 to a point being its Southwest corner having Coordinates of X = 2,134,225.00 and Y = 129,722.76, said point also being the Northwest corner of State Lease No. 21866; thence South 2,130.77 feet along the Western boundary of said State Lease No. 21866 to a point being its Southwest corner having Coordinates of X = 2,134,225.00 and Y = 127,591.99, said point also being on the South line of said Block 47, Ship Shoal Area; thence West 9,425.00 feet along said South line of said Block 47, Ship Shoal Area, to the point of beginning, containing approximately **2,223.09 acres**, all as more particularly outlined on a plat on file in the Office of Mineral Resources, Department of Natural Resources. All bearings, distances and coordinates are based on Louisiana Coordinate System of 1927, (North or South Zone).

NOTE: The above description of the Tract nominated for lease has been provided and corrected, where required, exclusively by the nomination party. Any mineral lease selected from this Tract and awarded by the Louisiana State Mineral and Energy Board shall be without warranty of any kind, either express, implied, or statutory, including, but not limited to, the implied warranties of merchantability and fitness for a particular purpose. Should the mineral lease awarded by the Louisiana State Mineral and Energy Board be subsequently modified, cancelled or abrogated due to the existence of conflicting leases, operating agreements, private claims or other future obligations or conditions which may affect all or any portion of the leased Tract, it shall not relieve the Lessee of the obligation to pay any bonus due thereon to the Louisiana State Mineral and Energy Board, nor shall the Louisiana State Mineral and Energy Board be obligated to refund any consideration paid by the Lessor prior to such modification, cancellation, or abrogation, including, but not limited to, bonuses, rentals and royalties.

NOTE: The State of Louisiana does hereby reserve, and this lease shall be subject to, the imprescriptible right of surface use in the nature of a servitude in favor of the Department of Natural Resources, including its Offices and Commissions, for the sole purpose of implementing, constructing, servicing and maintaining approved coastal zone management and/or restoration projects. Utilization of any and all rights derived under this lease by the mineral lessee, its agents, successors or assigns, shall not interfere with nor hinder the reasonable surface use by the Department of Natural Resources, its Offices or Commissions, as herein above reserved.

Applicant: ROBERT A. SCHROEDER, INC.

Bidder	Cash Payment	Price/ Acre	Rental	Oil	Gas	Other

Legend

19030035

Blocks

Active_Leases

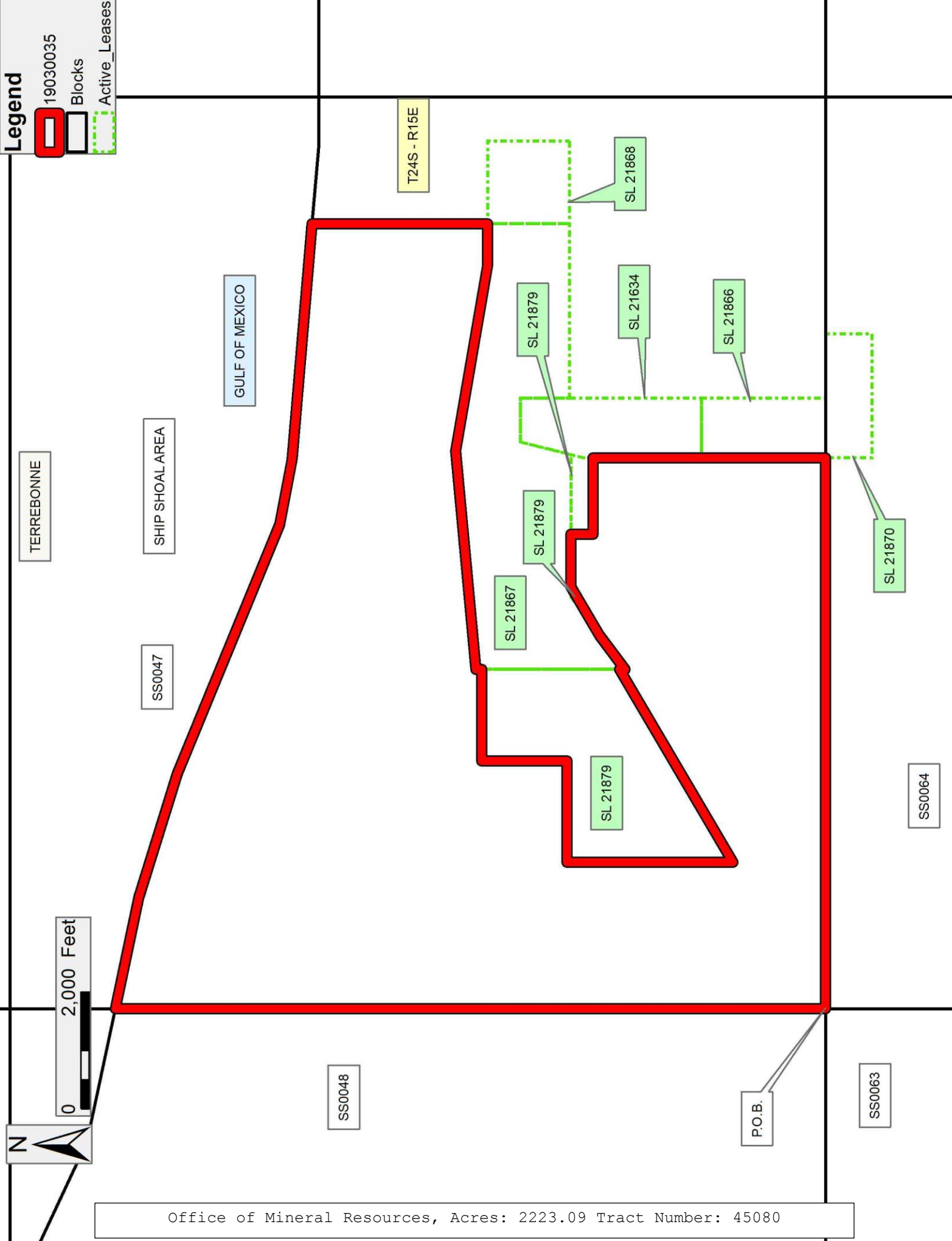

TRACT 45081 - Portion of Blocks 63, and 64, Ship Shoal Area, Terrebonne Parish, Louisiana

The beds and bottoms of all water bodies belonging to the State of Louisiana located in Blocks 63, and 64, Ship Shoal Area, together with any present lands formed by accretion to the shoreline or islands formed therein, located in Terrebonne Parish, Louisiana, owned by and not presently under mineral lease as of March 13, 2019, from the State of Louisiana, the geographical area of which is more fully described as follows: Beginning at the Northwest corner of 64, Ship Shoal Area, having Coordinates of X = 2,124,800.00 and Y = 127,591.99; thence East 1,950.00 feet along the North line of said Block 64, Ship Shoal Area, to a point having Coordinates of X = 2,126,750.00 and Y = 127,591.99; thence South 6,980.79 feet to a point having Coordinates of X = 2,126,750.00 and Y = 120,611.20, said point being the Northeast corner of State Lease No. 17669; thence West 1,916.21 feet along the Northern boundary of said State Lease No. 17669 to a point having Coordinates of X = 2,124,833.79 and Y = 120,611.20, said point being the Northwest corner of said State Lease No. 17669, said point also being on the Three Mile Line, as decreed by the Supreme Court of the United States, as determined by a Special Master appointed therein, in litigation styled *United States v. State of Louisiana et al No. 9 Original*, in 1975; thence along said Three Mile Line the following courses: Northwesterly along a straight line to a point having Coordinates of X = 2,122,637 and Y = 121,514, Northwesterly along a straight line to a point having Coordinates of X = 2,122,091 and Y = 121,684, Northwesterly along a straight line to a point having Coordinates of X = 2,118,740 and Y = 122,394, and Northwesterly on an arc having a radius of 18,240.60 feet and a center at X = 2,122,523 and Y = 140,238 to a point having Coordinates of X = 2,117,317.00 and Y = 122,756.01; thence North 4,835.98 feet to a point having Coordinates of X = 2,117,317.00 and Y = 127,591.99, said point being on the North line of said Block 63, Ship Shoal Area; thence East 7,483.00 feet along said North line of said Block 63, Ship Shoal Area, to the point of beginning, containing approximately **1,302.90 acres, LESS AND EXCEPT** that portion thereof, if any, lying seaward of the line three nautical miles from the coast line of Louisiana, as said three mile line has been decreed by the Supreme Court of the United States, as determined by a Special Master appointed therein, in litigation styled **United States v. State of Louisiana et al No. 9 Original**, in 1975, all as more particularly outlined on a plat in the Office of Mineral Resources, Department of Natural Resources. All bearings, distances and coordinates are based on the Louisiana Coordinate System of 1927, (South Zone).

NOTE: The above description of the Tract nominated for lease has been provided and corrected, where required, exclusively by the nomination party. Any mineral lease selected from this Tract and awarded by the Louisiana State Mineral and Energy Board shall be without warranty of any kind, either express, implied, or statutory, including, but not limited to, the implied warranties of merchantability and fitness for a particular purpose. Should the mineral lease awarded by the Louisiana State Mineral and Energy Board be subsequently modified, cancelled or abrogated due to the existence of conflicting leases, operating agreements, private claims or other future

obligations or conditions which may affect all or any portion of the leased Tract, it shall not relieve the Lessee of the obligation to pay any bonus due thereon to the Louisiana State Mineral and Energy Board, nor shall the Louisiana State Mineral and Energy Board be obligated to refund any consideration paid by the Lessor prior to such modification, cancellation, or abrogation, including, but not limited to, bonuses, rentals and royalties.

NOTE: The State of Louisiana does hereby reserve, and this lease shall be subject to, the imprescriptible right of surface use in the nature of a servitude in favor of the Department of Natural Resources, including its Offices and Commissions, for the sole purpose of implementing, constructing, servicing and maintaining approved coastal zone management and/or restoration projects. Utilization of any and all rights derived under this lease by the mineral lessee, its agents, successors or assigns, shall not interfere with nor hinder the reasonable surface use by the Department of Natural Resources, its Offices or Commissions, as herein above reserved.

NOTE: It appears, according to our records, that a portion of this Tract is located within the restrictive safety fairway area as set out by the Corps of Engineers, U.S. Army and/or the restrictive anchorage area as set out by the U.S. Coast Guard.

Applicant: ROBERT A. SCHROEDER, INC.

Bidder	Cash Payment	Price/ Acre	Rental	Oil	Gas	Other



Legend

19030037

Blocks

Active_Leases

Counties

