

TRACT 44661 - Portion of Block 67, Ship Shoal Area, Terrebonne Parish, Louisiana

The beds and bottoms of all water bodies belonging to the State of Louisiana located in Block 67, Ship Shoal Area, together with any present lands formed by accretion to the shoreline or islands formed therein, located in Terrebonne Parish, Louisiana, owned by and not presently under mineral lease as of March 8, 2017, from the State of Louisiana, the geographical area of which is more fully described as follows: Beginning at a point being the Northwest corner of Block 67, Ship Shoal area, having Coordinates of X = 2,171,599.99 and Y = 130,197.43; thence East 8,550.01 feet to the Southwest corner of State Lease No. 19558 as amended having Coordinates of X = 2,180,150.00 and Y = 130,197.44; thence East 2,017.42 feet along the south boundary of said State Lease No. 16558 to its Southeast corner having Coordinates of X = 2,182,167.42 and Y = 130,197.44; thence continue North 89 degrees 59 minutes 59 seconds East 4,286.99 feet to a point having Coordinates of X = 2,186,454.41 and Y = 130,197.45; thence South 00 degrees 17 minutes 29 seconds East 4,000.00 feet to the Northeast corner of Operating Agreement No. 0285 having Coordinates of X = 2,186,474.73 and Y = 126,197.50; thence along the boundaries of said Operating Agreement No. 0285 the following courses: West 1,700 feet to a point having Coordinates of X = 2,184,774.73 and Y = 126,197.50 and South 00 degrees 17 minutes 30 seconds East 2,561.08 feet to a point on its west boundary having Coordinates of X = 2,184,787.77 and Y = 123,636.45; thence West 4,787.50 feet to a point on the east boundary of State Lease No. 17309 having Coordinates of X = 2,180,000.27 and Y = 123,636.44; thence along the boundaries of said State Lease No. 17309 the following courses: North 03 degrees 15 minutes 07 seconds East 1,917.83 feet to a point having Coordinates of X = 2,180,109.06 and Y = 125,551.18, West 1,509.06 feet to a point having Coordinates of X = 2,178,600.00 and Y = 125,551.18, South 929.41 feet to a point having Coordinates of X = 2,178,600.00 and Y = 124,621.77 and South 28 degrees 47 minutes 12 seconds West 1,124.27 feet to a point on its west boundary having Coordinates of X = 2,178,058.61 and Y = 123,636.44; thence West 6,458.62 feet to a point having Coordinates of X = 2,171,599.99 and Y = 123,636.43; thence North 6,561.00 feet to the point of beginning, containing approximately **2,069.87 acres**, all as more particularly outlined on a plat on file in the Office of Mineral Resources, Department of Natural Resources. All bearings, distances and coordinates are based on Louisiana Coordinate System of 1927, (North or South Zone).

NOTE: The above description of the Tract nominated for the purpose of acquiring a mineral lease or a geophysical agreement has been provided and corrected, where required, exclusively by the nominating party. Any mineral lease or geophysical agreement selected from this Tract and awarded by the Louisiana State Mineral and Energy Board shall be without warranty of any kind, either express, implied or statutory including, but not limited to, title or the implied warranties of merchantability and fitness for a particular purpose.

An error or omission in the nominating party's Tract description may require that a State mineral lease or geophysical agreement be modified, canceled or abrogated due to the existence of conflicting leases, operating agreements, private claims or other future obligations or conditions within the Tract described. In such case, however, the Louisiana State Mineral and Energy Board shall not be obligated to refund any consideration paid by the Lessee prior to such modification, cancellation or abrogation including, but not limited to, bonuses, rentals and royalties.

NOTE: The State of Louisiana does hereby reserve, and this lease shall be subject to, the imprescriptible right of surface use in the nature of a servitude in favor of the Department of Natural Resources, including its Offices and Commissions, for the sole purpose of implementing, constructing, servicing and maintaining approved coastal zone management and/or restoration projects. Utilization of any and all rights derived under this lease by the mineral lessee, its agents, successors or assigns, shall not interfere with nor hinder the reasonable surface use by the Department of Natural Resources, its Offices or Commissions, as herein above reserved.

Applicant: GULFSTREAM RESOURCES LLC

Bidder	Cash Payment	Price/Acre	Rental	Oil	Gas	Other

Legend

- 17030007
- Blocks
- Active_Leases

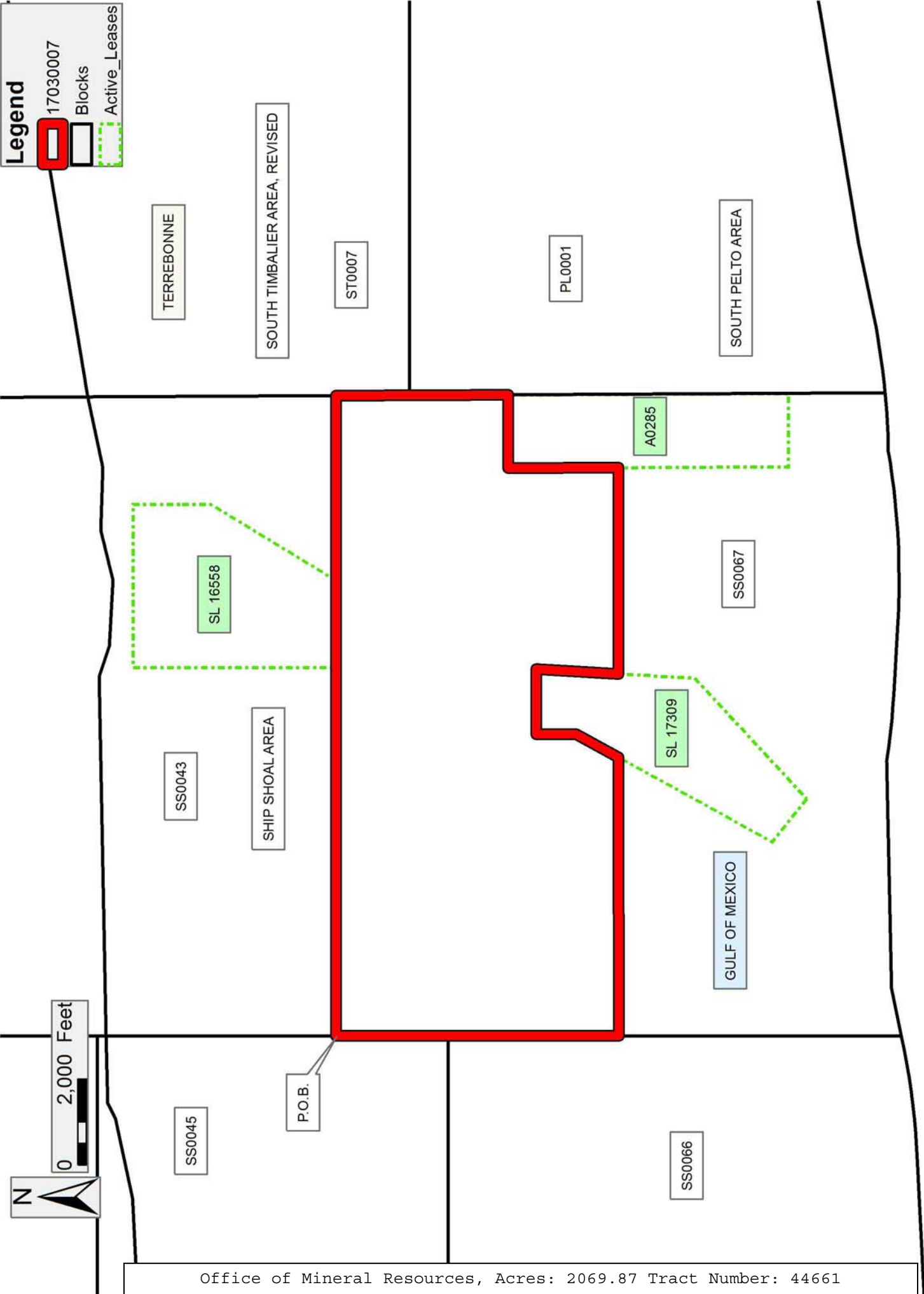

TRACT 44662 - Portion of Block 67, Ship Shoal Area, Terrebonne Parish, Louisiana

The beds and bottoms of all water bodies belonging to the State of Louisiana located in Block 67, Ship Shoal Area, together with any present lands formed by accretion to the shoreline or islands formed therein, located in Terrebonne Parish, Louisiana, owned by and not presently under mineral lease as of March 8, 2017, from the State of Louisiana, the geographical area of which is more fully described as follows: Beginning at a point on the West line of Block 67, Ship Shoal Area, having Coordinates of X = 2,171,600.00 and Y = 123,636.43; thence East 6,458.62 feet to a point on the west boundary of State Lease No. 17309 as amended having Coordinates of X = 2,178,058.61 and Y = 123,636.44; thence along the boundaries of said State Lease No. 17309 the following courses: South 28 degrees 47 minutes 12 seconds West 4,067.31 feet to a point having Coordinates of X = 2,176,100.00 and Y = 120,071.77, South 51 degrees 20 minutes 25 seconds East 1,280.63 feet to a point having Coordinates of X = 2,177,100.00 and Y = 119,271.77, North 47 degrees 07 minutes 16 seconds East 3,821.00 feet to a point having Coordinates of X = 2,179,900.00 and Y = 121,871.77 and North 03 degrees 15 minutes 07 seconds East 1,767.52 feet to a point on its east boundary having Coordinates of X = 2,180,000.27 and Y = 123,636.44; thence East 4,787.50 feet to a point on the west boundary of Operating Agreement No. 0285 having Coordinates of X = 2,184,787.77 and Y = 123,636.45; thence along the boundaries of said OA0285 the following courses: South 00 degrees 17 minutes 30 seconds East 3,939.06 feet to a point having Coordinates of X = 2,184,807.82 and Y = 119,697.44 and East 1,700.00 feet to its Southeast corner having Coordinates of X = 2,186,507.82 and Y = 119,697.44; thence South 2,245.97 feet to a point on the Three Mile Line, as decreed by the Supreme Court of the United States, as determined by a Special Master appointed therein, in litigation styled *United States v. State of Louisiana et al No. 9 Original*, in 1975, having Coordinates of X = 2,186,507.82 and Y = 117,451.47; thence along said Three Mile Line the following: Southwesterly along an arc to the right having a radius of 18,240.60 feet and a center of X = 2,184,788 and Y = 135,611 to a point having Coordinates of X = 2,185,156 and Y = 117,374, Southwesterly along an arc to the right having a radius of 18,240.60 feet and a center of X = 2,182,166 and Y = 135,368 to a point having Coordinates of X = 2,181,100 and Y = 117,159, Northwesterly along a straight line to a point having Coordinates of X = 2,179,579 and Y = 117,248, Northwesterly along an arc to the right having a radius of 18,240.60 feet and a center of X = 2,180,645 and Y = 135,457 to a point having Coordinates of X = 2,177,979 and Y = 117,412, Southwesterly along a straight line to a point having Coordinates of X = 2,172,700 and Y = 117,308, Southwesterly along a straight line to a point having Coordinates of X = 2,171,638 and Y = 117,082 and Southwesterly along an arc to the right having a radius of 18,240.60 feet and a center of X = 2,167,836 and Y = 134,922 to a point having Coordinates of X = 2,171,600.00 and Y = 117,073.94; thence North 6,562.49 feet to the point of beginning, containing approximately **1,808.28 acres, LESS AND EXCEPT** that portion thereof, if any, lying seaward of the line three nautical miles from the

coast line of Louisiana, as said three mile line has been decreed by the Supreme Court of the United States, as determined by a Special Master appointed therein, in litigation styled **United States v. State of Louisiana et al No. 9 Original**, in 1975, all as more particularly outlined on a plat in the Office of Mineral Resources, Department of Natural Resources. All bearings, distances and coordinates are based on the Louisiana Coordinate System of 1927, (South Zone).

NOTE: The above description of the Tract nominated for the purpose of acquiring a mineral lease or a geophysical agreement has been provided and corrected, where required, exclusively by the nominating party. Any mineral lease or geophysical agreement selected from this Tract and awarded by the Louisiana State Mineral and Energy Board shall be without warranty of any kind, either express, implied or statutory including, but not limited to, title or the implied warranties of merchantability and fitness for a particular purpose.

An error or omission in the nominating party's Tract description may require that a State mineral lease or geophysical agreement be modified, canceled or abrogated due to the existence of conflicting leases, operating agreements, private claims or other future obligations or conditions within the Tract described. In such case, however, the Louisiana State Mineral and Energy Board shall not be obligated to refund any consideration paid by the Lessee prior to such modification, cancellation or abrogation including, but not limited to, bonuses, rentals and royalties.

NOTE: The State of Louisiana does hereby reserve, and this lease shall be subject to, the imprescriptible right of surface use in the nature of a servitude in favor of the Department of Natural Resources, including its Offices and Commissions, for the sole purpose of implementing, constructing, servicing and maintaining approved coastal zone management and/or restoration projects. Utilization of any and all rights derived under this lease by the mineral lessee, its agents, successors or assigns, shall not interfere with nor hinder the reasonable surface use by the Department of Natural Resources, its Offices or Commissions, as herein above reserved.

Bidder	Cash Payment	Price/Acre	Rental	Oil	Gas	Other

Applicant: GULFSTREAM RESOURCES LLC



0 3,000 Feet

Legend

- 17030006 (Red outline)
- Blocks (Black outline)
- Active_Leases (Green dashed outline)

