

TRACT 41890 - Portion of Block 16, East Cameron Area, Revised, Cameron Parish, Louisiana

The beds and bottoms of all water bodies belonging to the State of Louisiana located in Block 16, East Cameron Area, Revised, together with any present lands formed by accretion to the shoreline or islands formed therein, located in Cameron Parish, Louisiana, owned by and not presently under mineral lease as of March 9, 2011, from the State of Louisiana, the geographical area of which is more fully described as follows: Beginning at the Northwest corner of Block 16, East Cameron Area, Revised having Coordinates of X = 1,524,274.14 and Y = 345,241.95; thence East 5,528.86 feet along the North line of said Block 16 to a point on the West boundary of State Lease No. 19888 having Coordinates of X = 1,529,803.00 and Y = 345,241.95; thence along the West, South and East boundaries of said State Lease No. 19888 the following courses and distances: South 2,490.95 feet to a corner having Coordinates of X = 1,529,803.00 and Y = 342,751.00, East 2,943.00 feet to a corner having Coordinates of X = 1,532,746.00 and Y = 342,751.00 and North 2,490.95 feet to a point on the North line of said Block 16 having Coordinates of X = 1,532,746.00 and Y = 345,241.95; thence East 6,286.19 feet along the North line of said Block 16 to its Northeast corner having Coordinates of X = 1,539,032.19 and Y = 345,241.95; thence South 11,173.85 feet along the East line of said Block 16 to a point on the Three Mile Line, as decreed by the Supreme Court of the United States, as determined by a Special Master appointed therein, in litigation styled *United States v. State of Louisiana et al No. 9 Original*, in 1975, having Coordinates of X = 1,539,032.19 and Y = 334,068.10; thence Northwesterly along an arc having a radius of 18,240.60 feet and a center located at X = 1,546,740 and Y = 350,600 to a point having Coordinates of X = 1,537,927 and Y = 334,630; thence Northwesterly along a straight line to a point having Coordinates of X = 1,531,757 and Y = 337,418; thence Northwesterly along an arc having a radius of 18,240.60 feet and a center located at X = 1,539,270 and Y = 354,040 to a point having Coordinates of X = 1,530,263 and Y = 338,178; thence Northwesterly along a straight line to a point having Coordinates of X = 1,527,498 and Y = 339,748; thence Northwesterly along an arc having a radius of 18,240.60 feet and a center located at X = 1,536,505 and Y = 355,610 to a point having Coordinates of X = 1,526,511 and Y = 340,351; thence Northwesterly along a straight line to a point having Coordinates of X = 1,526,495 and Y = 340,356; thence Northwesterly along an arc having a radius of 18,240.60 feet and a center located at X = 1,532,515 and Y = 357,575 to a point on the West line of said Block 16 having Coordinates of X = 1,524,274.14 and Y = 341,302.47; thence North 3,939.54 feet along the West line of said Block 16 to the point of beginning, containing approximately **2,414.37 acres, LESS AND EXCEPT** that portion thereof, if any, lying seaward of the line three nautical miles from the coast line of Louisiana, as said three mile line has been decreed by the Supreme Court of the United States, as determined by a Special Master appointed therein, in litigation styled **United States v. State of Louisiana et al No. 9 Original**, in 1975, all as more particularly outlined on a plat in the Office of Mineral Resources, Department of Natural Resources. All bearings, distances and coordinates are based on the Louisiana Coordinate System of 1927, (South Zone).

NOTE: The above description of the Tract nominated for lease has been provided and corrected, where required, exclusively by the nomination party. Any mineral lease selected from this Tract and awarded by the Louisiana State Mineral and Energy Board shall be without warranty of any kind, either express, implied, or statutory, including, but not limited to, the implied warranties of merchantability and fitness for a particular purpose. Should the mineral lease awarded by the Louisiana State Mineral and Energy Board be subsequently modified, cancelled or abrogated due to the existence of conflicting leases, operating agreements, private claims or other future obligations or conditions which may affect all or any portion of the leased Tract, it shall not relieve the Lessee of the obligation to pay any bonus due thereon to the Louisiana State Mineral and Energy Board, nor shall the Louisiana State Mineral and Energy Board be obligated to refund any consideration paid by the Lessor prior to such modification, cancellation, or abrogation, including, but not limited to, bonuses, rentals and royalties.

NOTE: The State of Louisiana does hereby reserve, and this lease shall be subject to, the imprescriptible right of surface use in the nature of a servitude in favor of the Department of Natural Resources, including its Offices and Commissions, for the sole purpose of implementing, constructing, servicing and maintaining approved coastal zone management and/or restoration projects. Utilization of any and all rights derived under this lease by the mineral lessee, its agents, successors or assigns, shall not interfere with nor hinder the reasonable surface use by the Department of Natural Resources, its Offices or Commissions, as herein above reserved.

Applicant: THEOPHILUS OIL, GAS & LAND SERVICES, LLC

Bidder	Cash Payment	Price/Acre	Rental	Oil	Gas	Other

Legend

- 11030151
- Blocks
- Active Leases

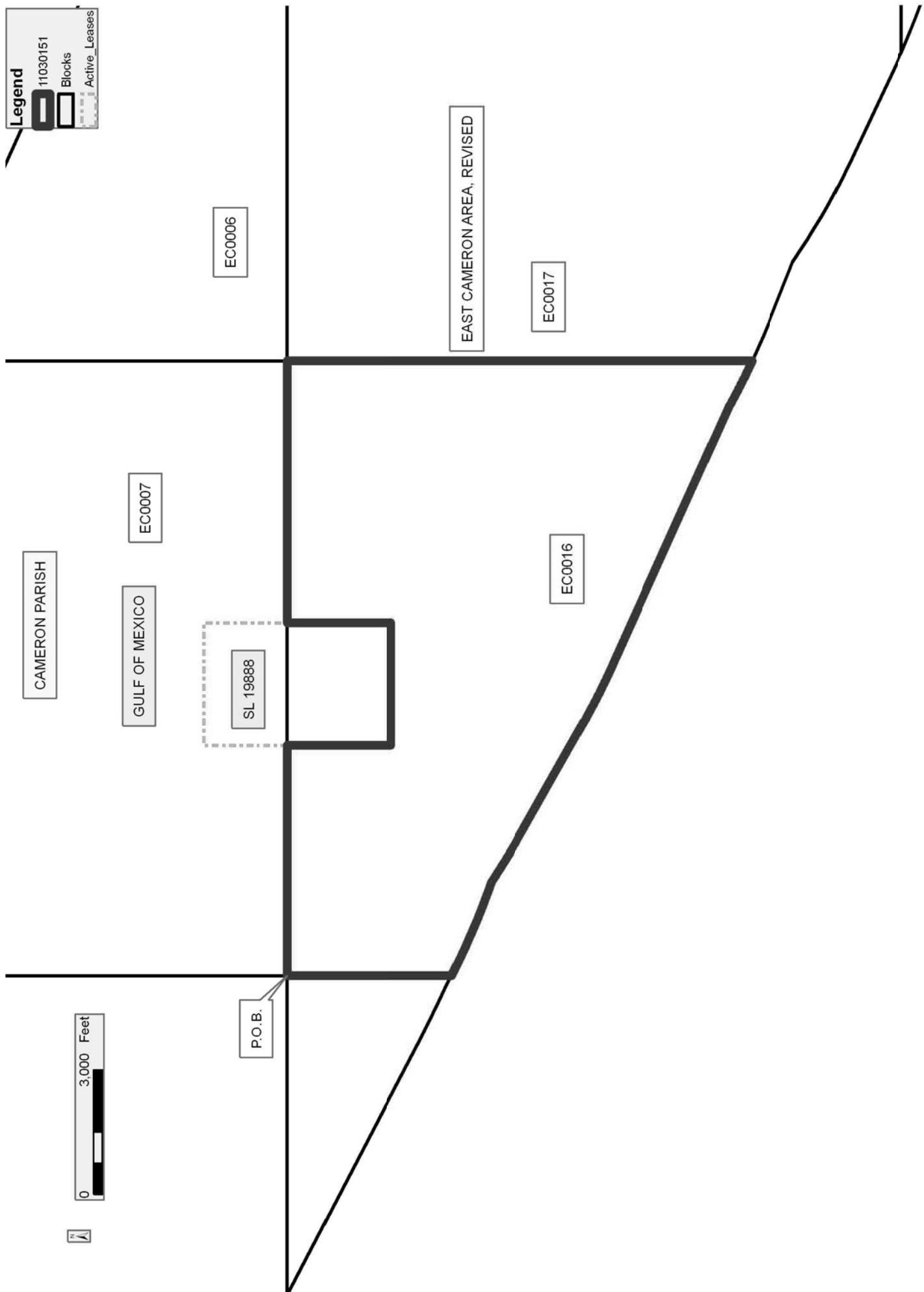

TRACT 41891 - Portion of Block 17, East Cameron Area, Revised, Cameron Parish, Louisiana

The beds and bottoms of all water bodies belonging to the State of Louisiana located in Block 17, East Cameron Area, Revised, together with any present lands formed by accretion to the shoreline or islands formed therein, located in Cameron Parish, Louisiana, owned by and not presently under mineral lease as of March 9, 2011, from the State of Louisiana, the geographical area of which is more fully described as follows: Beginning at the Northwest corner of Block 17, East Cameron Area, Revised having Coordinates of X = 1,539,032.19 and Y = 345,241.95; thence East 14,758.05 feet along the North line of said Block 17 to its Northeast corner having Coordinates of X = 1,553,790.24 and Y = 345,241.95; thence South 7,379.02 feet along the East line of said Block 17 to a point having Coordinates of X = 1,553,790.24 and Y = 337,862.93; thence West 14,758.05 feet to a point on the West line of said Block 17 having Coordinates of X = 1,539,032.19 and Y = 337,862.93; thence North 7,379.02 feet along the West line of said Block 17 to the point of beginning, containing approximately **2,500.00 acres**, all as more particularly outlined on a plat on file in the Office of Mineral Resources, Department of Natural Resources. All bearings, distances and coordinates are based on Louisiana Coordinate System of 1927, (North or South Zone).

NOTE: The above description of the Tract nominated for lease has been provided and corrected, where required, exclusively by the nomination party. Any mineral lease selected from this Tract and awarded by the Louisiana State Mineral and Energy Board shall be without warranty of any kind, either express, implied, or statutory, including, but not limited to, the implied warranties of merchantability and fitness for a particular purpose. Should the mineral lease awarded by the Louisiana State Mineral and Energy Board be subsequently modified, cancelled or abrogated due to the existence of conflicting leases, operating agreements, private claims or other future obligations or conditions which may affect all or any portion of the leased Tract, it shall not relieve the Lessee of the obligation to pay any bonus due thereon to the Louisiana State Mineral and Energy Board, nor shall the Louisiana State Mineral and Energy Board be obligated to refund any consideration paid by the Lessor prior to such modification, cancellation, or abrogation, including, but not limited to, bonuses, rentals and royalties.

NOTE: The State of Louisiana does hereby reserve, and this lease shall be subject to, the imprescriptible right of surface use in the nature of a servitude in favor of the Department of Natural Resources, including its Offices and Commissions, for the sole purpose of implementing, constructing, servicing and maintaining approved coastal zone management and/or restoration projects. Utilization of any and all rights derived under this lease by the mineral lessee, its agents, successors or assigns, shall not interfere with nor hinder the reasonable surface use by the Department of Natural Resources, its Offices or Commissions, as herein above reserved.

Applicant: THEOPHILUS OIL, GAS & LAND SERVICES, LLC

Bidder	Cash Payment	Price/Acre	Rental	Oil	Gas	Other

Legend
11030152
Blocks

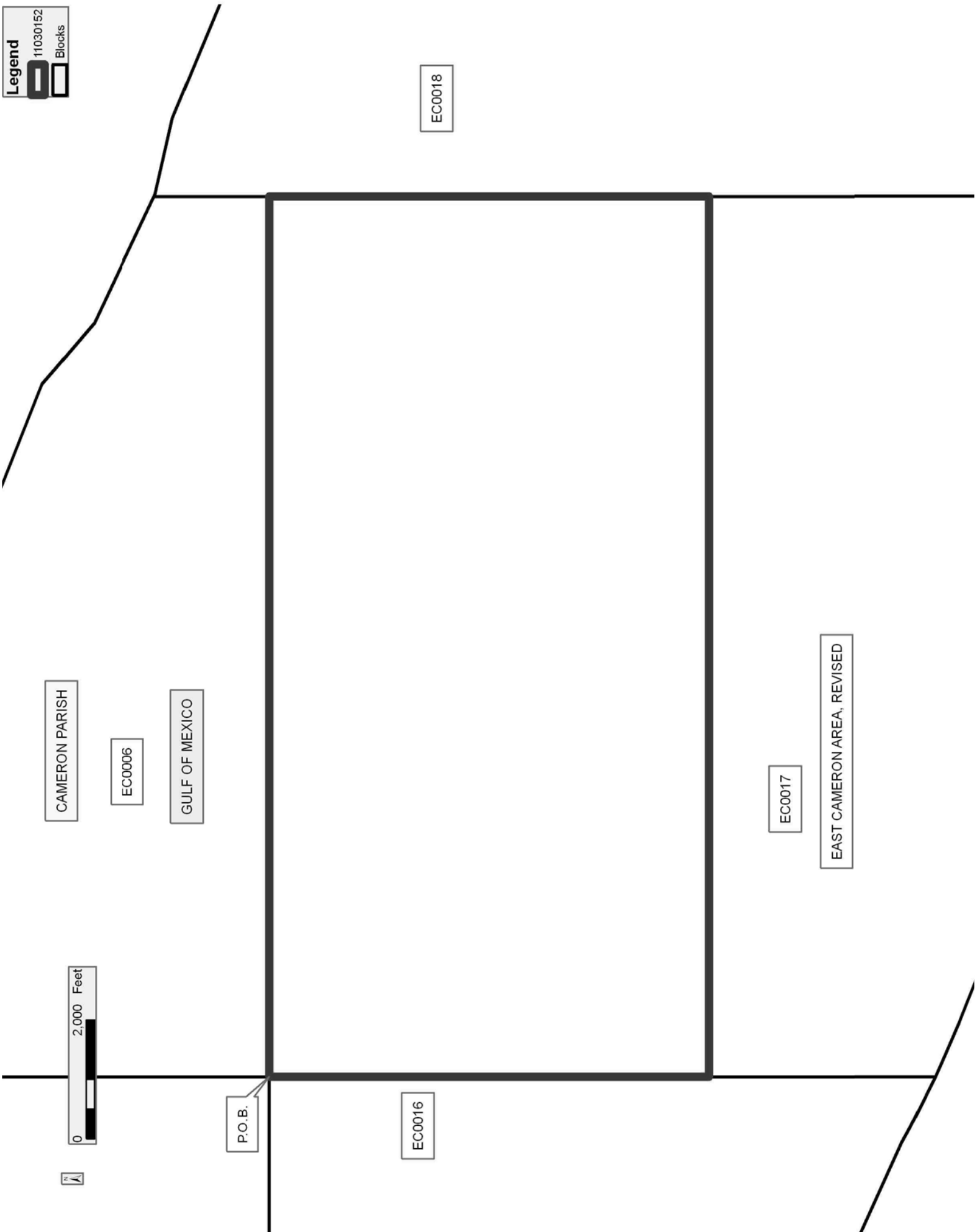

TRACT 41892 - Portion of Block 18, East Cameron Area, Revised, Cameron Parish, Louisiana

The beds and bottoms of all water bodies belonging to the State of Louisiana located in Block 18, East Cameron Area, Revised, together with any present lands formed by accretion to the shoreline or islands formed therein, located in Cameron Parish, Louisiana, owned by and not presently under mineral lease as of March 9, 2011, from the State of Louisiana, the geographical area of which is more fully described as follows: Beginning at point on the West line of Block 18, East Cameron Area, Revised, having Coordinates of X = 1,553,790.24 and Y = 337,205.80; thence North approximately 8,187 feet along the West line of said Block 18 to a point on the South boundary of the Rockefeller Wildlife Refuge having a Coordinate of X = 1,553,790.24; thence Southeasterly along the meanders of the said South boundary to a point on the East line of said Block 18 having a Coordinate of X = 1,568,548.29; thence South approximately 3,089 feet along the East line of said Block 18 to a point having Coordinates of X = 1,568,548.29 and Y = 337,205.80; thence West 14,758.05 feet to the point of beginning, **LESS AND EXCEPT** that portion, if any, of the above described tract which may lie within the boundary of the Rockefeller Wildlife Refuge; the above described tract containing approximately **1,866 acres**, all as more particularly outlined on a plat on file in the Office of Mineral Resources, Department of Natural Resources. All bearings, distances and coordinates are based on Louisiana Coordinate System of 1927, (North or South Zone).

NOTE: The above description of the Tract nominated for lease has been provided and corrected, where required, exclusively by the nomination party. Any mineral lease selected from this Tract and awarded by the Louisiana State Mineral and Energy Board shall be without warranty of any kind, either express, implied, or statutory, including, but not limited to, the implied warranties of merchantability and fitness for a particular purpose. Should the mineral lease awarded by the Louisiana State Mineral and Energy Board be subsequently modified, cancelled or abrogated due to the existence of conflicting leases, operating agreements, private claims or other future obligations or conditions which may affect all or any portion of the leased Tract, it shall not relieve the Lessee of the obligation to pay any bonus due thereon to the Louisiana State Mineral and Energy Board, nor shall the Louisiana State Mineral and Energy Board be obligated to refund any consideration paid by the Lessor prior to such modification, cancellation, or abrogation, including, but not limited to, bonuses, rentals and royalties.

NOTE: The State of Louisiana does hereby reserve, and this lease shall be subject to, the imprescriptible right of surface use in the nature of a servitude in favor of the Department of Natural Resources, including its Offices and Commissions, for the sole purpose of implementing, constructing, servicing and maintaining approved coastal zone management and/or restoration projects. Utilization of any and all rights derived under this lease by the mineral lessee, its agents, successors or assigns,

shall not interfere with nor hinder the reasonable surface use by the Department of Natural Resources, its Offices or Commissions, as herein above reserved.

Applicant: THEOPHILUS OIL, GAS & LAND SERVICES, LLC

Bidder	Cash Payment	Price/Acre	Rental	Oil	Gas	Other

Legend

11030137

Wildlife

Blocks

CAMERON PARISH

ROCKEFELLER WILDLIFE REFUGE

EC0019

GULF OF MEXICO

EC0018

EAST CAMERON AREA, REVISED

P.O.B.

EC0017



TRACT 41893 - Portion of Block 19, East Cameron Area, Revised, Cameron Parish, Louisiana

The beds and bottoms of all water bodies belonging to the State of Louisiana located in Block 19, East Cameron Area, Revised, together with any present lands formed by accretion to the shoreline or islands formed therein, located in Cameron Parish, Louisiana, owned by and not presently under mineral lease as of March 9, 2011, from the State of Louisiana, the geographical area of which is more fully described as follows: Beginning at point on the West line of Block 19, East Cameron Area, Revised, having Coordinates of X = 1,568,548.29 and Y = 331,436.48; thence North approximately 8,859 feet along the West line of said Block 19 to a point on the South boundary of the Rockefeller Wildlife Refuge having a Coordinate of X = 1,568,548.29; thence Southeasterly along the meanders of said South boundary to a point on the East line of said Block 19 having a Coordinate of X = 1,583,306.34; thence South approximately 4,640 feet along the East line of said Block 19 to a point having Coordinates of X = 1,583,306.34 and Y = 331,436.48; thence West 14,758.05 feet to the point of beginning, **LESS AND EXCEPT** that portion, if any, of the above described tract which may lie within the boundary of the Rockefeller Wildlife Refuge; the above described tract containing approximately **2,326 acres**, all as more particularly outlined on a plat on file in the Office of Mineral Resources, Department of Natural Resources. All bearings, distances and coordinates are based on Louisiana Coordinate System of 1927, (North or South Zone).

NOTE: The above description of the Tract nominated for lease has been provided and corrected, where required, exclusively by the nomination party. Any mineral lease selected from this Tract and awarded by the Louisiana State Mineral and Energy Board shall be without warranty of any kind, either express, implied, or statutory, including, but not limited to, the implied warranties of merchantability and fitness for a particular purpose. Should the mineral lease awarded by the Louisiana State Mineral and Energy Board be subsequently modified, cancelled or abrogated due to the existence of conflicting leases, operating agreements, private claims or other future obligations or conditions which may affect all or any portion of the leased Tract, it shall not relieve the Lessee of the obligation to pay any bonus due thereon to the Louisiana State Mineral and Energy Board, nor shall the Louisiana State Mineral and Energy Board be obligated to refund any consideration paid by the Lessor prior to such modification, cancellation, or abrogation, including, but not limited to, bonuses, rentals and royalties.

NOTE: The State of Louisiana does hereby reserve, and this lease shall be subject to, the imprescriptible right of surface use in the nature of a servitude in favor of the Department of Natural Resources, including its Offices and Commissions, for the sole purpose of implementing, constructing, servicing and maintaining approved coastal zone management and/or restoration projects. Utilization of any and all rights derived under this lease by the mineral lessee, its agents, successors or assigns,

shall not interfere with nor hinder the reasonable surface use by the Department of Natural Resources, its Offices or Commissions, as herein above reserved.

Applicant: THEOPHILUS OIL, GAS & LAND SERVICES, LLC

Bidder	Cash Payment	Price/Acre	Rental	Oil	Gas	Other

Legend

- 11030138
- Wildlife
- Blocks

CAMERON PARISH
 ROCKEFELLER WILDLIFE REFUGE



EC0020

EC0019

GULF OF MEXICO

EAST CAMERON AREA, REVISED

EC0021

P.O.B.

EC0018

EC0022

TRACT 41894 - Portion of Blocks 17, and 23, East Cameron Area, Revised, Cameron Parish, Louisiana

The beds and bottoms of all water bodies belonging to the State of Louisiana located in Blocks 17, and 23, East Cameron Area, Revised, together with any present lands formed by accretion to the shoreline or islands formed therein, located in Cameron Parish, Louisiana, owned by and not presently under mineral lease as of March 9, 2011, from the State of Louisiana, the geographical area of which is more fully described as follows: Beginning at a point on the West line of Block 17, East Cameron Area, Revised having Coordinates of X = 1,539,032.19 and Y = 337,862.93; thence East 14,758.05 feet to a point on the East line of said Block 17 having Coordinates of X = 1,553,790.24 and Y = 337,862.93; thence South 7,379.03 feet along the East line of said Block 17 to its Southeast corner, also being the Northeast corner of Block 23 having Coordinates of X = 1,553,790.24 and Y = 330,483.90; thence South 2673.07 feet along the East line of said Block 23 to a point on the Three Mile Line, as decreed by the Supreme Court of the United States, as determined by a Special Master appointed therein, in litigation styled *United States v. State of Louisiana et al No. 9 Original*, in 1975, having Coordinates of X = 1,553,790.24 and Y = 327,810.83; thence Northwesterly on a straight line to a point having Coordinates of X = 1,553,511 and Y = 327,894; thence Northwesterly along an arc having a radius of 18,240.60 feet and a center located at X = 1,558,720 and Y = 345,375 to a point having Coordinates of X = 1,551,769 and Y = 328,511; thence Northwesterly along a straight line to a point having Coordinates of X = 1,549,575 and Y = 329,415; thence Northwesterly along an arc having a radius of 18,240.60 feet and a center located at X = 1,553,840 and Y = 347,150 to a point having Coordinates of X = 1,546,081 and Y = 330,642; thence Northwesterly along a straight line to a point having Coordinates of X = 1,543,911 and Y = 331,662; thence Northwesterly along an arc having a radius of 18,240.60 feet and a center located at X = 1,551,670 and Y = 348,170 to a point having Coordinates of X = 1,541,402 and Y = 333,094; thence Northwesterly along a straight line to a point having Coordinates of X = 1,540,011 and Y = 333,646; thence Northwesterly along an arc having a radius of 18,240.60 feet and a center located at X = 1,546,740 and Y = 350,600 to a point on the West line of said Block 17 having Coordinates of X = 1,539,032.19 and Y = 334,068.10; thence North 3,794.83 feet along the West line of said Block 17 to the point of beginning, containing approximately **2,419.57 acres, LESS AND EXCEPT** that portion thereof, if any, lying seaward of the line three nautical miles from the coast line of Louisiana, as said three mile line has been decreed by the Supreme Court of the United States, as determined by a Special Master appointed therein, in litigation styled **United States v. State of Louisiana et al No. 9 Original**, in 1975, all as more particularly outlined on a plat in the Office of Mineral Resources, Department of Natural Resources. All bearings, distances and coordinates are based on the Louisiana Coordinate System of 1927, (South Zone).

NOTE: The above description of the Tract nominated for lease has been provided and corrected, where required, exclusively by the nomination

party. Any mineral lease selected from this Tract and awarded by the Louisiana State Mineral and Energy Board shall be without warranty of any kind, either express, implied, or statutory, including, but not limited to, the implied warranties of merchantability and fitness for a particular purpose. Should the mineral lease awarded by the Louisiana State Mineral and Energy Board be subsequently modified, cancelled or abrogated due to the existence of conflicting leases, operating agreements, private claims or other future obligations or conditions which may affect all or any portion of the leased Tract, it shall not relieve the Lessee of the obligation to pay any bonus due thereon to the Louisiana State Mineral and Energy Board, nor shall the Louisiana State Mineral and Energy Board be obligated to refund any consideration paid by the Lessor prior to such modification, cancellation, or abrogation, including, but not limited to, bonuses, rentals and royalties.

NOTE: The State of Louisiana does hereby reserve, and this lease shall be subject to, the imprescriptible right of surface use in the nature of a servitude in favor of the Department of Natural Resources, including its Offices and Commissions, for the sole purpose of implementing, constructing, servicing and maintaining approved coastal zone management and/or restoration projects. Utilization of any and all rights derived under this lease by the mineral lessee, its agents, successors or assigns, shall not interfere with nor hinder the reasonable surface use by the Department of Natural Resources, its Offices or Commissions, as herein above reserved.

Applicant: THEOPHILUS OIL, GAS & LAND SERVICES, LLC

Bidder	Cash Payment	Price/Acre	Rental	Oil	Gas	Other

Legend
11030153
Blocks

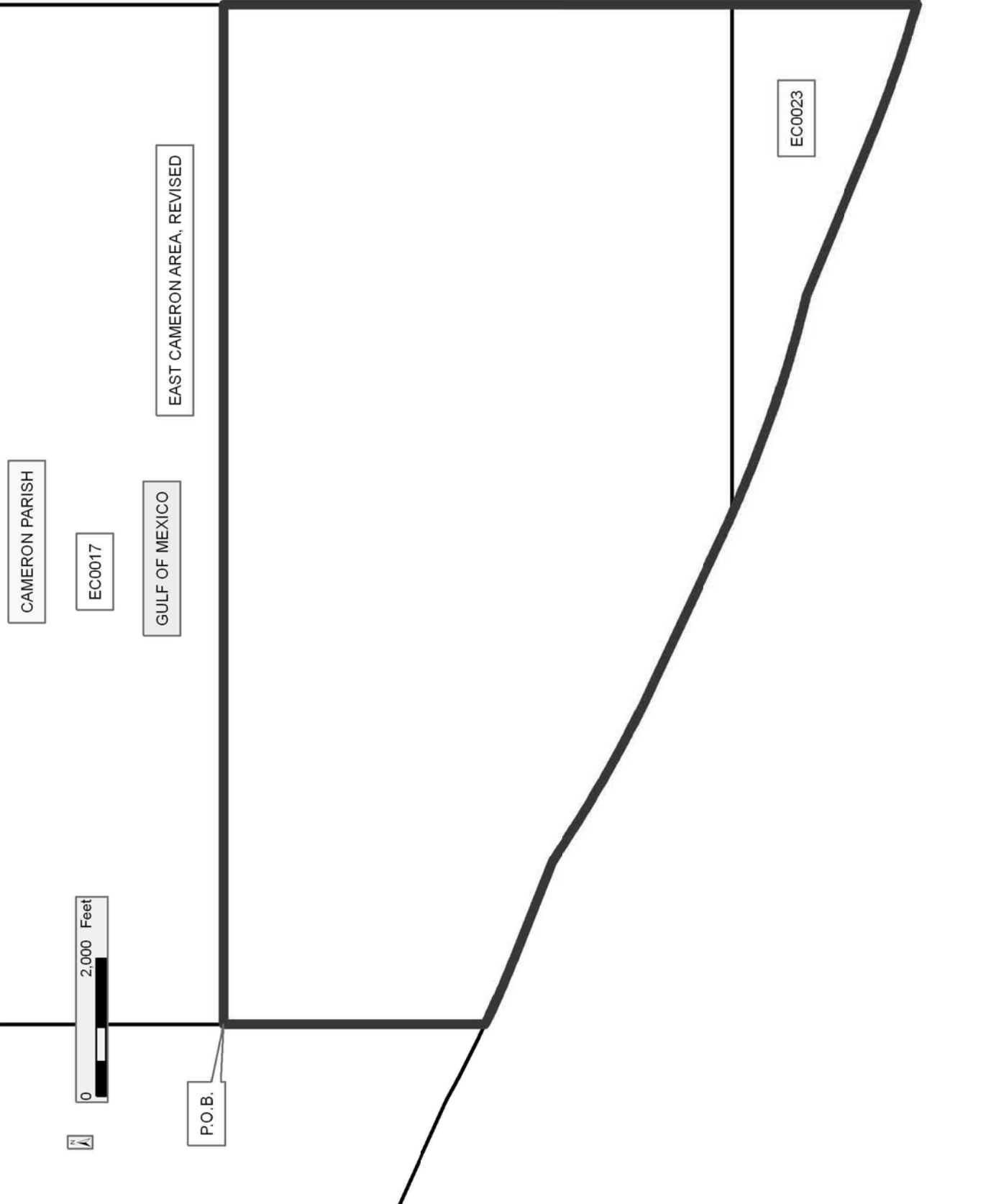

TRACT 41895 - Portion of Block 18, East Cameron Area, Revised, Cameron Parish, Louisiana

The beds and bottoms of all water bodies belonging to the State of Louisiana located in Block 18, East Cameron Area, Revised, together with any present lands formed by accretion to the shoreline or islands formed therein, located in Cameron Parish, Louisiana, owned by and not presently under mineral lease as of March 9, 2011, from the State of Louisiana, the geographical area of which is more fully described as follows: Beginning at a point on the West line of Block 18, East Cameron Area, Revised having Coordinates of X = 1,553,790.24 and Y = 337,205.80; thence East 14,758.05 feet to a point on the East line of said Block 18 having Coordinates of X = 1,568,548.29 and Y = 337,205.80; thence South 6,721.90 feet along the East line of said Block 18 to its Southeast corner having Coordinates of X = 1,568,548.29 and Y = 330,483.90; thence West 14,758.05 feet along the South line of said Block 18 to its Southwest corner having Coordinates of X = 1,553,790.24 and Y = 330,483.90; thence North 6,721.90 feet along the West line of said Block 18 to the point of beginning, containing approximately **2,277.37 acres**, all as more particularly outlined on a plat on file in the Office of Mineral Resources, Department of Natural Resources. All bearings, distances and coordinates are based on Louisiana Coordinate System of 1927, (North or South Zone).

NOTE: The above description of the Tract nominated for lease has been provided and corrected, where required, exclusively by the nomination party. Any mineral lease selected from this Tract and awarded by the Louisiana State Mineral and Energy Board shall be without warranty of any kind, either express, implied, or statutory, including, but not limited to, the implied warranties of merchantability and fitness for a particular purpose. Should the mineral lease awarded by the Louisiana State Mineral and Energy Board be subsequently modified, cancelled or abrogated due to the existence of conflicting leases, operating agreements, private claims or other future obligations or conditions which may affect all or any portion of the leased Tract, it shall not relieve the Lessee of the obligation to pay any bonus due thereon to the Louisiana State Mineral and Energy Board, nor shall the Louisiana State Mineral and Energy Board be obligated to refund any consideration paid by the Lessor prior to such modification, cancellation, or abrogation, including, but not limited to, bonuses, rentals and royalties.

NOTE: The State of Louisiana does hereby reserve, and this lease shall be subject to, the imprescriptible right of surface use in the nature of a servitude in favor of the Department of Natural Resources, including its Offices and Commissions, for the sole purpose of implementing, constructing, servicing and maintaining approved coastal zone management and/or restoration projects. Utilization of any and all rights derived under this lease by the mineral lessee, its agents, successors or assigns, shall not interfere with nor hinder the reasonable surface use by the Department of Natural Resources, its Offices or Commissions, as herein above reserved.

Applicant: THEOPHILUS OIL, GAS & LAND SERVICES, LLC

Bidder	Cash Payment	Price/Acre	Rental	Oil	Gas	Other

Legend
11030154
Blocks

EC0019

CAMERON PARISH

GULF OF MEXICO

EC0018

EAST CAMERON AREA, REVISED

EC0022



P.O.B.

EC0017

TRACT 41896 - Portion of Block 20, East Cameron Area, Revised, Cameron Parish, Louisiana

The beds and bottoms of all water bodies belonging to the State of Louisiana located in Block 20, East Cameron Area, Revised, together with any present lands formed by accretion to the shoreline or islands formed therein, located in Cameron Parish, Louisiana, owned by and not presently under mineral lease as of March 9, 2011, from the State of Louisiana, the geographical area of which is more fully described as follows: Beginning at point on the West line of Block 20, East Cameron Area, Revised, having Coordinates of X = 1,583,306.34 and Y = 330,042.90; thence North approximately 6,033 feet along the West line of said Block 20 to a point on the South boundary of the Rockefeller Wildlife Refuge having a Coordinate of X = 1,583,306.34; thence Southeasterly along the Southern boundary of said Rockefeller Wildlife Refuge to a point of intersection with the Louisiana Coastline, as decreed by the Supreme Court of the United States, as determined by a Special Master appointed therein, in litigation styled *United States v. State of Louisiana et al No. 9 Original*, in 1975; thence along the said Louisiana Coastline the following: Southeasterly on a straight line to a point having Coordinates of X = 1,586,780 and Y = 335,220; Southeasterly on a straight line to a point having Coordinates of X = 1,589,460 and Y = 334,525 and Southeasterly on a straight line to a point on the Southern boundary of said Rockefeller Wildlife Refuge; thence Southerly and Easterly along the Southern boundary of said Rockefeller Wildlife Refuge to a point of intersection with the East line of said Block 20; thence South 00 degrees 38 minutes 35 seconds West approximately 1,587 feet along the East line of said Block 20 to a point having Coordinates of X = 1,591,279.83 and Y = 330,042.90; thence West 7,973.49 feet to the point of beginning, **LESS AND EXCEPT** that portion, if any, of the above described tract which may lie within the boundary of the Rockefeller Wildlife Refuge; the above described tract containing approximately **919 acres**, all as more particularly outlined on a plat on file in the Office of Mineral Resources, Department of Natural Resources. All bearings, distances and coordinates are based on Louisiana Coordinate System of 1927, (North or South Zone).

NOTE: The above description of the Tract nominated for lease has been provided and corrected, where required, exclusively by the nomination party. Any mineral lease selected from this Tract and awarded by the Louisiana State Mineral and Energy Board shall be without warranty of any kind, either express, implied, or statutory, including, but not limited to, the implied warranties of merchantability and fitness for a particular purpose. Should the mineral lease awarded by the Louisiana State Mineral and Energy Board be subsequently modified, cancelled or abrogated due to the existence of conflicting leases, operating agreements, private claims or other future obligations or conditions which may affect all or any portion of the leased Tract, it shall not relieve the Lessee of the obligation to pay any bonus due thereon to the Louisiana State Mineral and Energy Board, nor shall the Louisiana State Mineral and Energy Board be

obligated to refund any consideration paid by the Lessor prior to such modification, cancellation, or abrogation, including, but not limited to, bonuses, rentals and royalties.

NOTE: The State of Louisiana does hereby reserve, and this lease shall be subject to, the imprescriptible right of surface use in the nature of a servitude in favor of the Department of Natural Resources, including its Offices and Commissions, for the sole purpose of implementing, constructing, servicing and maintaining approved coastal zone management and/or restoration projects. Utilization of any and all rights derived under this lease by the mineral lessee, its agents, successors or assigns, shall not interfere with nor hinder the reasonable surface use by the Department of Natural Resources, its Offices or Commissions, as herein above reserved.

Applicant: THEOPHILUS OIL, GAS & LAND SERVICES, LLC

Bidder	Cash Payment	Price/Acre	Rental	Oil	Gas	Other

Legend

- 11030139
- Wildlife
- Blocks

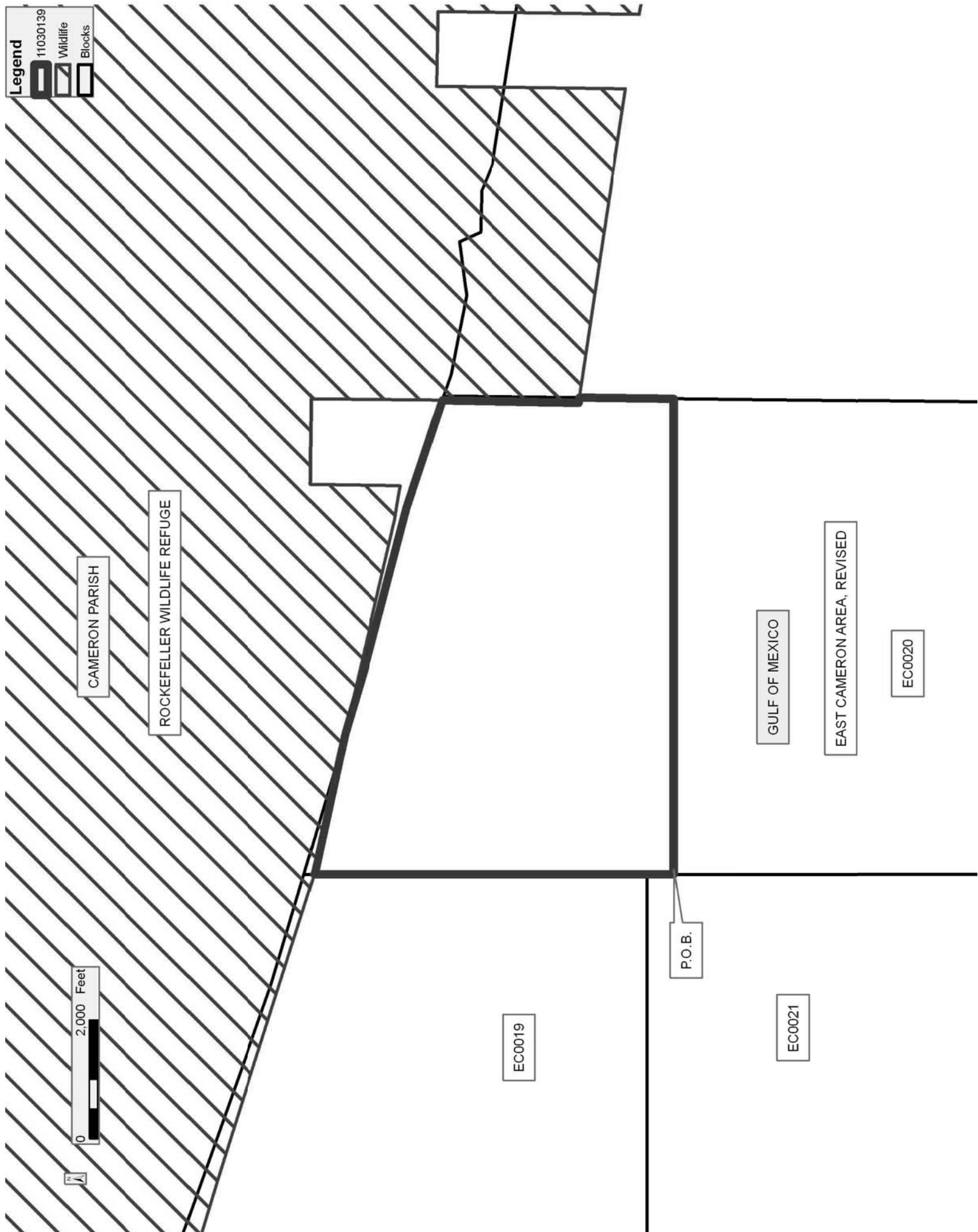

TRACT 41897 - Portion of Blocks 19, and 21, East Cameron Area, Revised, Cameron Parish, Louisiana

The beds and bottoms of all water bodies belonging to the State of Louisiana located in Blocks 19, and 21, East Cameron Area, Revised, together with any present lands formed by accretion to the shoreline or islands formed therein, located in Cameron Parish, Louisiana, owned by and not presently under mineral lease as of March 9, 2011, from the State of Louisiana, the geographical area of which is more fully described as follows: Beginning at a point on the West line of Block 19, East Cameron Area, Revised having Coordinates of X = 1,568,548.29 and Y = 331,436.48; thence East 14,758.05 feet to a point on the East line of said Block 19 having Coordinates of X = 1,583,306.34 and Y = 331,436.48; thence South 952.58 feet along the East line of said Block 19 to its Southeast corner, also being the Northeast corner of Block 21, East Cameron Area, Revised, having Coordinates of X = 1,583,306.34 and Y = 330,483.90; thence South 6,426.44 feet along the East line of said Block 21 to a point having Coordinates of X = 1,583,306.34 and Y = 324,057.46; thence West 14,758.05 feet to a point on the West line of said Block 21 having Coordinates of X = 1,568,548.29 and Y = 324,057.46; thence North 6,426.44 feet along the West line of said Block 21 to its Northwest corner, also being the Southwest corner of said Block 19 having Coordinates of X = 1,568,548.29 and Y = 330,483.90; thence North 952.58 feet along the West line of said Block 19 to the point of beginning, containing approximately **2,500.00 acres**, all as more particularly outlined on a plat on file in the Office of Mineral Resources, Department of Natural Resources. All bearings, distances and coordinates are based on Louisiana Coordinate System of 1927, (North or South Zone).

NOTE: The above description of the Tract nominated for lease has been provided and corrected, where required, exclusively by the nomination party. Any mineral lease selected from this Tract and awarded by the Louisiana State Mineral and Energy Board shall be without warranty of any kind, either express, implied, or statutory, including, but not limited to, the implied warranties of merchantability and fitness for a particular purpose. Should the mineral lease awarded by the Louisiana State Mineral and Energy Board be subsequently modified, cancelled or abrogated due to the existence of conflicting leases, operating agreements, private claims or other future obligations or conditions which may affect all or any portion of the leased Tract, it shall not relieve the Lessee of the obligation to pay any bonus due thereon to the Louisiana State Mineral and Energy Board, nor shall the Louisiana State Mineral and Energy Board be obligated to refund any consideration paid by the Lessor prior to such modification, cancellation, or abrogation, including, but not limited to, bonuses, rentals and royalties.

NOTE: The State of Louisiana does hereby reserve, and this lease shall be subject to, the imprescriptible right of surface use in the nature of a servitude in favor of the Department of Natural Resources, including its Offices and Commissions, for the sole purpose of implementing,

constructing, servicing and maintaining approved coastal zone management and/or restoration projects. Utilization of any and all rights derived under this lease by the mineral lessee, its agents, successors or assigns, shall not interfere with nor hinder the reasonable surface use by the Department of Natural Resources, its Offices or Commissions, as herein above reserved.

Applicant: THEOPHILUS OIL, GAS & LAND SERVICES, LLC

Bidder	Cash Payment	Price/Acre	Rental	Oil	Gas	Other

Legend

11030156*
Blocks

CAMERON PARISH

EAST CAMERON AREA, REVISED

GULF OF MEXICO

EC0019

EC0021



P.O.B.

TRACT 41898 - Portion of Block 22, East Cameron Area, Revised, Cameron Parish, Louisiana

The beds and bottoms of all water bodies belonging to the State of Louisiana located in Block 22, East Cameron Area, Revised, together with any present lands formed by accretion to the shoreline or islands formed therein, located in Cameron Parish, Louisiana, owned by and not presently under mineral lease as of March 9, 2011, from the State of Louisiana, the geographical area of which is more fully described as follows: Beginning at the Northwest corner of Block 22, East Cameron Area, Revised having Coordinates of X = 1,553,790.24 and Y = 330,483.90; thence East 14,758.05 feet along the North line of said Block 22 to its Northeast corner having Coordinates of X = 1,568,548.29 and Y = 330,483.90; thence South 8,447.21 feet along the East line of said Block 22 to a point on the Three Mile Line, as decreed by the Supreme Court of the United States, as determined by a Special Master appointed therein, in litigation styled *United States v. State of Louisiana et al No. 9 Original*, in 1975, having Coordinates of X = 1,568,548.29 and Y = 322,036.69; thence Northwesterly on a straight line to a point having Coordinates of X = 1,565,349 and Y = 323,210; thence Northwesterly along an arc having a radius of 18240.60 feet with a center located at X = 1,571,630 and Y = 340,335 to a point having Coordinates of X = 1,563,529 and Y = 323,992; thence Northwesterly along a straight line to a point having Coordinates of X = 1,563,104 and Y = 324,202; thence Northwesterly along a straight line to a point having Coordinates of X = 1,561,073 and Y = 324,994; thence Northwesterly along an arc having a radius of 18240.60 feet with a center located at X = 1,567,695 and Y = 341,990 to a point having Coordinates of X = 1,558,882 and Y = 326,020; thence Northwesterly along a straight line to a point having Coordinates of X = 1,558,879 and Y = 326,021; thence Northwesterly along an arc having a radius of 18,240.60 feet with a center located at X = 1,564,160 and Y = 343,480 to a point having Coordinates of X = 1,556,225 and Y = 327,056; thence Northwesterly along a straight line to a point having Coordinates of X = 1,556,066 and Y = 327,133; thence Northwesterly along a straight line to a point on the West line of said Block 22 having Coordinates of X = 1,553,790.24 and Y = 327,810.83; thence North 2,673.07 feet along the West line of said Block 22 to the point of beginning, containing approximately **1,867.13 acres, LESS AND EXCEPT** that portion thereof, if any, lying seaward of the line three nautical miles from the coast line of Louisiana, as said three mile line has been decreed by the Supreme Court of the United States, as determined by a Special Master appointed therein, in litigation styled **United States v. State of Louisiana et al No. 9 Original**, in 1975, all as more particularly outlined on a plat in the Office of Mineral Resources, Department of Natural Resources. All bearings, distances and coordinates are based on the Louisiana Coordinate System of 1927, (South Zone).

NOTE: The above description of the Tract nominated for lease has been provided and corrected, where required, exclusively by the nomination party. Any mineral lease selected from this Tract and awarded by the Louisiana State Mineral and Energy Board shall be without warranty of any

kind, either express, implied, or statutory, including, but not limited to, the implied warranties of merchantability and fitness for a particular purpose. Should the mineral lease awarded by the Louisiana State Mineral and Energy Board be subsequently modified, cancelled or abrogated due to the existence of conflicting leases, operating agreements, private claims or other future obligations or conditions which may affect all or any portion of the leased Tract, it shall not relieve the Lessee of the obligation to pay any bonus due thereon to the Louisiana State Mineral and Energy Board, nor shall the Louisiana State Mineral and Energy Board be obligated to refund any consideration paid by the Lessor prior to such modification, cancellation, or abrogation, including, but not limited to, bonuses, rentals and royalties.

NOTE: The State of Louisiana does hereby reserve, and this lease shall be subject to, the imprescriptible right of surface use in the nature of a servitude in favor of the Department of Natural Resources, including its Offices and Commissions, for the sole purpose of implementing, constructing, servicing and maintaining approved coastal zone management and/or restoration projects. Utilization of any and all rights derived under this lease by the mineral lessee, its agents, successors or assigns, shall not interfere with nor hinder the reasonable surface use by the Department of Natural Resources, its Offices or Commissions, as herein above reserved.

Applicant: THEOPHILUS OIL, GAS & LAND SERVICES, LLC

Bidder	Cash Payment	Price/Acre	Rental	Oil	Gas	Other

Legend
11030155
Blocks

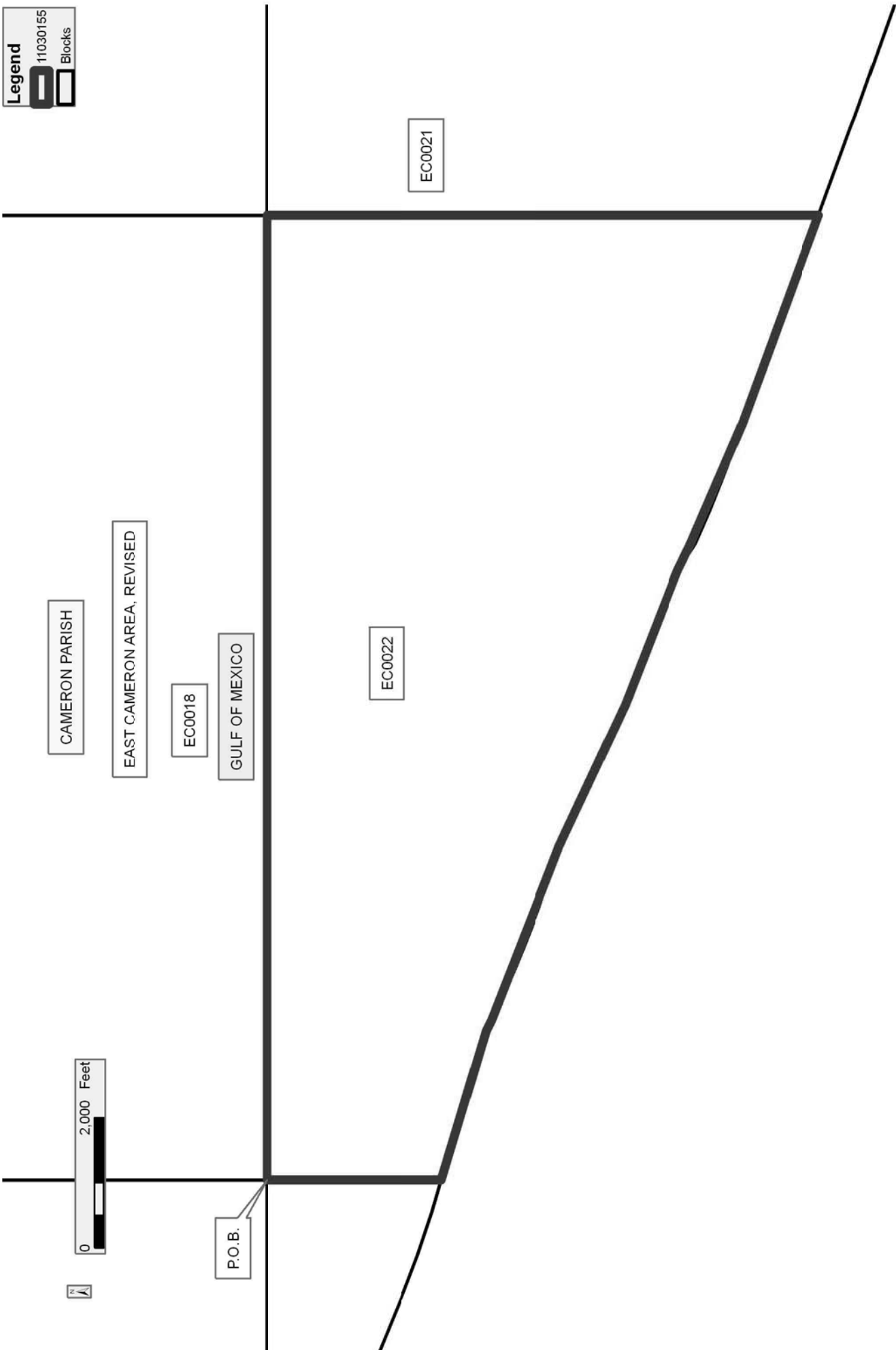

CAMERON PARISH

EAST CAMERON AREA, REVISED

EC0018

GULF OF MEXICO

EC0022

EC0021

0 2,000 Feet



P.O.B.

TRACT 41899 - Portion of Block 20, East Cameron Area, Revised, Cameron Parish, Louisiana

The beds and bottoms of all water bodies belonging to the State of Louisiana located in Block 20, East Cameron Area, Revised, together with any present lands formed by accretion to the shoreline or islands formed therein, located in Cameron Parish, Louisiana, owned by and not presently under mineral lease as of March 9, 2011, from the State of Louisiana, the geographical area of which is more fully described as follows: Beginning at a point on the West line of Block 20, East Cameron Area, Revised having Coordinates of X = 1,583,306.34 and Y = 330,042.90; thence East 7,973.49 feet to a point on the East line of said Block 20 having Coordinates of X = 1,591,279.83 and Y = 330,042.90; thence South 00 degrees 38 minutes 35 seconds West 14,317.94 feet along the East line of said Block 20 to its Southeast corner having Coordinates of X = 1,591,119.13 and Y = 315,725.86; thence West 2,145.41 feet along the South line of said Block 20 to a point on the Three Mile Line, as decreed by the Supreme Court of the United States, as determined by a Special Master appointed therein, in litigation styled *United States v. State of Louisiana et al No. 9 Original*, in 1975, having Coordinates of X = 1,588,973.72 and Y = 315,725.86; thence Northwesterly along a straight line to a point having Coordinates of X = 1,588,108 and Y = 315,899; thence Northwesterly along an arc having a radius of 18,240.60 feet and a center located at X = 1,591,685 and Y = 333,785 to a point having Coordinates of X = 1,585,928 and Y = 316,477; thence Northwesterly along a straight line to a point having Coordinates of X = 1,584,286 and Y = 317,023; thence Northwesterly along a straight line to a point on the West line of said Block 20 having Coordinates of X = 1,583,306.34 and Y = 317,276.72; thence North 12,766.18 feet along the West line of said Block 20 to the point of beginning, containing approximately **2,500.00 acres, LESS AND EXCEPT** that portion thereof, if any, lying seaward of the line three nautical miles from the coast line of Louisiana, as said three mile line has been decreed by the Supreme Court of the United States, as determined by a Special Master appointed therein, in litigation styled **United States v. State of Louisiana et al No. 9 Original**, in 1975, all as more particularly outlined on a plat in the Office of Mineral Resources, Department of Natural Resources. All bearings, distances and coordinates are based on the Louisiana Coordinate System of 1927, (South Zone).

NOTE: The above description of the Tract nominated for lease has been provided and corrected, where required, exclusively by the nomination party. Any mineral lease selected from this Tract and awarded by the Louisiana State Mineral and Energy Board shall be without warranty of any kind, either express, implied, or statutory, including, but not limited to, the implied warranties of merchantability and fitness for a particular purpose. Should the mineral lease awarded by the Louisiana State Mineral and Energy Board be subsequently modified, cancelled or abrogated due to the existence of conflicting leases, operating agreements, private claims or other future obligations or conditions which may affect all or any portion of the leased Tract, it shall not relieve the Lessee of the

obligation to pay any bonus due thereon to the Louisiana State Mineral and Energy Board, nor shall the Louisiana State Mineral and Energy Board be obligated to refund any consideration paid by the Lessor prior to such modification, cancellation, or abrogation, including, but not limited to, bonuses, rentals and royalties.

NOTE: The State of Louisiana does hereby reserve, and this lease shall be subject to, the imprescriptible right of surface use in the nature of a servitude in favor of the Department of Natural Resources, including its Offices and Commissions, for the sole purpose of implementing, constructing, servicing and maintaining approved coastal zone management and/or restoration projects. Utilization of any and all rights derived under this lease by the mineral lessee, its agents, successors or assigns, shall not interfere with nor hinder the reasonable surface use by the Department of Natural Resources, its Offices or Commissions, as herein above reserved.

Applicant: THEOPHILUS OIL, GAS & LAND SERVICES, LLC

Bidder	Cash Payment	Price/Acre	Rental	Oil	Gas	Other

Legend

 11030158
 Blocks

