

R 31 E

4 182

Mercantile

PIPELINE

P.O.B.
X=2,631,065.40
Y=198,122.69

SL 15918, As Amended

T 22 S

TR 34190
318 ± ACS.
MAR, 2002

PASS

Voels Pass

POND

13

18

17

16

TIGER

BURAS

Iuzenes Island

NAD 27 LAMBERT LA. SOUTH ZONE

Plaquemines Parish, Louisiana

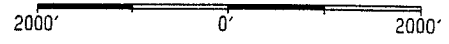

TRACT 34191 - Plaquemines Parish, Louisiana

All of the lands now or formerly constituting the beds and bottoms of all water bodies of every nature and description and all islands and other lands formed by accretion or reliction, except tax lands, owned by and not under mineral lease from the State of Louisiana on March 13, 2002, situated in Plaquemines Parish, Louisiana, within the following described boundaries: Beginning at a point having Coordinates of X = 2,604,000.00 and Y = 249,000.00; thence West 15,000.00 feet to a point having Coordinates of X = 2,589,000.00 and Y = 249,000.00; thence North approximately 547 feet to the Southeast corner of State Lease No. 16660; thence North approximately 2,712 feet along the East line of said State Lease No. 16660 to its Northeast corner; thence North approximately 7,741 feet to a point having Coordinates of X = 2,589,000.00 and Y = 260,000.00; thence East 15,000.00 feet to a point having Coordinates of X = 2,604,000.00 and Y = 260,000.00; thence South 11,000.00 feet to the point of beginning, containing approximately 1,159 acres, as shown outlined on a plat on file in the Office of Mineral Resources, Department of Natural Resources, as provided by the applicant. All bearings, distances and coordinates are based on Louisiana Coordinate System of 1927 (South Zone).

NOTE: The above description of the tract nominated for lease has been provided exclusively by the party nominating the tract for lease. The Louisiana State Mineral Board makes no representation as to the accuracy of the description of the nominated tract or its suitability for lease. The Louisiana State Mineral Board has made no inspection of the nominated tract for the existence of conflicting leases, operating agreements, private claims or other existing or future obligations or conditions which may affect all or any portion of the nominated tract or its suitability for lease.

Maps depicting the nominated tract, containing the bearings, distances and coordinates of the nominated tract based on the Louisiana Coordinate System of 1927, North or South Zone, as applicable, are available for public inspection and review at the offices of the Louisiana State Mineral Board from 10:00 a.m. to 3:00 p.m. Monday - Friday.

In the event of conflict between the description of the nominated tract set forth above and the description of the nominated property as contained on the maps maintained at the offices of the Louisiana State Mineral Board, the Louisiana State Mineral Board maps shall prevail and shall provide the final property description of the lease to be awarded of the nominated tract.

Any mineral lease of the nominated tract by the Louisiana State Mineral Board shall be without warranty of any kind, either express, implied, or statutory, including, but not limited to, the implied warranties or merchantability and fitness for a particular purpose. Should the mineral lease of the nominated tract awarded by the Louisiana State Mineral Board be subsequently modified, cancelled or abrogated due to the existence of conflicting leases, operating agreements, private claims or other existing of future obligations or conditions which may affect all or any portion of the leased tract, it shall not relieve the Lessee of the obligation to pay any bonus due thereon to the Louisiana State Mineral Board, nor shall the

Louisiana State Mineral Board be obligated to refund any consideration paid by the Lessee prior to such modification, cancellation, or abrogation, including, but not limited to, bonuses, rents and royalties.

NOTE: The above tract is located in or near an oyster restricted area and all operations in such area must be conducted in strict conformity with the stipulations and/or regulations of the Louisiana Department of Wildlife and Fisheries.

NOTE: The State of Louisiana does hereby reserve, and this lease shall be subject to, the imprescriptible right of surface use in the nature of a servitude in favor of the Department of Natural Resources, including its Offices and Commissions, for the sole purpose of implementing, constructing, servicing and maintaining approved coastal zone management and/or restoration projects. Utilization of any and all rights derived under this lease by the mineral lessee, its agents, successors or assigns, shall not interfere with nor hinder the reasonable surface use by the Department of Natural Resources, its Offices or Commissions, as hereinabove reserved.

Applicant: R. Cody

Bidder	Cash Payment	Price / Acre	Rental	Oil	Gas	Other

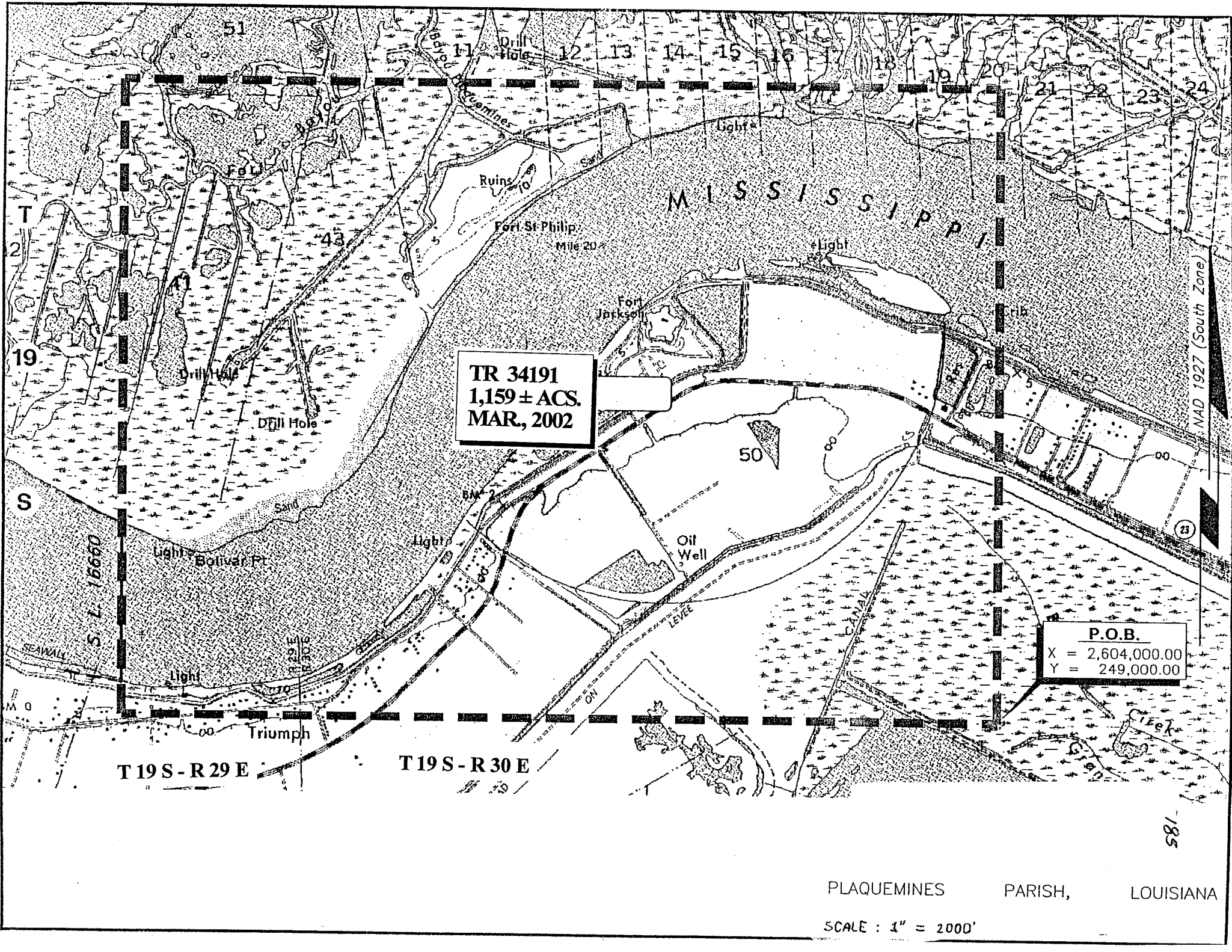

TR 34191
1,159 ± ACS.
MAR, 2002

P.O.B.
X = 2,604,000.00
Y = 249,000.00

T 19 S - R 29 E

T 19 S - R 30 E

PLAQUEMINES PARISH, LOUISIANA

SCALE : 1" = 2000'

581

TRACT 34192 - Plaquemines Parish, Louisiana

All of the lands now or formerly constituting the beds and bottoms of all water bodies of every nature and description and all islands and other lands formed by accretion or reliction, except tax lands, owned by and not under mineral lease from the State of Louisiana on March 13, 2002, situated in Plaquemines Parish, Louisiana, within the following described boundaries: Beginning at a Southeast corner of State Lease No. 17236 having Coordinates of X = 2,637,060.59 and Y = 257,831.45; thence along the Southerly boundary of said State Lease No. 17236 the following two courses: North 02 degrees 08 minutes 27 seconds West 700.00 feet and North 87 degrees 51 minutes 33 seconds East 1,320.00 feet to a point on the Westerly boundary of State Lease No. 17238 having Coordinates of X = 2,638,353.52 and Y = 258,580.28; thence South 02 degrees 08 minutes 33 seconds East 424.48 feet along the Westerly boundary of said State Lease No. 17238 to the Southwest corner thereof; thence South 02 degrees 08 minutes 24 seconds East 1,198.60 feet to the Northeast corner of Operating Agreement No. 261 having Coordinates of X = 2,638,414.15 and Y = 256,958.33; thence South 87 degrees 51 minutes 33 seconds West 2,639.98 feet along the Northerly boundary of said Operating Agreement No. 261 to a point having Coordinates of X = 2,635,776.01 and Y = 256,859.71; thence North 02 degrees 08 minutes 27 seconds West 303.08 feet to a point having Coordinates of X = 2,635,764.69 and Y = 257,162.58; thence North 87 degrees 51 minutes 33 seconds East 1,320.00 feet to a point having Coordinates of X = 2,637,083.77 and Y = 257,211.89; thence North 02 degrees 08 minutes 37 seconds West 620.00 feet to the point of beginning, **LESS AND EXCEPT** all that portion of State Lease No. 335, as amended, that may lie within the above described tract, containing approximately **58.37 acres**, as shown outlined on a plat on file in the Office of Mineral Resources, Department of Natural Resources, as provided by the applicant. All bearings, distances and coordinates are based on Louisiana Coordinate System of 1927 (South Zone).

NOTE: The above description of the tract nominated for lease has been provided exclusively by the party nominating the tract for lease. The Louisiana State Mineral Board makes no representation as to the accuracy of the description of the nominated tract or its suitability for lease. The Louisiana State Mineral Board has made no inspection of the nominated tract for the existence of conflicting leases, operating agreements, private claims or other existing or future obligations or conditions which may affect all or any portion of the nominated tract or its suitability for lease.

Maps depicting the nominated tract, containing the bearings, distances and coordinates of the nominated tract based on the Louisiana Coordinate System of 1927, North or South Zone, as applicable, are available for public inspection and review at the offices of the Louisiana State Mineral Board from 10:00 a.m. to 3:00 p.m. Monday - Friday.

In the event of conflict between the description of the nominated tract set forth above and the description of the nominated property as contained on the maps maintained at the offices of the Louisiana State Mineral Board, the Louisiana State Mineral Board maps shall prevail and shall

provide the final property description of the lease to be awarded of the nominated tract.

Any mineral lease of the nominated tract by the Louisiana State Mineral Board shall be without warranty of any kind, either express, implied, or statutory, including, but not limited to, the implied warranties or merchantability and fitness for a particular purpose. Should the mineral lease of the nominated tract awarded by the Louisiana State Mineral Board be subsequently modified, cancelled or abrogated due to the existence of conflicting leases, operating agreements, private claims or other existing of future obligations or conditions which may affect all or any portion of the leased tract, it shall not relieve the Lessee of the obligation to pay any bonus due thereon to the Louisiana State Mineral Board, nor shall the Louisiana State Mineral Board be obligated to refund any consideration paid by the Lessee prior to such modification, cancellation, or abrogation, including, but not limited to, bonuses, rents and royalties.

NOTE: The above tract is located in or near an oyster restricted area and all operations in such area must be conducted in strict conformity with the stipulations and/or regulations of the Louisiana Department of Wildlife and Fisheries.

NOTE: The State of Louisiana does hereby reserve, and this lease shall be subject to, the imprescriptible right of surface use in the nature of a servitude in favor of the Department of Natural Resources, including its Offices and Commissions, for the sole purpose of implementing, constructing, servicing and maintaining approved coastal zone management and/or restoration projects. Utilization of any and all rights derived under this lease by the mineral lessee, its agents, successors or assigns, shall not interfere with nor hinder the reasonable surface use by the Department of Natural Resources, its Offices or Commissions, as hereinabove reserved.

Applicant: Harold J. Anderson, Inc.

Bidder	Cash Payment	Price / Acre	Rental	Oil	Gas	Other

R 18 E

GRAND BAY 21

22

188

BRETO

BAY

Jack Bay

SL 17236

SL 17238

Platform

P.O.B.
X=2,637,060.59
Y= 257,831.45

TR 34192
58.37 ± ACS.
MARCH, 2002

Section 27

Section 28

Section 26

OPERATING AGREEMENT
No. 261

T 19 S

28

BAY

Section 33

Section 34

Section 35

33

34

35

NAD 27 LAMBERT LA. SOUTH ZONE



Plaquemines Parish, Louisiana

REVISED:

2000 0 2000



Scale in Feet

TRACT 34193 - PORTION OF BLOCK 26, MAIN PASS AREA, REVISED, Plaquemines Parish, Louisiana

All of the lands now or formerly constituting the beds and bottoms of all water bodies of every nature and description and all islands and other lands formed by accretion or reliction, except tax lands, belonging to the State of Louisiana and not under mineral lease on March 13, 2002, situated in Plaquemines Parish, Louisiana, and more particularly described as follows: Beginning at a point having Coordinates of X = 2,635,350.00 and Y = 307,580.00, said point also being the Southeast corner of Block 26, Main Pass Area, Revised; thence West 5,478.92 feet on and along the South line of said Block 26 to a point having Coordinates of X = 2,629,871.08 and Y = 307,580.00, said point also being on the Eastern boundary of State Lease No. 16937; thence on and along the Eastern and Northern boundaries of said State Lease No. 16937 the following courses and distances: North 13 degrees 13 minutes 42 seconds West 4,156.28 feet to a point having Coordinates of X = 2,628,920.00 and Y = 311,626.00 and South 71 degrees 09 minutes 18 seconds West 998.52 feet to a point having Coordinates of X = 2,627,975.00 and Y = 311,303.47; thence North 3,178.17 feet to a point having Coordinates of X = 2,627,975.00 and Y = 314,481.64, said point also being on a Southern boundary of State Lease No. 15127; thence North 57 degrees 13 minutes 03 seconds East 874.24 feet on and along said Southern boundary of said State Lease No. 15127 to a point having Coordinates of X = 2,628,710.00 and Y = 314,955.00, said point also being a Southeast corner of State Lease No. 15985; thence on and along the Eastern and Northern boundaries of State Lease No. 15985 the following courses and distances: North 2,568.78 feet to a point having Coordinates of X = 2,628,710.00 and Y = 317,523.78 and West 735.00 feet to a point having Coordinates of X = 2,627,975.00 and Y = 317,523.78; thence North 4,806.22 feet to a point having Coordinates of X = 2,627,975.00 and Y = 322,330.00, said point also being on the North line of said Block 26; thence East 7,375.00 feet on and along said North line of said Block 26 to a point having Coordinates of X = 2,635,350.00 and Y = 322,330.00, said point also being the Northeast corner of said Block 26; thence South 14,750.00 feet on and along the East line of said Block 26 to the point of beginning, **LESS AND EXCEPT** all those portions of State Lease Nos. 16935 and 16936 that may lie within the above described tract, containing approximately **2,039.36 acres**, as shown outlined on a plat on file in the Office of Mineral Resources, Department of Natural Resources, as provided by the applicant. All bearings, distances and coordinates are based on Louisiana Coordinate System of 1927 (South Zone).

NOTE: The above description of the tract nominated for lease has been provided exclusively by the party nominating the tract for lease. The Louisiana State Mineral Board makes no representation as to the accuracy of the description of the nominated tract or its suitability for lease. The Louisiana State Mineral Board has made no inspection of the nominated tract for the existence of conflicting leases, operating agreements, private claims or other existing or future obligations or conditions which may affect all or any portion of the nominated tract or its suitability for lease.