

TRACT 45246 - Portion of Blocks 3, and 4, Vermilion Area, Revised, Vermilion Parish, Louisiana

The beds and bottoms of all water bodies belonging to the State of Louisiana located in Blocks 3, and 4, Vermilion Area, Revised, together with any present lands formed by accretion to the shoreline or islands formed therein, located in Vermilion Parish, Louisiana, owned by and not presently under mineral lease as of January 8, 2020, from the State of Louisiana, the geographical area of which is more fully described as follows: Beginning at a point on the South boundary of Block 03, Vermilion Area, Revised having Coordinates of X = 1,623,422.43 and Y = 317,582.82; thence North approximately 8,953 feet to a point on the south boundary of Rockefeller Wildlife Refuge having a Coordinate of X = 1,623,422.43; thence along the boundary of said Wildlife Refuge the following courses: Southeasterly approximately 4,966 feet and Northerly approximately 1,853 feet to a point of intersection with the Louisiana Coastline, as decreed by the Supreme Court of the United States, as determined by a Special Master appointed therein, in litigation styled *United States v. State of Louisiana et al No. 9 Original*, in 1975; thence along the boundary of said Coastline the following courses: Southeasterly along a straight line to a point having Coordinates of X = 1,629,147 and Y = 327,939, Southeasterly along a straight line to a point having Coordinates of X = 1,632,624.12 and Y = 327,483.59, and Southeasterly along a straight line to a point having Coordinates of X = 1,634,846.11 and Y = 327,192.57; thence South 9,609.76 feet to a point on the South boundary of said Block 4 having Coordinates of X = 1,634,846.11 and Y = 317,582.82; thence West 11,423.68 feet along the South boundaries of said Block 4 and Block 3 to the point of beginning, containing approximately **2,486.51 acres**, all as more particularly outlined on a plat on file in the Office of Mineral Resources, Department of Natural Resources. All bearings, distances and coordinates are based on Louisiana Coordinate System of 1927, (North or South Zone).

NOTE: The above description of the Tract nominated for lease has been provided and corrected, where required, exclusively by the nomination party. Any mineral lease selected from this Tract and awarded by the Louisiana State Mineral and Energy Board shall be without warranty of any kind, either express, implied, or statutory, including, but not limited to, the implied warranties of merchantability and fitness for a particular purpose. Should the mineral lease awarded by the Louisiana State Mineral and Energy Board be subsequently modified, cancelled or abrogated due to the existence of conflicting leases, operating agreements, private claims or other future obligations or conditions which may affect all or any portion of the leased Tract, it shall not relieve the Lessee of the obligation to pay any bonus due thereon to the Louisiana State Mineral and Energy Board, nor shall the Louisiana State Mineral and Energy Board be obligated to refund any consideration paid by the Lessor prior to such modification, cancellation, or abrogation, including, but not limited to, bonuses, rentals and royalties.

NOTE: The State of Louisiana does hereby reserve, and this lease shall be subject to, the imprescriptible right of surface use in the nature of a

servitude in favor of the Department of Natural Resources, including its Offices and Commissions, for the sole purpose of implementing, constructing, servicing and maintaining approved coastal zone management and/or restoration projects. Utilization of any and all rights derived under this lease by the mineral lessee, its agents, successors or assigns, shall not interfere with nor hinder the reasonable surface use by the Department of Natural Resources, its Offices or Commissions, as herein above reserved.

Applicant: CYPRESS ENERGY CORPORATION

Bidder	Cash Payment	Price/ Acre	Rental	Oil	Gas	Other

Legend

20010017

Wildlife

Blocks

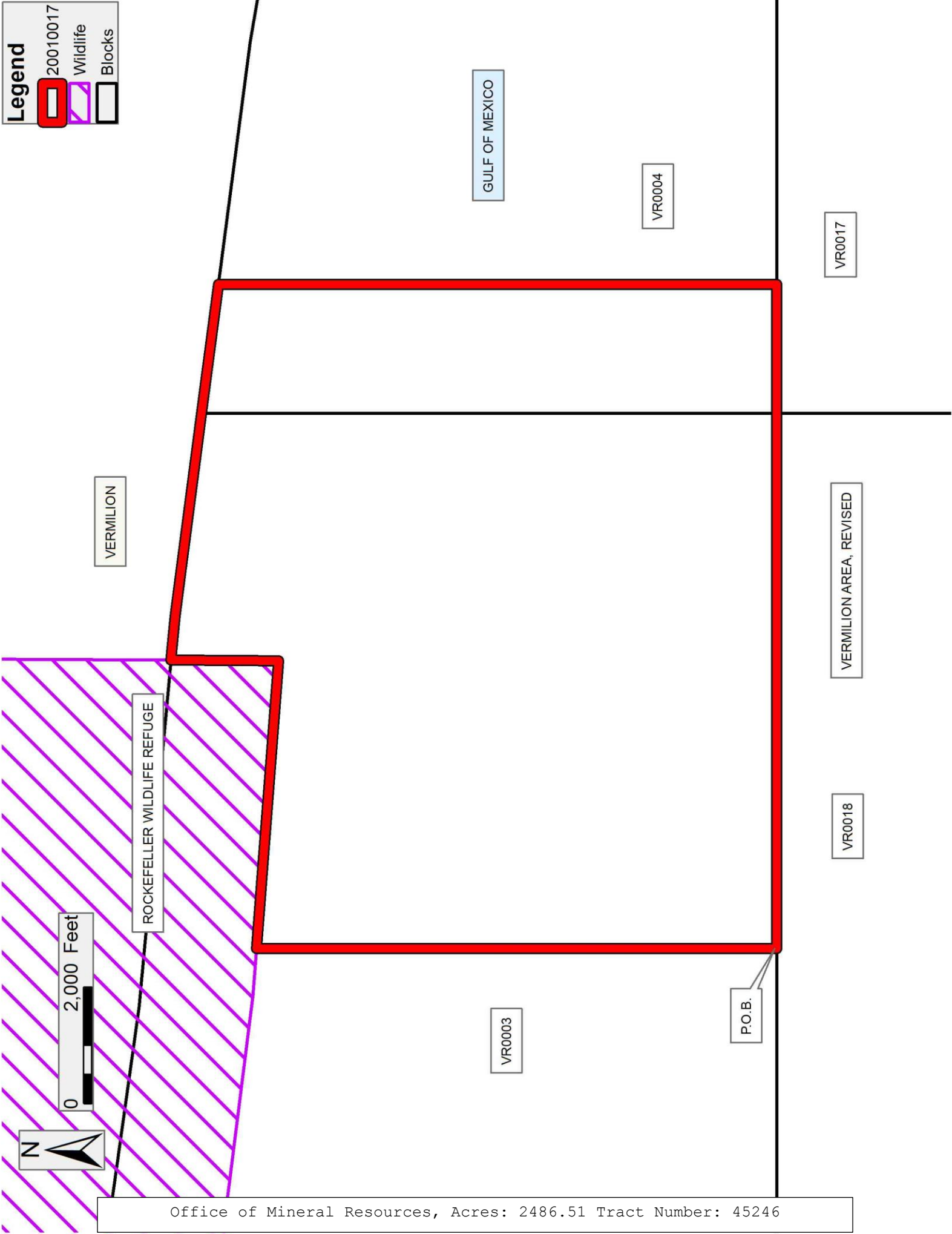

TRACT 45247 - Portion of Block 4, Vermilion Area, Revised, Vermilion Parish, Louisiana

The beds and bottoms of all water bodies belonging to the State of Louisiana located in Block 4, Vermilion Area, Revised, together with any present lands formed by accretion to the shoreline or islands formed therein, located in Vermilion Parish, Louisiana, owned by and not presently under mineral lease as of January 8, 2020, from the State of Louisiana, the geographical area of which is more fully described as follows: Beginning at a point on the South boundary of Block 04, Vermilion Area, Revised having Coordinates of X = 1,634,846.11 and Y = 317,582.82; thence North 9,609.76 feet to a point on the Louisiana Coastline, as decreed by the Supreme Court of the United States, as determined by a Special Master appointed therein, in litigation styled *United States v. State of Louisiana et al No. 9 Original*, in 1975, having Coordinates of X = 1,634,846.11 and Y = 327,192.57; thence along said Coastline he following: Southeasterly along a straight line to a point having Coordinates of X = 1,639,027 and Y = 326,645 and Southeasterly along a straight line to a point having Coordinates of X = 1,647,382.17 and Y = 325,204.61, said point also being the Northeast corner of said Block 04; thence South 7,621.79 feet to a point having Coordinates of X = 1,647,382.17 and Y = 317,582.82; thence West 12,536.06 feet to the point of beginning, containing approximately **2,496.13 acres**, all as more particularly outlined on a plat on file in the Office of Mineral Resources, Department of Natural Resources. All bearings, distances and coordinates are based on Louisiana Coordinate System of 1927, (North or South Zone).

NOTE: The above description of the Tract nominated for lease has been provided and corrected, where required, exclusively by the nomination party. Any mineral lease selected from this Tract and awarded by the Louisiana State Mineral and Energy Board shall be without warranty of any kind, either express, implied, or statutory, including, but not limited to, the implied warranties of merchantability and fitness for a particular purpose. Should the mineral lease awarded by the Louisiana State Mineral and Energy Board be subsequently modified, cancelled or abrogated due to the existence of conflicting leases, operating agreements, private claims or other future obligations or conditions which may affect all or any portion of the leased Tract, it shall not relieve the Lessee of the obligation to pay any bonus due thereon to the Louisiana State Mineral and Energy Board, nor shall the Louisiana State Mineral and Energy Board be obligated to refund any consideration paid by the Lessor prior to such modification, cancellation, or abrogation, including, but not limited to, bonuses, rentals and royalties.

NOTE: The State of Louisiana does hereby reserve, and this lease shall be subject to, the imprescriptible right of surface use in the nature of a servitude in favor of the Department of Natural Resources, including its Offices and Commissions, for the sole purpose of implementing, constructing, servicing and maintaining approved coastal zone management and/or restoration projects. Utilization of any and all rights derived under this lease by the mineral lessee, its agents, successors or assigns, shall not

interfere with nor hinder the reasonable surface use by the Department of Natural Resources, its Offices or Commissions, as herein above reserved.

Applicant: CYPRESS ENERGY CORPORATION

Bidder	Cash Payment	Price/ Acre	Rental	Oil	Gas	Other

Legend

20010016

Blocks



VERMILION

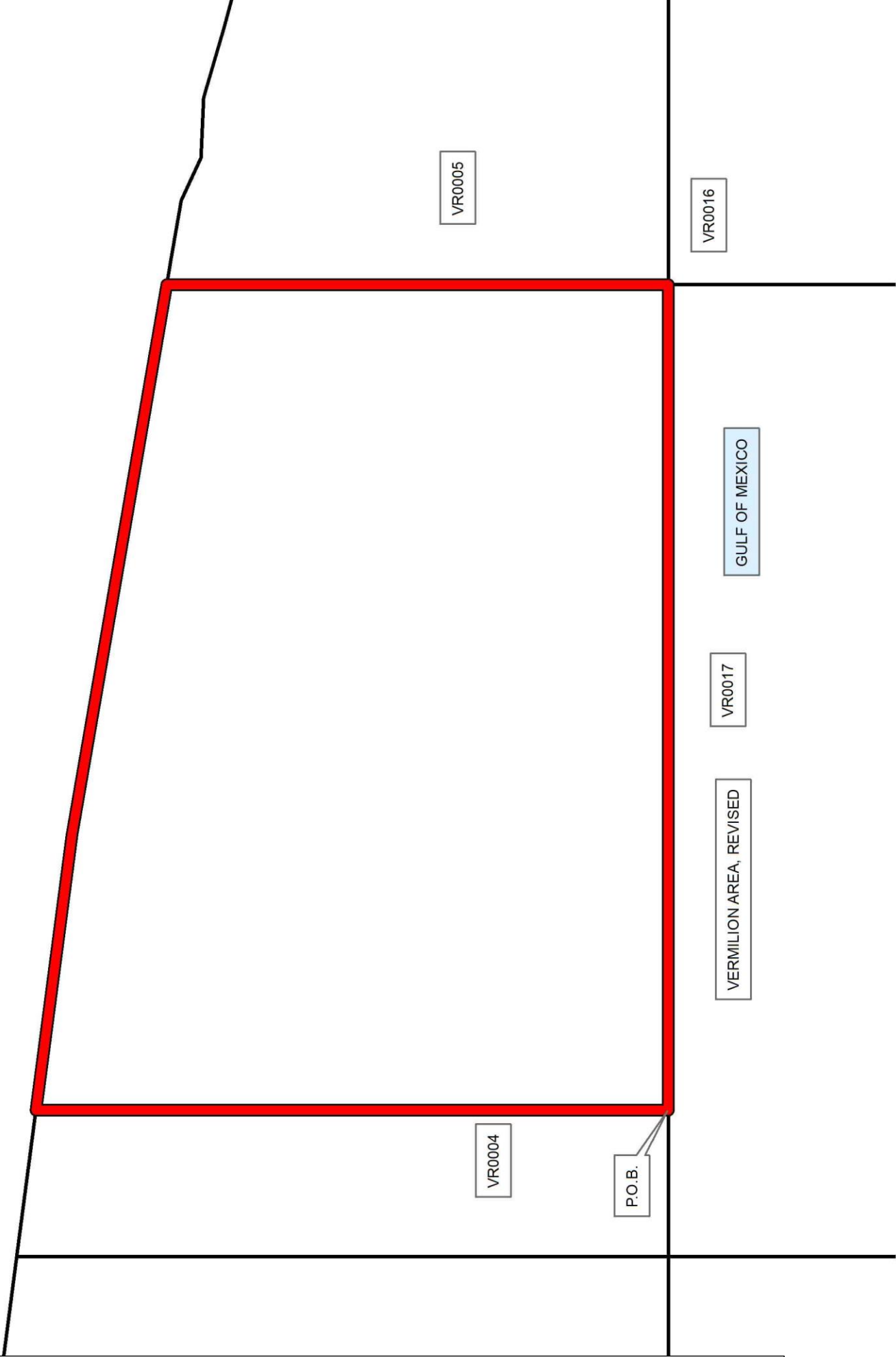

TRACT 45248 - Portion of Block 5, Vermilion Area, Revised, Vermilion Parish, Louisiana

The beds and bottoms of all water bodies belonging to the State of Louisiana located in Block 5, Vermilion Area, Revised, together with any present lands formed by accretion to the shoreline or islands formed therein, located in Vermilion Parish, Louisiana, owned by and not presently under mineral lease as of January 8, 2020, from the State of Louisiana, the geographical area of which is more fully described as follows: Beginning at a point on the West boundary of Block 05, Vermilion Area, Revised having Coordinates of X = 1,647,382.17 and Y = 317,582.82; thence North 7,621.79 feet to a point on the Louisiana Coastline, as decreed by the Supreme Court of the United States, as determined by a Special Master appointed therein, in litigation styled *United States v. State of Louisiana et al No. 9 Original*, in 1975, having Coordinates of X = 1,647,382.17 and Y = 325,204.61; thence along said Coastline the following courses: Southeasterly along a straight line to a point having Coordinates of X = 1,648,656 and Y = 324,985, Southeasterly along a straight line to a point having Coordinates of X = 1,649,308 and Y = 324,684, Southeasterly along a straight line to a point having Coordinates of X = 1,650,220 and Y = 324,644, Southeasterly along a straight line to a point having Coordinates of X = 1,651,294 and Y = 324,333, Southeasterly along a straight line to a point having Coordinates of X = 1,653,430 and Y = 323,751, Southeasterly along a straight line to a point having Coordinates of X = 1,655,896 and Y = 323,305, Southeasterly along a straight line to a point having Coordinates of X = 1,657,050 and Y = 323,540, Southeasterly along a straight line to a point having Coordinates of X = 1,658,887 and Y = 323,134, Southeasterly along a straight line to a point having Coordinates of X = 1,659,960 and Y = 323,169, and Southeasterly along a straight line to a point having Coordinates of X = 1,662,140.22 and Y = 322,702.84; thence South 5,120.02 feet to a point having Coordinates of X = 1,662,140.23 and Y = 317,582.82; thence West 4,500.01 feet to the Northeast corner of State Lease No. 3763, as amended and Southeast corner of State Lease No. 3762, as amended having Coordinates of X = 1,657,640.22 and Y = 317,582.82; thence along the boundaries of said State Lease No. 3762 the following courses: North 1,508.65 feet to a point having Coordinates of X = 1,657,640.22 and Y = 319,091.46 and North 71 degrees 10 minutes 28 seconds West 2,286.60 feet to its Northwest corner and the Northeast corner of State Lease No. 19967, as amended having Coordinates of X = 1,654.908.04 and Y = 320,022.93; thence along the boundaries of said State Lease No. 19967 the following courses: North 71 degrees 10 minutes 28 seconds West 1,116.23 feet to a point having Coordinates of X = 1,653,851.52 and Y = 320,383.12, South 63 degrees 25 minutes 46 seconds West 3,067.29 feet to a point having Coordinates of X = 1,651,108.19 and Y = 319,011.13 and South 28 degrees 02 minutes 21 seconds West 1,618.25 feet to its Southwest corner and the Northwest corner of said State Lease No. 3763 having Coordinates of X = 1,650,347.49 and Y = 317,582.82; thence West 2,965.32 feet to the point of beginning, containing approximately **1,769.49 acres**, all as more particularly outlined on a plat on file in the Office of Mineral Resources, Department of Natural Resources. All bearings, distances and coordinates are based on Louisiana Coordinate System of 1927, (North or South Zone).

NOTE: The above description of the Tract nominated for lease has been provided and corrected, where required, exclusively by the nomination party. Any mineral lease selected from this Tract and awarded by the Louisiana State Mineral and Energy Board shall be without warranty of any kind, either express, implied, or statutory, including, but not limited to, the implied warranties of merchantability and fitness for a particular purpose. Should the mineral lease awarded by the Louisiana State Mineral and Energy Board be subsequently modified, cancelled or abrogated due to the existence of conflicting leases, operating agreements, private claims or other future obligations or conditions which may affect all or any portion of the leased Tract, it shall not relieve the Lessee of the obligation to pay any bonus due thereon to the Louisiana State Mineral and Energy Board, nor shall the Louisiana State Mineral and Energy Board be obligated to refund any consideration paid by the Lessor prior to such modification, cancellation, or abrogation, including, but not limited to, bonuses, rentals and royalties.

NOTE: The State of Louisiana does hereby reserve, and this lease shall be subject to, the imprescriptible right of surface use in the nature of a servitude in favor of the Department of Natural Resources, including its Offices and Commissions, for the sole purpose of implementing, constructing, servicing and maintaining approved coastal zone management and/or restoration projects. Utilization of any and all rights derived under this lease by the mineral lessee, its agents, successors or assigns, shall not interfere with nor hinder the reasonable surface use by the Department of Natural Resources, its Offices or Commissions, as herein above reserved.

Applicant: CYPRESS ENERGY CORPORATION

Bidder	Cash Payment	Price/ Acre	Rental	Oil	Gas	Other

Legend

20010019

Blocks

Active_Leases



VERMILION

Office of Mineral Resources, Acres: 1769.49 Tract Number: 45248

T17S - R1E

GULF OF MEXICO

VR0006

VERMILION AREA, REVISED

VR0016

SL 3762

SL 19967

SL 3763

VR0004

P.O.B.

VR0017

TRACT 45249 - Portion of Blocks 17, and 18, Vermilion Area, Revised, Vermilion Parish, Louisiana

The beds and bottoms of all water bodies belonging to the State of Louisiana located in Blocks 17, and 18, Vermilion Area, Revised, together with any present lands formed by accretion to the shoreline or islands formed therein, located in Vermilion Parish, Louisiana, owned by and not presently under mineral lease as of January 8, 2020, from the State of Louisiana, the geographical area of which is more fully described as follows: Beginning at a point on the North boundary of Block 18, Vermilion Area, Revised having Coordinates of X = 1,623,422.43 and Y = 317,582.82; thence East 11,423.68 feet along the North boundary of said Block 18 and into Block 17, Vermilion Area, Revised to a point having Coordinates of X = 1,634,846.11 and Y = 317,582.82; thence South 8,786.44 feet to a point being a point on the South boundary of said Block 17, said point also a point on the Three Mile Line, as decreed by the Supreme Court of the United States, as determined by a Special Master appointed therein, in litigation styled *United States v. State of Louisiana et al No. 9 Original*, in 1975 having Coordinates of X = 1,634,846.11 and Y = 308,796.38; thence along said Three Mile Line the following courses: Northwesterly along a straight line to a point having Coordinates of X = 1,627,130 and Y = 309,807 and Northwesterly along a straight line to a point having Coordinates of X = 1,623,422.43 and Y = 310,146.17; thence North 7,436.65 feet to the point of beginning, containing approximately **2,114.30 acres, LESS AND EXCEPT** that portion thereof, if any, lying seaward of the line three nautical miles from the coast line of Louisiana, as said three mile line has been decreed by the Supreme Court of the United States, as determined by a Special Master appointed therein, in litigation styled **United States v. State of Louisiana et al No. 9 Original**, in 1975, all as more particularly outlined on a plat in the Office of Mineral Resources, Department of Natural Resources. All bearings, distances and coordinates are based on the Louisiana Coordinate System of 1927, (South Zone).

NOTE: The above description of the Tract nominated for lease has been provided and corrected, where required, exclusively by the nomination party. Any mineral lease selected from this Tract and awarded by the Louisiana State Mineral and Energy Board shall be without warranty of any kind, either express, implied, or statutory, including, but not limited to, the implied warranties of merchantability and fitness for a particular purpose. Should the mineral lease awarded by the Louisiana State Mineral and Energy Board be subsequently modified, cancelled or abrogated due to the existence of conflicting leases, operating agreements, private claims or other future obligations or conditions which may affect all or any portion of the leased Tract, it shall not relieve the Lessee of the obligation to pay any bonus due thereon to the Louisiana State Mineral and Energy Board, nor shall the Louisiana State Mineral and Energy Board be obligated to refund any consideration paid by the Lessor prior to such modification, cancellation, or abrogation, including, but not limited to, bonuses, rentals and royalties.

NOTE: The State of Louisiana does hereby reserve, and this lease shall be subject to, the imprescriptible right of surface use in the nature of a servitude in favor of the Department of Natural Resources, including its Offices and Commissions, for the sole purpose of implementing, constructing, servicing and maintaining approved coastal zone management and/or restoration projects. Utilization of any and all rights derived under this lease by the mineral lessee, its agents, successors or assigns, shall not interfere with nor hinder the reasonable surface use by the Department of Natural Resources, its Offices or Commissions, as herein above reserved.

Applicant: CYPRESS ENERGY CORPORATION

Bidder	Cash Payment	Price/ Acre	Rental	Oil	Gas	Other



0 2,000 Feet

Legend

20010018

Blocks

Counties

VERMILION

GULF OF MEXICO

VR0004

VR0017

VERMILION AREA, REVISED

VR0003

P.O.B.

VR0018

TRACT 45250 - Portion of Block 17, Vermilion Area, Revised, Vermilion Parish, Louisiana

The beds and bottoms of all water bodies belonging to the State of Louisiana located in Block 17, Vermilion Area, Revised, together with any present lands formed by accretion to the shoreline or islands formed therein, located in Vermilion Parish, Louisiana, owned by and not presently under mineral lease as of January 8, 2020, from the State of Louisiana, the geographical area of which is more fully described as follows: Beginning at a point on the North boundary of Block 17, Vermilion Area, Revised having Coordinates of X = 1,634,846.11 and Y = 317,582.82; thence East 12,536.06 feet along the North boundary of said Block 17 to its Northeast corner having Coordinates of X = 1,647,382.17 and Y = 317,582.82; thence South 3,252.26 feet to the Northeast corner of State Lease No. 17156, as amended, having Coordinates of X = 1,647,382.17 and Y = 314,330.55; thence along the boundaries of said State Lease No. 17156, as amended, the following courses: South 42 degrees 30 minutes 38 seconds West 380.57 feet to a point having Coordinates of X = 1,647,125.00 and Y = 314,050.01, South 79 degrees 05 minutes 20 seconds West 2,113.20 feet to a point having Coordinates of X = 1,645,050.00 and Y = 313,650.01, North 34 degrees 49 minutes 28 seconds East 1,400.90 feet to a point having Coordinates of X = 1,645,850.01 and Y = 314,800.01, North 39 degrees 48 minutes 20 seconds East 1,171.54 feet to a point having Coordinates of X = 1,646,600.01 and Y = 315,700.01, North 42 degrees 42 minutes 38 seconds East 105.68 feet to a point having Coordinates of X = 1,646,671.69 and Y = 315,777.66, North 89 degrees 16 minutes 38 seconds West 6,200.50 feet to a point having Coordinates of X = 1,640,471.68 and Y = 315,855.88, South 06 degrees 37 minutes 02 seconds East 3,630.06 feet to a point having Coordinates of X = 1,640,890.00 and Y = 312,250.00, South 1,117.70 feet to a point having Coordinates of X = 1,640,890.00 and Y = 311,132.30, East 5,460.00 feet to a point having Coordinates of X = 1,646,350.00 and Y = 311,132.30, North 533.50 feet to a point having Coordinates of X = 1,646,350.00 and Y = 311,665.80 and East 1,032.17 feet to its Southeast corner having Coordinates of X = 1,647,382.17 and Y = 311,665.80; thence South 5,172.12 feet to a point on the Three Mile Line, as decreed by the Supreme Court of the United States, as determined by a Special Master appointed therein, in litigation styled *United States v. State of Louisiana et al No. 9 Original*, in 1975, having Coordinates of X = 1,647,382.17 and Y = 306,493.68; thence along said Three Mile Line the following courses: Northwesterly along a straight line to a point having Coordinates of X = 1,647,051 and Y = 306,584, Northwesterly along an arc having a radius of 18,240.60 feet and a center located at X = 1,649,308 and Y = 324,684 to a point having Coordinates of X = 1,643,681 and Y = 307,333, Northwesterly along a straight line to a point having Coordinates of X = 1,636,292 and Y = 308,607, and Northwesterly along a straight line to a point having Coordinates of X = 1,634,846.11 and Y = 308,796.38; thence North 8,786.44 feet to the point of beginning, containing approximately **2,197.33 acres, LESS AND EXCEPT** that portion thereof, if any, lying seaward of the line three nautical miles from the coast line of Louisiana, as said three mile line has been decreed by the Supreme Court of the United States, as determined by a Special Master appointed therein, in litigation styled **United**

States v. State of Louisiana et al No. 9 Original, in 1975, all as more particularly outlined on a plat in the Office of Mineral Resources, Department of Natural Resources. All bearings, distances and coordinates are based on the Louisiana Coordinate System of 1927, (South Zone).

NOTE: The above description of the Tract nominated for lease has been provided and corrected, where required, exclusively by the nomination party. Any mineral lease selected from this Tract and awarded by the Louisiana State Mineral and Energy Board shall be without warranty of any kind, either express, implied, or statutory, including, but not limited to, the implied warranties of merchantability and fitness for a particular purpose. Should the mineral lease awarded by the Louisiana State Mineral and Energy Board be subsequently modified, cancelled or abrogated due to the existence of conflicting leases, operating agreements, private claims or other future obligations or conditions which may affect all or any portion of the leased Tract, it shall not relieve the Lessee of the obligation to pay any bonus due thereon to the Louisiana State Mineral and Energy Board, nor shall the Louisiana State Mineral and Energy Board be obligated to refund any consideration paid by the Lessor prior to such modification, cancellation, or abrogation, including, but not limited to, bonuses, rentals and royalties.

NOTE: The State of Louisiana does hereby reserve, and this lease shall be subject to, the imprescriptible right of surface use in the nature of a servitude in favor of the Department of Natural Resources, including its Offices and Commissions, for the sole purpose of implementing, constructing, servicing and maintaining approved coastal zone management and/or restoration projects. Utilization of any and all rights derived under this lease by the mineral lessee, its agents, successors or assigns, shall not interfere with nor hinder the reasonable surface use by the Department of Natural Resources, its Offices or Commissions, as herein above reserved.

Applicant: CYPRESS ENERGY CORPORATION

Bidder	Cash Payment	Price/ Acre	Rental	Oil	Gas	Other

Legend

- 20010015
- Blocks
- Active_Leases
- Counties



TRACT 45251 - Portion of Block 16, Vermilion Area, Revised, Vermilion Parish, Louisiana

The beds and bottoms of all water bodies belonging to the State of Louisiana located in Block 16, Vermilion Area, Revised, together with any present lands formed by accretion to the shoreline or islands formed therein, located in Vermilion Parish, Louisiana, owned by and not presently under mineral lease as of January 8, 2020, from the State of Louisiana, the geographical area of which is more fully described as follows: Beginning at a point within Block 16, Vermilion Area, Revised and a point on the Southern boundary of State Lease No. 3763, as amended having Coordinates of X = 1,654,858.44 and Y = 315,549.80; thence South 10,455.78 feet to a point on the Three Mile Line, as decreed by the Supreme Court of the United States, as determined by a Special Master appointed therein, in litigation styled *United States v. State of Louisiana et al No. 9 Original*, in 1975, having Coordinates of X = 1,654,858.44 and Y = 305,094.02; thence along said Three Mile Line the following courses: Northwesterly along an arc having a radius of 18,240.60 feet and a center located at X = 1,655,896 and Y = 323,305 to a point having Coordinates of X = 1,652,650 and Y = 305,356, Northwesterly along a straight line to a point having Coordinates of X = 1,650,184 and Y = 305,802, Northwesterly along an arc having a radius of 18,240.60 feet and a center located at X = 1,653,430 and Y = 323,751 to a point having Coordinates of X = 1,648,635 and Y = 306,152, and Northwesterly along a straight line to a point on the West boundary of said Block 16 having Coordinates of X = 1,647,382.17 and Y = 306,493.68; thence North 11,089.14 feet along the west boundary of said Block 16 to a point being its Northwest corner having Coordinates of X = 1,647,382.17 and Y = 317,582.80; thence East 2,965.32 feet along the North boundary of said Block 16 to a point being the Northwest Corner of said State Lease No. 3763, as amended, having Coordinates of X = 1,650,347.49 and Y = 317,582.82; thence along the boundaries of said State Lease No. 3763, as amended, the following courses: South 28 degrees 02 minutes 21 seconds West 3,045.25 feet to a point having Coordinates of X = 1,648,916.00 and Y = 314,895.00, South 06 degrees 45 minutes 50 seconds West 1,749.36 feet to a point having Coordinates of X = 1,648,709.96 and Y = 313,157.82, South 48 degrees 50 minutes 00 seconds East 1,031.90 feet to a point having Coordinates of X = 1,649,486.77 and Y = 312,478.57 and North 60 degrees 14 minutes 29 seconds East 6,187.67 feet to the point of beginning, containing approximately **1,580.16 acres, LESS AND EXCEPT** that portion thereof, if any, lying seaward of the line three nautical miles from the coast line of Louisiana, as said three mile line has been decreed by the Supreme Court of the United States, as determined by a Special Master appointed therein, in litigation styled **United States v. State of Louisiana et al No. 9 Original**, in 1975, all as more particularly outlined on a plat in the Office of Mineral Resources, Department of Natural Resources. All bearings, distances and coordinates are based on the Louisiana Coordinate System of 1927, (South Zone).

NOTE: The above description of the Tract nominated for lease has been provided and corrected, where required, exclusively by the nomination party. Any mineral lease selected from this Tract and awarded by the Louisiana State

Mineral and Energy Board shall be without warranty of any kind, either express, implied, or statutory, including, but not limited to, the implied warranties of merchantability and fitness for a particular purpose. Should the mineral lease awarded by the Louisiana State Mineral and Energy Board be subsequently modified, cancelled or abrogated due to the existence of conflicting leases, operating agreements, private claims or other future obligations or conditions which may affect all or any portion of the leased Tract, it shall not relieve the Lessee of the obligation to pay any bonus due thereon to the Louisiana State Mineral and Energy Board, nor shall the Louisiana State Mineral and Energy Board be obligated to refund any consideration paid by the Lessor prior to such modification, cancellation, or abrogation, including, but not limited to, bonuses, rentals and royalties.

NOTE: The State of Louisiana does hereby reserve, and this lease shall be subject to, the imprescriptible right of surface use in the nature of a servitude in favor of the Department of Natural Resources, including its Offices and Commissions, for the sole purpose of implementing, constructing, servicing and maintaining approved coastal zone management and/or restoration projects. Utilization of any and all rights derived under this lease by the mineral lessee, its agents, successors or assigns, shall not interfere with nor hinder the reasonable surface use by the Department of Natural Resources, its Offices or Commissions, as herein above reserved.

Applicant: CYPRESS ENERGY CORPORATION

Bidder	Cash Payment	Price/ Acre	Rental	Oil	Gas	Other



TRACT 45252 - Portion of Block 16, Vermilion Area, Revised, Vermilion Parish, Louisiana

The beds and bottoms of all water bodies belonging to the State of Louisiana located in Block 16, Vermilion Area, Revised, together with any present lands formed by accretion to the shoreline or islands formed therein, located in Vermilion Parish, Louisiana, owned by and not presently under mineral lease as of January 8, 2020, from the State of Louisiana, the geographical area of which is more fully described as follows: Beginning at the Northeast corner of Block 16, Vermilion Area, Revised having Coordinates of X = 1,662,140.23 and Y = 317,582.82; thence South 13,549.69 feet along the said East boundary of said Block 16 to a point on the Three Mile Line, as decreed by the Supreme Court of the United States, as determined by a Special Master appointed therein, in litigation styled *United States v. State of Louisiana et al No. 9 Original*, in 1975, having Coordinates of X = 1,662,140.23 and Y = 304,033.13; thence along said Three Mile Line the following courses: Northwesterly along a straight line to a point having Coordinates of X = 1,661,678 and Y = 304,151, Northwesterly along a straight line to a point having Coordinates of X = 1,659,494 and Y = 304,616, Northwesterly along an arc having a radius of 18,240.60 feet and a center located at X = 1,663,290 and Y = 322,457 to a point having Coordinates of X = 1,659,476 and Y = 304,620, Northwesterly along a straight line to a point having Coordinates of X = 1,658,120 and Y = 304,910, Northwesterly along an arc having a radius of 18,240.60 feet and a center located at X = 1,658,887 and Y = 323,134 to a point having Coordinates of X = 1,656,354 and Y = 305,070, and Northwesterly along an arc having a radius of 18,240.60 feet and a center located at X = 1,655,896 and Y = 323,305 to a point having Coordinates of X = 1,654,858.44 and Y = 305,094.02; thence North 10,455.78 feet to a point on the southern boundary of State Lease No. 3763, as amended, having Coordinates of X = 1,654,858.44 and Y = 315,549.80; thence along the boundaries of said State Lease No. 3763, as amended, the following courses: North 60 degrees 14 minutes 29 seconds East 3,204.36 feet to a point having Coordinates of X = 1,657,640.22 and Y = 317,140.27, and North 442.55 feet to its Northeast corner and a point on the north boundary of said Block 16 having Coordinates of X = 1,657,640.22 and Y = 317,582.82; thence East 4,500.01 feet to the point of beginning, containing approximately **2,070.93 acres, LESS AND EXCEPT** that portion thereof, if any, lying seaward of the line three nautical miles from the coast line of Louisiana, as said three mile line has been decreed by the Supreme Court of the United States, as determined by a Special Master appointed therein, in litigation styled **United States v. State of Louisiana et al No. 9 Original**, in 1975, all as more particularly outlined on a plat in the Office of Mineral Resources, Department of Natural Resources. All bearings, distances and coordinates are based on the Louisiana Coordinate System of 1927, (South Zone).

NOTE: The above description of the Tract nominated for lease has been provided and corrected, where required, exclusively by the nomination party. Any mineral lease selected from this Tract and awarded by the Louisiana State Mineral and Energy Board shall be without warranty of any kind, either express, implied, or statutory, including, but not limited to, the implied

warranties of merchantability and fitness for a particular purpose. Should the mineral lease awarded by the Louisiana State Mineral and Energy Board be subsequently modified, cancelled or abrogated due to the existence of conflicting leases, operating agreements, private claims or other future obligations or conditions which may affect all or any portion of the leased Tract, it shall not relieve the Lessee of the obligation to pay any bonus due thereon to the Louisiana State Mineral and Energy Board, nor shall the Louisiana State Mineral and Energy Board be obligated to refund any consideration paid by the Lessor prior to such modification, cancellation, or abrogation, including, but not limited to, bonuses, rentals and royalties.

NOTE: The State of Louisiana does hereby reserve, and this lease shall be subject to, the imprescriptible right of surface use in the nature of a servitude in favor of the Department of Natural Resources, including its Offices and Commissions, for the sole purpose of implementing, constructing, servicing and maintaining approved coastal zone management and/or restoration projects. Utilization of any and all rights derived under this lease by the mineral lessee, its agents, successors or assigns, shall not interfere with nor hinder the reasonable surface use by the Department of Natural Resources, its Offices or Commissions, as herein above reserved.

Applicant: CYPRESS ENERGY CORPORATION

Bidder	Cash Payment	Price/ Acre	Rental	Oil	Gas	Other

Legend

- 20010013
- Blocks
- Active_Leases
- Counties

