

TRACT 41806 - Iberia St. Martin and St. Mary Parishes, LOUISIANA

All land, and land now or formerly constituting the beds and bottoms of any water body of whatever description and nature, all belonging to the State of Louisiana located within the geographical boundaries of the Atakapas WMA and not presently under mineral lease by the State of Louisiana as of January 12, 2011, the area of which is set forth as follows: Beginning at a point within Attakapas Island Wildlife Management Area having Coordinates of X = 1,952,402.82 and Y = 474,250.00; thence East 8,463.07 feet to a point having Coordinates of X = 1,960,865.89 and Y = 474,250.00; thence South 13,629.01 feet to a point on the North boundary of State Lease No. 14521 having Coordinates of X = 1,960,865.89 and Y = 460,620.99; thence West 4,865.89 feet along the North boundary of said State Lease No. 14521 to the Southeast corner of State Lease No. 14912, as amended, having Coordinates of X = 1,956,000.00 and Y = 460,620.99; thence along the boundary of said State Lease No. 14912 the following courses: North 1,791.17 feet to a corner having Coordinates of X = 1,956,000.00 and Y = 462,412.16 and West 3,597.18 feet to its Northwest corner, also being the Northernmost Northeast corner of State Lease No. 14520, as amended, having Coordinates of X = 1,952,402.82 and Y = 462,412.16; thence North 11,837.84 feet to the point of beginning, containing approximately **2,500.00 acres**, all as more particularly outlined on a plat on file in the Office of Mineral Resources, Department of Natural Resources. All bearings, distances and coordinates are based on Louisiana Coordinate System of 1927, (North or South Zone).

NOTE: The above description of the Tract nominated for lease has been provided and corrected, where required, exclusively by the nomination party. Any mineral lease selected from this Tract and awarded by the Louisiana State Mineral and Energy Board shall be without warranty of any kind, either express, implied, or statutory, including, but not limited to, the implied warranties of merchantability and fitness for a particular purpose. Should the mineral lease awarded by the Louisiana State Mineral and Energy Board be subsequently modified, cancelled or abrogated due to the existence of conflicting leases, operating agreements, private claims or other future obligations or conditions which may affect all or any portion of the leased Tract, it shall not relieve the Lessee of the obligation to pay any bonus due thereon to the Louisiana State Mineral and Energy Board, nor shall the Louisiana State Mineral and Energy Board be obligated to refund any consideration paid by the Lessor prior to such modification, cancellation, or abrogation, including, but not limited to, bonuses, rentals and royalties.

NOTE: The mineral lease is located in the Attakapas Wildlife Management Area under the jurisdiction of the Louisiana Department of Wildlife and Fisheries which has promulgated rules and regulations for the protection of game and wildlife on the aforesaid Tract and, therefore, shall be subject to said rules and regulations, a copy of which shall be attached to the mineral lease. In addition to the specific rules and regulations

applicable, the following shall apply regarding operations under this mineral lease:

NOTE: No activities will be allowed without written authorization from the Louisiana Department of Wildlife and Fisheries.

NOTE: Proposed projects will be evaluated on a case by case basis. Modifications to proposed project features including but not limited to access routes, spoil placement, well sites, flowlines and appurtenant structures may be required by the Department of Wildlife and Fisheries.

NOTE: Compliance with the said WMA regulations will be required unless otherwise specified by the Department of Wildlife and Fisheries.

NOTE: Compensatory mitigation will be required to offset unavoidable wetland impacts.

NOTE: Removal of all structures, facilities and equipment will be required within 120 days of abandonment unless otherwise agreed to in writing by the Louisiana Department of Wildlife and Fisheries.

NOTE: No activities will be allowed during the hunting season unless approved by the Department.

NOTE: Prior to submitting applications for wetland permits to Federal and State permitting agencies the leaseholder shall coordinate project details with the Department of Wildlife and Fisheries. Contact person for the Department will be Mike Windham at (504) 284-5268.

NOTE: Additionally, the Department will require a minimum bonus of \$350.00 per acre and a minimum royalty of 25%.

Applicant: THEOPHILUS OIL, GAS & LAND SERVICES, LLC

Bidder	Cash Payment	Price/Acre	Rental	Oil	Gas	Other

Legend

- 11010022
- Wildlife
- Active_Leases
- Counties

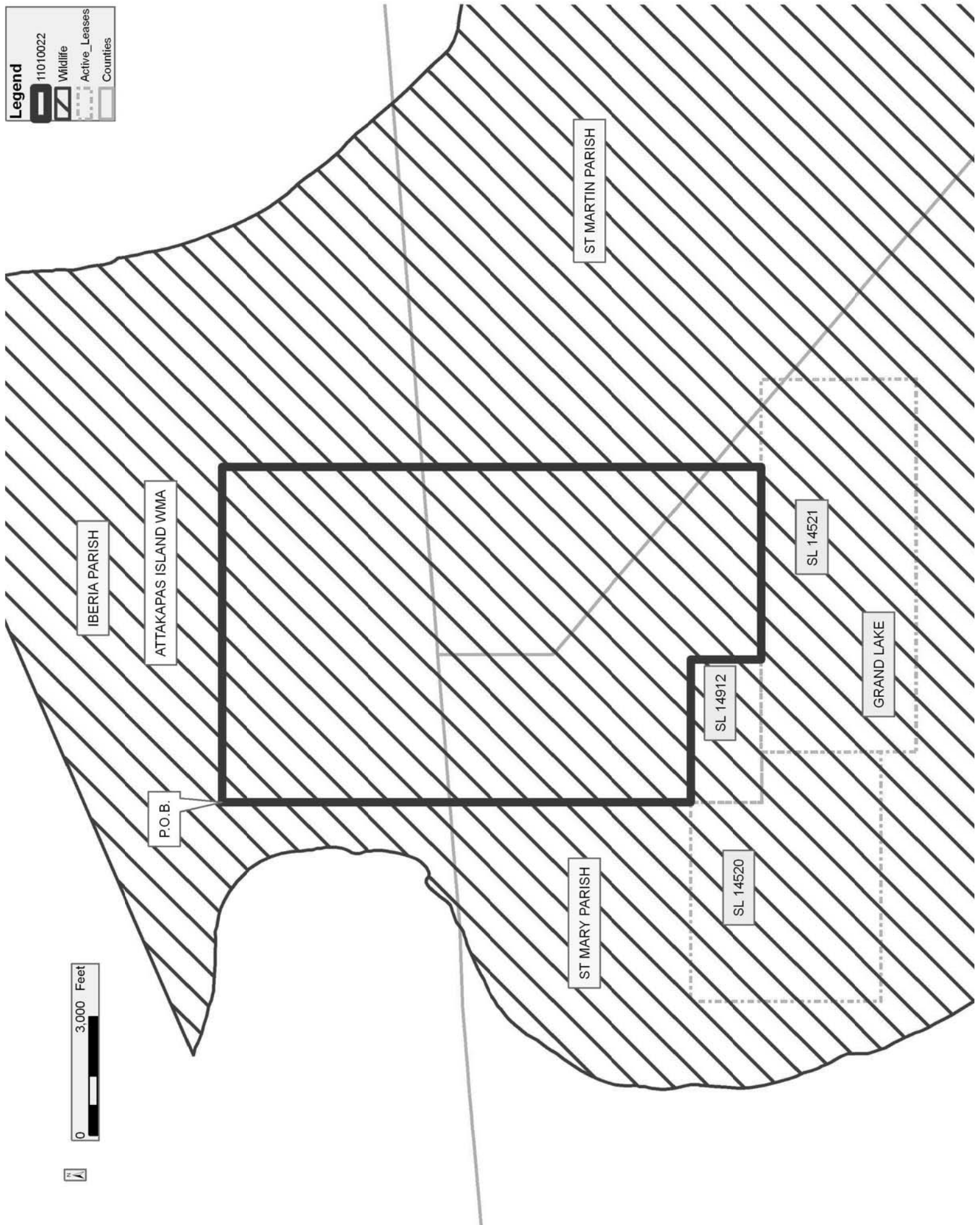

TRACT 41807 - Iberia St. Martin and St. Mary Parishes, LOUISIANA

All land, and land now or formerly constituting the beds and bottoms of any water body of whatever description and nature, all belonging to the State of Louisiana located within the geographical boundaries of the Atakapas WMA and not presently under mineral lease by the State of Louisiana as of January 12, 2011, the area of which is set forth as follows: Beginning at a point within the Attakapas Island Wildlife Management Area having Coordinates of X = 1,960,865.89 and Y = 474,250.00; thence East approximately 5,976 feet to a point on the Eastern boundary of said Attakapas Island Wildlife Management Area having a Coordinate of Y = 474,250.00; thence Southeasterly along the meanders of the boundary of said Attakapas Island Wildlife Management Area to a point of intersection with a North-South line having a Coordinate of X = 1,969,494.26; thence South approximately 9,406 feet along said line to a point having Coordinates of X = 1,969,494.26 and Y = 461,170.99; thence West 6,419.77 feet to a point having Coordinates of X = 1,963,074.49 and Y = 461,170.99; thence South 550.00 feet to the Northeast corner of State Lease No. 14521, as amended, having Coordinates of X = 1,963,074.49 and Y = 460,620.99; thence West 2,208.60 feet along the North boundary of said State Lease No. 14521 to a point having Coordinates of X = 1,960,865.89 and Y = 460,620.99; thence North 13,629.01 feet to the point of beginning, **LESS AND EXCEPT** that portion, if any, of the above described tract lying outside the boundaries of the Attakapas Island Wildlife Management Area, containing approximately **2,498 acres**, all as more particularly outlined on a plat on file in the Office of Mineral Resources, Department of Natural Resources. All bearings, distances and coordinates are based on Louisiana Coordinate System of 1927, (North or South Zone).

NOTE: The above description of the Tract nominated for lease has been provided and corrected, where required, exclusively by the nomination party. Any mineral lease selected from this Tract and awarded by the Louisiana State Mineral and Energy Board shall be without warranty of any kind, either express, implied, or statutory, including, but not limited to, the implied warranties of merchantability and fitness for a particular purpose. Should the mineral lease awarded by the Louisiana State Mineral and Energy Board be subsequently modified, cancelled or abrogated due to the existence of conflicting leases, operating agreements, private claims or other future obligations or conditions which may affect all or any portion of the leased Tract, it shall not relieve the Lessee of the obligation to pay any bonus due thereon to the Louisiana State Mineral and Energy Board, nor shall the Louisiana State Mineral and Energy Board be obligated to refund any consideration paid by the Lessor prior to such modification, cancellation, or abrogation, including, but not limited to, bonuses, rentals and royalties.

NOTE: The mineral lease is located in the Attakapas Wildlife Management Area under the jurisdiction of the Louisiana Department of Wildlife and Fisheries which has promulgated rules and regulations for the protection of game and wildlife on the aforesaid Tract and, therefore, shall be

subject to said rules and regulations, a copy of which shall be attached to the mineral lease. In addition to the specific rules and regulations applicable, the following shall apply regarding operations under this mineral lease:

NOTE: No activities will be allowed without written authorization from the Louisiana Department of Wildlife and Fisheries.

NOTE: Proposed projects will be evaluated on a case by case basis. Modifications to proposed project features including but not limited to access routes, spoil placement, well sites, flowlines and appurtenant structures may be required by the Department of Wildlife and Fisheries.

NOTE: Compliance with the said WMA regulations will be required unless otherwise specified by the Department of Wildlife and Fisheries.

NOTE: Compensatory mitigation will be required to offset unavoidable wetland impacts.

NOTE: Removal of all structures, facilities and equipment will be required within 120 days of abandonment unless otherwise agreed to in writing by the Louisiana Department of Wildlife and Fisheries.

NOTE: No activities will be allowed during the hunting season unless approved by the Department.

NOTE: Prior to submitting applications for wetland permits to Federal and State permitting agencies the leaseholder shall coordinate project details with the Department of Wildlife and Fisheries. Contact person for the Department will be Mike Windham at (504) 284-5268.

NOTE: Additionally, the Department will require a minimum bonus of \$350.00 per acre and a minimum royalty of 25%.

Applicant: THEOPHILUS OIL, GAS & LAND SERVICES, LLC

Bidder	Cash Payment	Price/Acre	Rental	Oil	Gas	Other

Legend

- 11010023
- Wildlife
- Active_Leases
- Counties

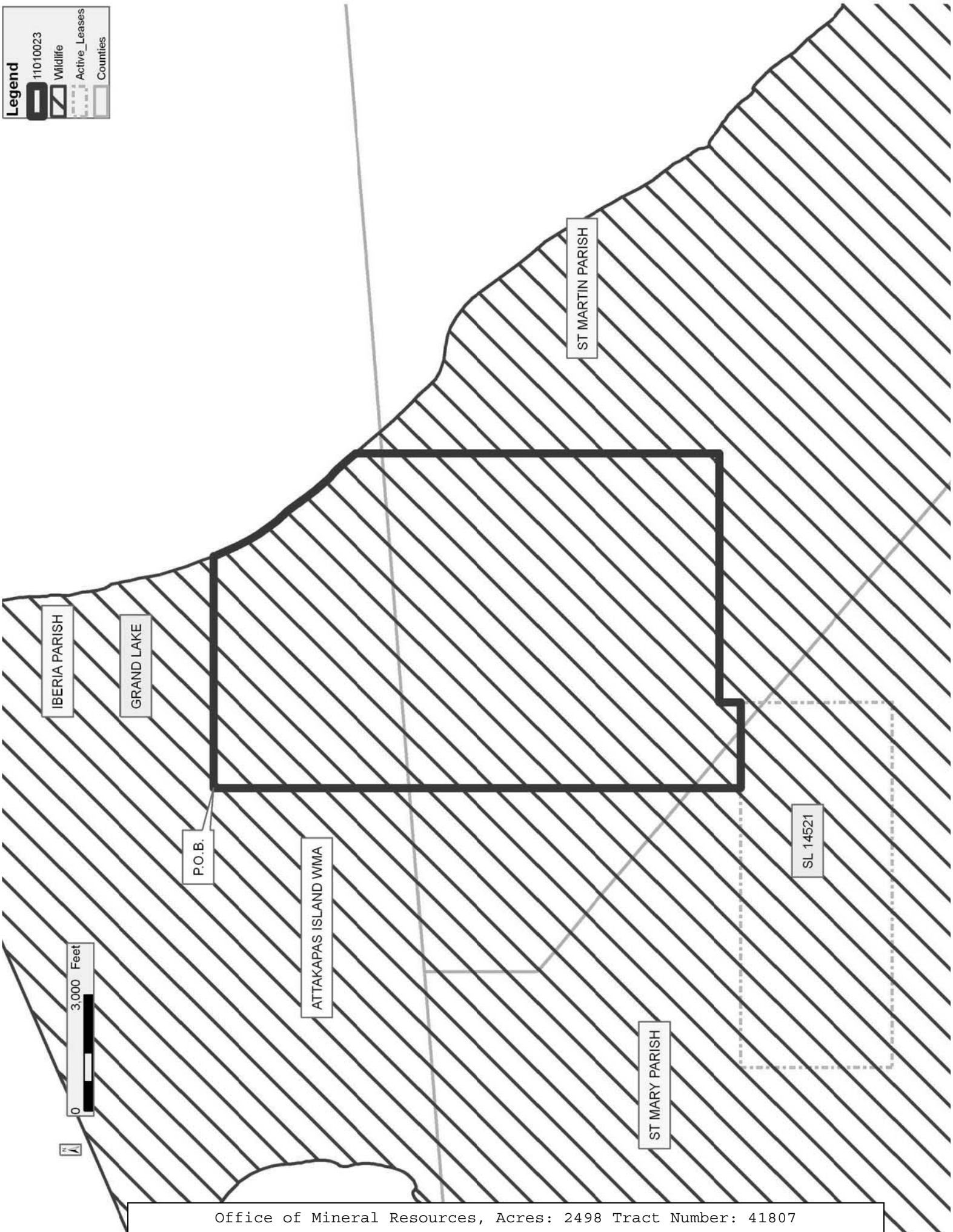

TRACT 41808 - Iberia and St. Mary Parishes, LOUISIANA

All land, and land now or formerly constituting the beds and bottoms of any water body of whatever description and nature, all belonging to the State of Louisiana located within the geographical boundaries of the Atakapas WMA and not presently under mineral lease by the State of Louisiana as of January 12, 2011, the area of which is set forth as follows: Beginning at a point within the Attakapas Island Wildlife Management Area having Coordinates of X = 1,952,402.82 and Y = 474,250.00; thence South 11,837.84 feet to the Northwest corner of State Lease No. 14912, as amended, also being the Northernmost Northeast corner of State Lease No. 14520, as amended, having Coordinates of X = 1,952,402.82 and Y = 462,412.16; thence West 5,017.82 feet along the North boundary of said State Lease No. 14520 to its Northwest corner located on the East boundary of State Lease No. 14519 having Coordinates of X = 1,947,385.00 and Y = 462,412.16; thence along the boundary of said State Lease No. 14519 the following courses: North 4,787.84 feet to a corner having Coordinates of X = 1,947,385.00 and Y = 467,200.00 and West approximately 211 feet to a point of intersection with the Western boundary of said Attakapas Island Wildlife Management Area having a Coordinate of Y = 467,200.00; thence Northeasterly, Northerly and Northwesterly along the meanders of the boundary of said Attakapas Island Wildlife Management Area to a point of intersection with an East-West line having a Coordinate of Y = 474,250.00; thence East approximately 2,594 feet along said line to the point of beginning, **LESS AND EXCEPT** that portion, if any, of the above described tract lying outside the boundaries of the Attakapas Island Wildlife Management Area, containing approximately **869 acres**, all as more particularly outlined on a plat on file in the Office of Mineral Resources, Department of Natural Resources. All bearings, distances and coordinates are based on Louisiana Coordinate System of 1927, (North or South Zone).

NOTE: The above description of the Tract nominated for lease has been provided and corrected, where required, exclusively by the nomination party. Any mineral lease selected from this Tract and awarded by the Louisiana State Mineral and Energy Board shall be without warranty of any kind, either express, implied, or statutory, including, but not limited to, the implied warranties of merchantability and fitness for a particular purpose. Should the mineral lease awarded by the Louisiana State Mineral and Energy Board be subsequently modified, cancelled or abrogated due to the existence of conflicting leases, operating agreements, private claims or other future obligations or conditions which may affect all or any portion of the leased Tract, it shall not relieve the Lessee of the obligation to pay any bonus due thereon to the Louisiana State Mineral and Energy Board, nor shall the Louisiana State Mineral and Energy Board be obligated to refund any consideration paid by the Lessor prior to such modification, cancellation, or abrogation, including, but not limited to, bonuses, rentals and royalties.

NOTE: The mineral lease is located in the Attakapas Wildlife Management Area under the jurisdiction of the Louisiana Department of Wildlife and Fisheries which has promulgated rules and regulations for the protection of game and wildlife on the aforesaid Tract and, therefore, shall be subject to said rules and regulations, a copy of which shall be attached to the mineral lease. In addition to the specific rules and regulations applicable, the following shall apply regarding operations under this mineral lease:

NOTE: No activities will be allowed without written authorization from the Louisiana Department of Wildlife and Fisheries.

NOTE: Proposed projects will be evaluated on a case by case basis. Modifications to proposed project features including but not limited to access routes, spoil placement, well sites, flowlines and appurtenant structures may be required by the Department of Wildlife and Fisheries.

NOTE: Compliance with the said WMA regulations will be required unless otherwise specified by the Department of Wildlife and Fisheries.

NOTE: Compensatory mitigation will be required to offset unavoidable wetland impacts.

NOTE: Removal of all structures, facilities and equipment will be required within 120 days of abandonment unless otherwise agreed to in writing by the Louisiana Department of Wildlife and Fisheries.

NOTE: No activities will be allowed during the hunting season unless approved by the Department.

NOTE: Prior to submitting applications for wetland permits to Federal and State permitting agencies the leaseholder shall coordinate project details with the Department of Wildlife and Fisheries. Contact person for the Department will be Mike Windham at (504) 284-5268.

NOTE: Additionally, the Department will require a minimum bonus of \$350.00 per acre and a minimum royalty of 25%.

Bidder	Cash Payment	Price/Acre	Rental	Oil	Gas	Other

Applicant: THEOPHILUS OIL, GAS & LAND SERVICES, LLC

Legend

- 11010021
- Wildlife
- Active_Leases
- Counties

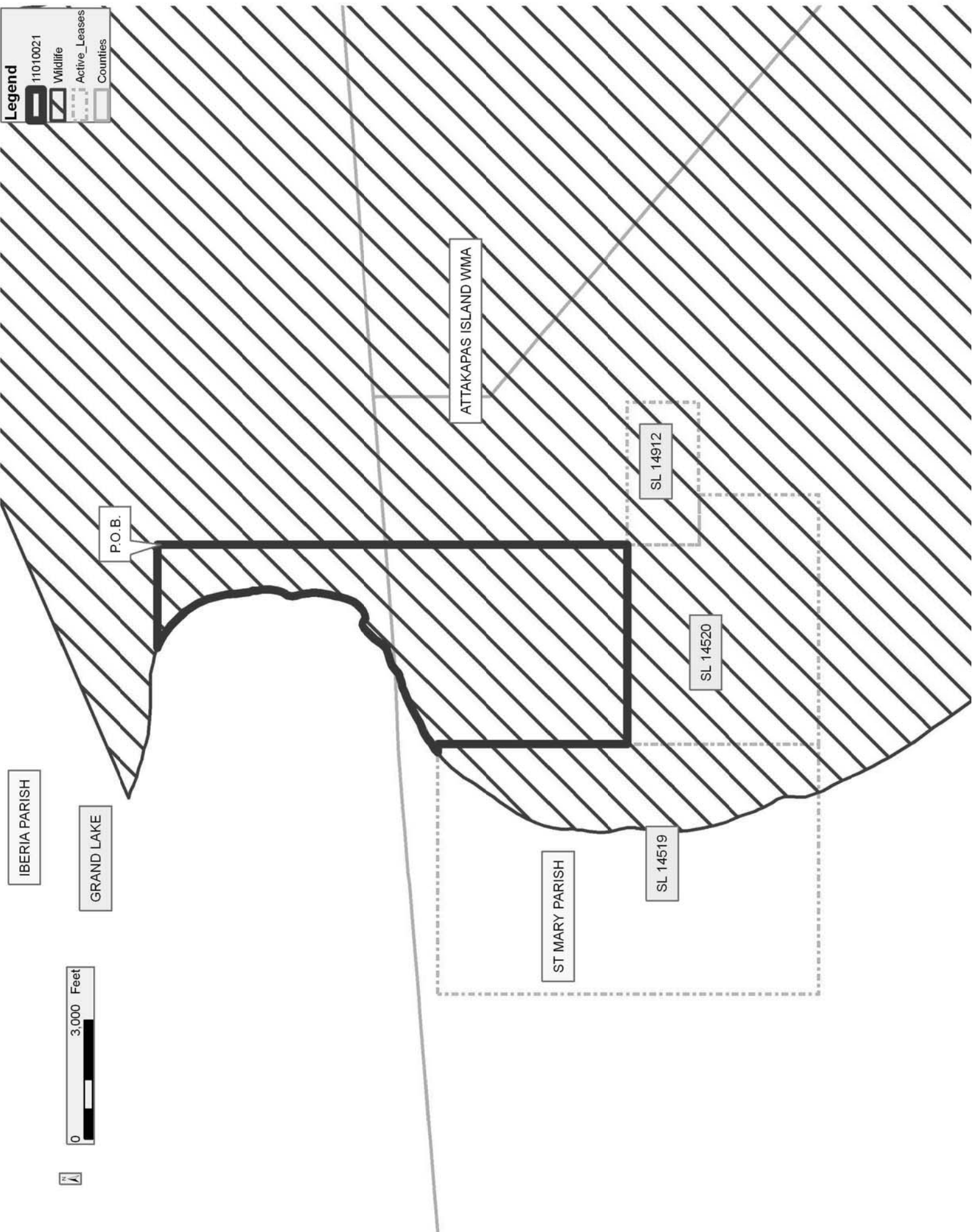

TRACT 41809 - St. Martin and St. Mary Parishes, LOUISIANA

All land, and land now or formerly constituting the beds and bottoms of any water body of whatever description and nature, all belonging to the State of Louisiana located within the geographical boundaries of the Atakapas WMA and not presently under mineral lease by the State of Louisiana as of January 12, 2011, the area of which is set forth as follows: Beginning at a point within Attakapas Island Wildlife Management Area having Coordinates of X = 1,963,074.49 and Y = 461,170.99; thence East 6,419.77 feet to a point having Coordinates of X = 1,969,494.26 and Y = 461,170.99; thence South 11,835.99 feet to a point having Coordinates of X = 1,969,494.26 and Y = 449,335.00; thence West 2,750.00 feet to a point on the East boundary of State Lease No. 18103 having Coordinates of X = 1,966,744.26 and Y = 449,335.00; thence along the boundary of said State Lease No. 18103 the following courses: North 1,500.00 feet to a corner having Coordinates of X = 1,966,744.26 and Y = 450,835.00 and West 3,669.77 feet to a point having Coordinates of X = 1,963,074.49 and Y = 450,835.00; thence North 2,749.32 feet to the Southeast corner of State Lease No. 16310 having Coordinates of X = 1,963,074.49 and Y = 453,584.32; thence North 15.68 feet along the East boundary of said State Lease No. 16310 to its Northeast corner, also being the Southeast corner of State Lease No. 14916 having Coordinates of X = 1,963,074.49 and Y = 453,600.00; thence North 2,069.56 feet along the East boundary of said State Lease No. 14916 to its Northeast corner, also being the Southeast corner of State Lease No. 14522 having Coordinates of X = 1,963,074.49 and Y = 455,669.56; thence North 1,051.43 feet along the East boundary of said State Lease No. 14522 to its Northeast corner, also being the Southeast corner of State Lease No. 14521 having Coordinates of X = 1,963,074.49 and Y = 456,720.99; thence North 3,900.00 feet along the East boundary of said State Lease No. 14521 to its Northeast corner having Coordinates of X = 1,963,074.49 and Y = 460,620.99; thence North 550.00 feet to the point of beginning, containing approximately **1,617.99 acres**, all as more particularly outlined on a plat on file in the Office of Mineral Resources, Department of Natural Resources. All bearings, distances and coordinates are based on Louisiana Coordinate System of 1927, (North or South Zone).

NOTE: The above description of the Tract nominated for lease has been provided and corrected, where required, exclusively by the nomination party. Any mineral lease selected from this Tract and awarded by the Louisiana State Mineral and Energy Board shall be without warranty of any kind, either express, implied, or statutory, including, but not limited to, the implied warranties of merchantability and fitness for a particular purpose. Should the mineral lease awarded by the Louisiana State Mineral and Energy Board be subsequently modified, cancelled or abrogated due to the existence of conflicting leases, operating agreements, private claims or other future obligations or conditions which may affect all or any portion of the leased Tract, it shall not relieve the Lessee of the obligation to pay any bonus due thereon to the Louisiana State Mineral and Energy Board, nor shall the Louisiana State Mineral and Energy Board be obligated to refund any consideration paid by the Lessor prior to such

modification, cancellation, or abrogation, including, but not limited to, bonuses, rentals and royalties.

NOTE: The mineral lease is located in the Attakapas Wildlife Management Area under the jurisdiction of the Louisiana Department of Wildlife and Fisheries which has promulgated rules and regulations for the protection of game and wildlife on the aforesaid Tract and, therefore, shall be subject to said rules and regulations, a copy of which shall be attached to the mineral lease. In addition to the specific rules and regulations applicable, the following shall apply regarding operations under this mineral lease:

NOTE: No activities will be allowed without written authorization from the Louisiana Department of Wildlife and Fisheries.

NOTE: Proposed projects will be evaluated on a case by case basis. Modifications to proposed project features including but not limited to access routes, spoil placement, well sites, flowlines and appurtenant structures may be required by the Department of Wildlife and Fisheries.

NOTE: Compliance with the said WMA regulations will be required unless otherwise specified by the Department of Wildlife and Fisheries.

NOTE: Compensatory mitigation will be required to offset unavoidable wetland impacts.

NOTE: Removal of all structures, facilities and equipment will be required within 120 days of abandonment unless otherwise agreed to in writing by the Louisiana Department of Wildlife and Fisheries.

NOTE: No activities will be allowed during the hunting season unless approved by the Department.

NOTE: Prior to submitting applications for wetland permits to Federal and State permitting agencies the leaseholder shall coordinate project details with the Department of Wildlife and Fisheries. Contact person for the Department will be Mike Windham at (504) 284-5268.

NOTE: Additionally, the Department will require a minimum bonus of \$350.00 per acre and a minimum royalty of 25%.

Applicant: THEOPHILUS OIL, GAS & LAND SERVICES, LLC

Bidder	Cash Payment	Price/Acre	Rental	Oil	Gas	Other



ST MARTIN PARISH

ATTAKAPAS ISLAND WMA

GRAND LAKE

P.O.B.

SL 14521

SL 14522

SL 14916

SL 16310

SL 18103

ST MARY PARISH



TRACT 41810 - St. Mary Parish, LOUISIANA

All land, and land now or formerly constituting the beds and bottoms of any water body of whatever description and nature, all belonging to the State of Louisiana located within the geographical boundaries of the Atakapas WMA and not presently under mineral lease by the State of Louisiana as of January 12, 2011, the area of which is set forth as follows: Beginning at the Northeast corner of State Lease No. 14915, as amended, said point located on the South boundary of State Lease No. 16310 having Coordinates of X = 1,956,200.00 and Y = 453,584.32; thence East 6,874.49 feet along the South boundary of said State Lease No. 16310 to its Southeast corner having Coordinates of X = 1,963,074.49 and Y = 453,584.32; thence South 2,749.32 feet to a point on the North boundary of State Lease No. 18103 having Coordinates of X = 1,963,074.49 and Y = 450,835.00; thence West 3,074.49 feet along the North boundary of said State Lease No. 18103 to its Northwest corner, also being the Northeast corner of State Lease No. 18634 having Coordinates of X = 1,960,000.00 and Y = 450,835.00; thence along the boundary of said State Lease No. 18634 the following courses: West 2,116.00 feet to its Northwest corner having Coordinates of X = 1,957,884.00 and Y = 450,835.00 and South 1,235.00 feet along the West boundary of said State Lease No. 18634 to a point having Coordinates of X = 1,957,884.00 and Y = 449,600.00; thence West 1,684.00 feet to the Southeast corner of State Lease No. 16859, as amended, having Coordinates of X = 1,956,200.00 and Y = 449,600.00; thence North 400.00 feet along the East boundary of said State Lease No. 16859 to its Northeast corner, also being the Southeast corner of State Lease No. 14954, as amended, having Coordinates of X = 1,956,200.00 and Y = 450,000.00; thence North 1,500.00 feet along the East boundary of said State Lease No. 14954 to its Northeast corner, also being the Southeast corner of said State Lease No. 14915 having Coordinates of X = 1,956,200.00 and Y = 451,500.00; thence North 2,084.32 feet along the East boundary of said State Lease No. 14915 to the point of beginning, containing approximately **481.63 acres**, all as more particularly outlined on a plat on file in the Office of Mineral Resources, Department of Natural Resources. All bearings, distances and coordinates are based on Louisiana Coordinate System of 1927, (North or South Zone).

NOTE: The above description of the Tract nominated for lease has been provided and corrected, where required, exclusively by the nomination party. Any mineral lease selected from this Tract and awarded by the Louisiana State Mineral and Energy Board shall be without warranty of any kind, either express, implied, or statutory, including, but not limited to, the implied warranties of merchantability and fitness for a particular purpose. Should the mineral lease awarded by the Louisiana State Mineral and Energy Board be subsequently modified, cancelled or abrogated due to the existence of conflicting leases, operating agreements, private claims or other future obligations or conditions which may affect all or any portion of the leased Tract, it shall not relieve the Lessee of the obligation to pay any bonus due thereon to the Louisiana State Mineral and Energy Board, nor shall the Louisiana State Mineral and Energy Board be

obligated to refund any consideration paid by the Lessor prior to such modification, cancellation, or abrogation, including, but not limited to, bonuses, rentals and royalties.

NOTE: The mineral lease is located in the Attakapas Wildlife Management Area under the jurisdiction of the Louisiana Department of Wildlife and Fisheries which has promulgated rules and regulations for the protection of game and wildlife on the aforesaid Tract and, therefore, shall be subject to said rules and regulations, a copy of which shall be attached to the mineral lease. In addition to the specific rules and regulations applicable, the following shall apply regarding operations under this mineral lease:

NOTE: No activities will be allowed without written authorization from the Louisiana Department of Wildlife and Fisheries.

NOTE: Proposed projects will be evaluated on a case by case basis. Modifications to proposed project features including but not limited to access routes, spoil placement, well sites, flowlines and appurtenant structures may be required by the Department of Wildlife and Fisheries.

NOTE: Compliance with the said WMA regulations will be required unless otherwise specified by the Department of Wildlife and Fisheries.

NOTE: Compensatory mitigation will be required to offset unavoidable wetland impacts.

NOTE: Removal of all structures, facilities and equipment will be required within 120 days of abandonment unless otherwise agreed to in writing by the Louisiana Department of Wildlife and Fisheries.

NOTE: No activities will be allowed during the hunting season unless approved by the Department.

NOTE: Prior to submitting applications for wetland permits to Federal and State permitting agencies the leaseholder shall coordinate project details with the Department of Wildlife and Fisheries. Contact person for the Department will be Mike Windham at (504) 284-5268.

NOTE: Additionally, the Department will require a minimum bonus of \$350.00 per acre and a minimum royalty of 25%.

Applicant: THEOPHILUS OIL, GAS & LAND SERVICES, LLC

Bidder	Cash Payment	Price/Acre	Rental	Oil	Gas	Other



ST MARY PARISH

ATTAKAPAS ISLAND WMA

GRAND LAKE

SL 14916

SL 16310

SL 18103

SL 18634

P.O.B.

SL 14915

SL 14954

SL 16859

