

SL 16795
BLK 33

BLK 35

BLOCK 34

P.O.B.
X = 2,664,850.00
Y = 307,580.00

EAST

7375'

X = 2,657,475
Y = 307,580

SL 16796

BRETON SOUND

TR 34114
1,262.48 ± ACS.
JAN., 2002

SOUTH
8300'

First Energy Corp.
SI 13861

BLOCK 48
BLOCK 47

X = 2,657,475
Y = 300,530

X = 2,660,050
Y = 300,530

WEST

2575'

4960.09'

N75°24'12"W

SL 16797

X = 2,664,850
Y = 299,280

SL 16569

BLOCK 46

BRETON SOUND AREA

Mobil
SI 5687

16892

49

Cities Service
SI 2601

Exxon Corporation
SI 14563

BLOCK 50

51

18891-TS



LOCATED IN
BLOCK 47
BRETON SOUND AREA
PLAQUEMINES PARISH, LOUISIANA
SCALE 1" = 3000'



ALL COORDINATES, BEARINGS AND DISTANCES ARE GRID, AND ARE ON THE LOUISIANA LAMBERT PLANE COORDINATE SYSTEM, SOUTH ZONE, 1927 NORTH AMERICAN DATUM.

TRACT 34115 - PORTION OF BLOCK 5, SOUTH PASS AREA, Plaquemines Parish, Louisiana

All of the lands now or formerly constituting the beds and bottoms of all water bodies of every nature and description and all islands and other lands formed by accretion or reliction, except tax lands, belonging to the State of Louisiana and not under mineral lease on January 9, 2002, situated in Plaquemines Parish, Louisiana, and more particularly described as follows: Beginning at a point on the South line of Block 5, South Pass Area, having Coordinates of X = 2,741,371.00 and Y = 170,698.00; thence West 2,772.62 feet along the South line of said Block 5 to a point having Coordinates of X = 2,738,598.38 and Y = 170,698.00; thence North 27 degrees 15 minutes 51 seconds East 6,052.52 feet to a point having Coordinates of X = 2,741,371.00 and Y = 176,078.11; thence South 5,380.11 feet to the point of beginning, containing approximately **171.22 acres**, as shown outlined on a plat on file in the Office of Mineral Resources, Department of Natural Resources, as provided by the applicant. All bearings, distances and coordinates are based on Louisiana Coordinate System of 1927 (South Zone).

NOTE: The above description of the tract nominated for lease has been provided exclusively by the party nominating the tract for lease. The Louisiana State Mineral Board makes no representation as to the accuracy of the description of the nominated tract or its suitability for lease. The Louisiana State Mineral Board has made no inspection of the nominated tract for the existence of conflicting leases, operating agreements, private claims or other existing or future obligations or conditions which may affect all or any portion of the nominated tract or its suitability for lease.

Maps depicting the nominated tract, containing the bearings, distances and coordinates of the nominated tract based on the Louisiana Coordinate System of 1927, North or South Zone, as applicable, are available for public inspection and review at the offices of the Louisiana State Mineral Board from 10:00 a.m. to 3:00 p.m. Monday - Friday.

In the event of conflict between the description of the nominated tract set forth above and the description of the nominated property as contained on the maps maintained at the offices of the Louisiana State Mineral Board, the Louisiana State Mineral Board maps shall prevail and shall provide the final property description of the lease to be awarded of the nominated tract.

Any mineral lease of the nominated tract by the Louisiana State Mineral Board shall be without warranty of any kind, either express, implied, or statutory, including, but not limited to, the implied warranties or merchantability and fitness for a particular purpose. Should the mineral lease of the nominated tract awarded by the Louisiana State Mineral Board be subsequently modified, cancelled or abrogated due to the existence of conflicting leases, operating agreements, private claims or other existing of future obligations or conditions which may affect all or any portion of the leased tract, it shall not relieve the Lessee of the obligation to pay any bonus due thereon to the Louisiana State Mineral Board, nor shall the Louisiana State Mineral Board be obligated to refund any consideration paid by the Lessee prior to such modification, cancellation, or abrogation, including, but not limited to, bonuses,

rents and royalties.

NOTE: The State of Louisiana does hereby reserve, and this lease shall be subject to, the imprescriptible right of surface use in the nature of a servitude in favor of the Department of Natural Resources, including its Offices and Commissions, for the sole purpose of implementing, constructing, servicing and maintaining approved coastal zone management and/or restoration projects. Utilization of any and all rights derived under this lease by the mineral lessee, its agents, successors or assigns, shall not interfere with nor hinder the reasonable surface use by the Department of Natural Resources, its Offices or Commissions, as hereinabove reserved.

Applicant: Harold J. Anderson, Inc.

Bidder	Cash Payment	Price / Acre	Rental	Oil	Gas	Other

PASS A LOUITRE WILDLIFE MANAGEMENT AREA

PROPOSED TRACT
±171.22 Acres

BIK. 5

SL 1927,
As Amended

SL 15339

TR 34115
171.22 ± ACS.
JAN., 2002

P. O. B.
X=2,741,371.00
Y= 170,698.00

Platform

BIK. 7

BIK. 6

BLOCK 6

SOUTH PASS AREA

OIL FIELD

MAD 27 LAMBERT LA. SOUTH ZONE

Plaquemines Parish, Louisiana

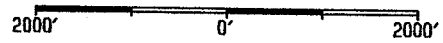

TRACT 34116 - PORTION OF BLOCK 6, SOUTH PASS AREA, Plaquemines Parish, Louisiana

All of the lands now or formerly constituting the beds and bottoms of all water bodies of every nature and description and all islands and other lands formed by accretion or reliction, except tax lands, belonging to the State of Louisiana and not under mineral lease on January 9, 2002, situated in Plaquemines Parish, Louisiana, and more particularly described as follows: Beginning at a point on the North line of Block 6, South Pass Area, having Coordinates of X = 2,741,371.00 and Y = 170,698.00; thence South 7,379.00 feet to a point having Coordinates of X = 2,741,371.00 and Y = 163,319.00; thence West 6,575.37 feet to a point having Coordinates of X = 2,734,795.63 and Y = 163,319.00; thence North 27 degrees 15 minutes 51 seconds East 8,301.23 feet to a point on the North line of said Block 6 having Coordinates of X = 2,738,598.38 and Y = 170,698.00; thence East 2,772.62 feet along the North line of said Block 6 to the point of beginning, containing approximately **791.77 acres**, as shown outlined on a plat on file in the Office of Mineral Resources, Department of Natural Resources, as provided by the applicant. All bearings, distances and coordinates are based on Louisiana Coordinate System of 1927 (South Zone).

NOTE: The above description of the tract nominated for lease has been provided exclusively by the party nominating the tract for lease. The Louisiana State Mineral Board makes no representation as to the accuracy of the description of the nominated tract or its suitability for lease. The Louisiana State Mineral Board has made no inspection of the nominated tract for the existence of conflicting leases, operating agreements, private claims or other existing or future obligations or conditions which may affect all or any portion of the nominated tract or its suitability for lease.

Maps depicting the nominated tract, containing the bearings, distances and coordinates of the nominated tract based on the Louisiana Coordinate System of 1927, North or South Zone, as applicable, are available for public inspection and review at the offices of the Louisiana State Mineral Board from 10:00 a.m. to 3:00 p.m. Monday - Friday.

In the event of conflict between the description of the nominated tract set forth above and the description of the nominated property as contained on the maps maintained at the offices of the Louisiana State Mineral Board, the Louisiana State Mineral Board maps shall prevail and shall provide the final property description of the lease to be awarded of the nominated tract.

Any mineral lease of the nominated tract by the Louisiana State Mineral Board shall be without warranty of any kind, either express, implied, or statutory, including, but not limited to, the implied warranties or merchantability and fitness for a particular purpose. Should the mineral lease of the nominated tract awarded by the Louisiana State Mineral Board be subsequently modified, cancelled or abrogated due to the existence of conflicting leases, operating agreements, private claims or other existing of future obligations or conditions which may affect all or any portion of the leased tract, it shall not relieve the Lessee of the obligation to pay any bonus due thereon to the Louisiana State Mineral Board, nor shall the Louisiana State Mineral Board be obligated to refund any

consideration paid by the Lessee prior to such modification, cancellation, or abrogation, including, but not limited to, bonuses, rents and royalties.

NOTE: The State of Louisiana does hereby reserve, and this lease shall be subject to, the imprescriptible right of surface use in the nature of a servitude in favor of the Department of Natural Resources, including its Offices and Commissions, for the sole purpose of implementing, constructing, servicing and maintaining approved coastal zone management and/or restoration projects. Utilization of any and all rights derived under this lease by the mineral lessee, its agents, successors or assigns, shall not interfere with nor hinder the reasonable surface use by the Department of Natural Resources, its Offices or Commissions, as hereinabove reserved.

Applicant: Harold J. Anderson, Inc.

Bidder	Cash Payment	Price / Acre	Rental	Oil	Gas	Other

PASS A LOUITRE WILDLIFE MANAGEMENT AREA

SL 15339

229

Bik. 5

Platform

SL 1927,
As Amended

P. O. B.
X=2,741,371.00
Y= 170,698.00

BLOCK 6

OIL FIELD

TR 34116
791.77 ± ACS.
JAN., 2002

Bik. 7

Bik. 6

SOUTH PASS AREA

NAD 27 LAMBERT LA. SOUTH ZONE

Plaquemines Parish, Louisiana

2000' 0' 2000'

TRACT 34117 - St. James Parish, Louisiana

All of the lands now or formerly constituting the beds and bottoms of all water bodies of every nature and description and all islands and other lands formed by accretion or reliction, except tax lands, owned by and not under mineral lease from the State of Louisiana on January 9, 2002, situated in St. James Parish, Louisiana, within the following described boundaries: Beginning at a point having Coordinates of X = 2,137,230.00 and Y = 511,500.00; thence East 18,470.00 feet to a point having Coordinates of X = 2,155,700.00 and Y = 511,500.00; thence South 7,500.00 feet to a point having Coordinates of X = 2,155,700.00 and Y = 504,000.00; thence West 18,470.00 feet to a point having Coordinates of X = 2,137,230.00 and Y = 504,000.00; thence North 7,500.00 feet to the point of beginning, containing approximately **982 acres**, as shown outlined on a plat on file in the Office of Mineral Resources, Department of Natural Resources, as provided by the applicant. All bearings, distances and coordinates are based on Louisiana Coordinate System of 1927 (South Zone).

NOTE: The above description of the tract nominated for lease has been provided exclusively by the party nominating the tract for lease. The Louisiana State Mineral Board makes no representation as to the accuracy of the description of the nominated tract or its suitability for lease. The Louisiana State Mineral Board has made no inspection of the nominated tract for the existence of conflicting leases, operating agreements, private claims or other existing or future obligations or conditions which may affect all or any portion of the nominated tract or its suitability for lease.

Maps depicting the nominated tract, containing the bearings, distances and coordinates of the nominated tract based on the Louisiana Coordinate System of 1927, North or South Zone, as applicable, are available for public inspection and review at the offices of the Louisiana State Mineral Board from 10:00 a.m. to 3:00 p.m. Monday - Friday.

In the event of conflict between the description of the nominated tract set forth above and the description of the nominated property as contained on the maps maintained at the offices of the Louisiana State Mineral Board, the Louisiana State Mineral Board maps shall prevail and shall provide the final property description of the lease to be awarded of the nominated tract.

Any mineral lease of the nominated tract by the Louisiana State Mineral Board shall be without warranty of any kind, either express, implied, or statutory, including, but not limited to, the implied warranties or merchantability and fitness for a particular purpose. Should the mineral lease of the nominated tract awarded by the Louisiana State Mineral Board be subsequently modified, cancelled or abrogated due to the existence of conflicting leases, operating agreements, private claims or other existing or future obligations or conditions which may affect all or any portion of the leased tract, it shall not relieve the Lessee of the obligation to pay any bonus due thereon to the Louisiana State Mineral Board, nor shall the Louisiana State Mineral Board be obligated to refund any consideration paid by the Lessee prior to such modification, cancellation, or abrogation, including, but not limited to, bonuses, rents and royalties.

NOTE: The State of Louisiana does hereby reserve, and this lease shall be subject to, the imprescriptible right of surface use in the nature of a servitude in favor of the Department of Natural Resources, including its Offices and Commissions, for the sole purpose of implementing, constructing, servicing and maintaining approved coastal zone management and/or restoration projects. Utilization of any and all rights derived under this lease by the mineral lessee, its agents, successors or assigns, shall not interfere with nor hinder the reasonable surface use by the Department of Natural Resources, its Offices or Commissions, as hereinabove reserved.

Applicant: Gina Guillory

Bidder	Cash Payment	Price / Acre	Rental	Oil	Gas	Other

T11S-R3E

TR 34117
982 ± ACS.
JAN., 2002

T12S-R16E

P. O. B.
X=2,137,230.00
Y= 511,500.00

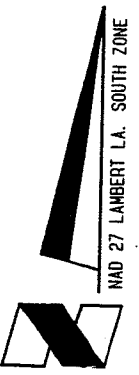
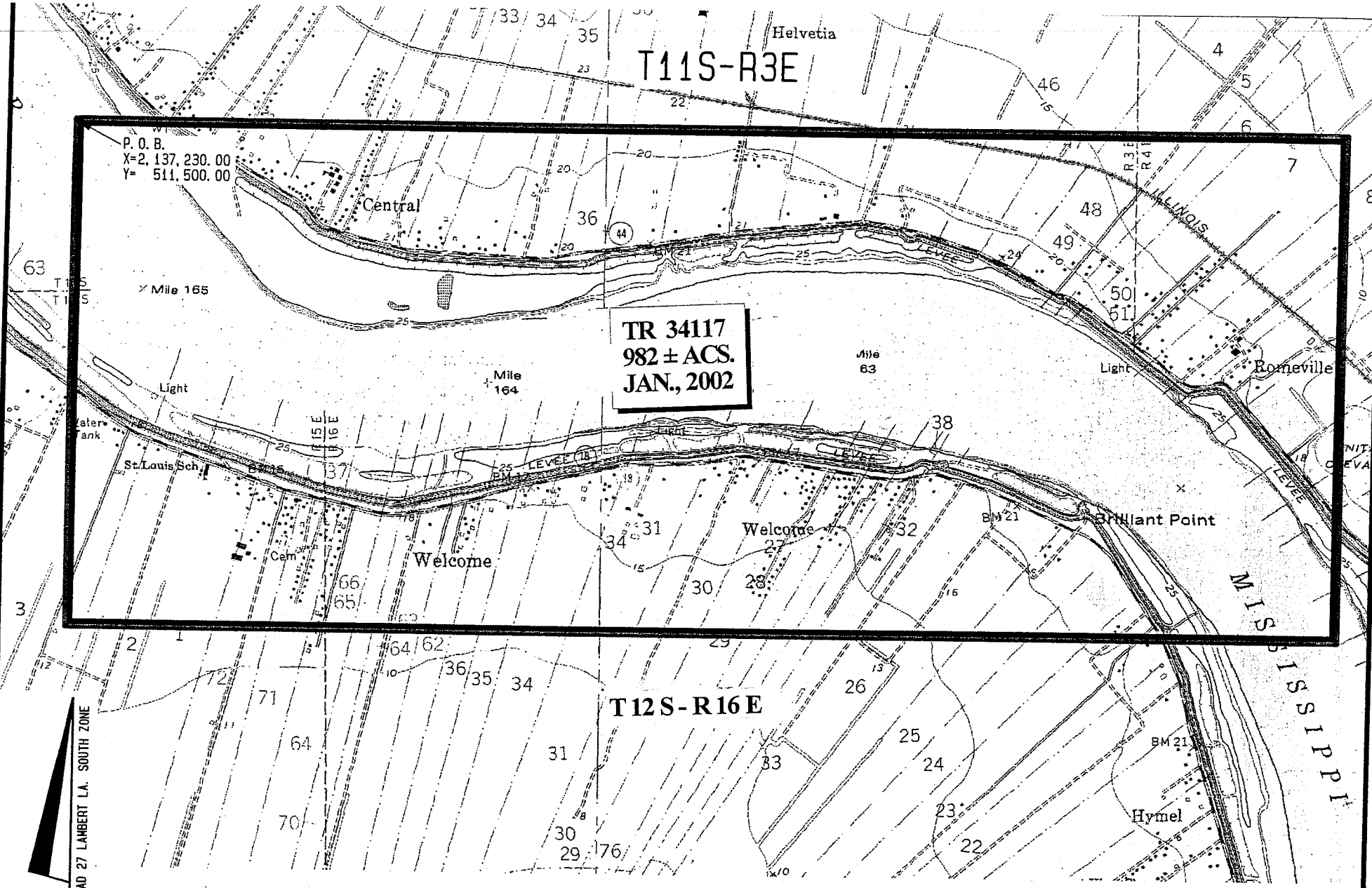

St. James Parish, Louisiana

232