

LISKOW & LEWIS

A Professional Law Corporation

822 Harding Street
Post Office Box 52008
Lafayette, LA 70505
(337) 232-7424 Main
(337) 267-2399 Fax

www.Liskow.com

One Shell Square
701 Poydras Street, Suite 5000
New Orleans, LA 70139
(504) 581-7878 Main
(504) 581-4108 Fax

First City Tower
1001 Poydras Suite 1800
Houston, TX 77002
(713) 651-2900 Main
(713) 651-2908 Fax

January 7, 2011

Richard W. Revels, Jr.
rwrevels@liskow.com

Honorable James H. Welsh
Commissioner of Conservation
Office of Conservation
P. O. Box 94275
Baton Rouge, LA 70804-4275

Re: Jurassic Zone, Reservoir A
Bayou San Miguel Field
Sabine Parish, Louisiana

Dear Commissioner Welsh:

Application is hereby made on behalf of **SWEPI LP**, for the calling of a public hearing, after ten (10) days legal notice, to consider evidence relative to the issuance of an order pertaining to the following matters:

1. To permit the applicant to drill, designate and utilize its Olympia Minerals 25H No. 1 Well as unit well for the JUR RA SUH, at the location shown on the plat attached hereto, in exception to the spacing provisions of Office of Conservation Order No. 1513, effective January 23, 2008, or within a radius of 100 feet thereof, but in no event closer than 330 feet from the nearest unit line and 660 feet from the nearest offset Jurassic or Haynesville Zone well to account for any slight variation in the actual "as drilled" location.
2. To find that the proposed unit well at the location shown is necessary to efficiently and economically drain a portion of the reservoir covered by the unit in which it is situated and that use of such well will not adversely affect offset owners.
3. To designate SWEPI LP as unit operator.
4. Except to the extent contrary herewith, to continue in full force and effect the provisions of Office of Conservation Order No. 1513, effective January 23, 2008, as amended and supplemented by the 1513-C Series of Orders, and applicable Statewide Orders.
5. To consider such other matters as may be pertinent.

The Jurassic Zone, Reservoir A, in Bayou San Miguel Field, Sabine Parish, Louisiana, was defined in Office of Conservation Order No. 1513, effective January 23, 2008.

January 7, 2011

Attached hereto and made a part hereof is a plat outlining the applicant's proposal along with a list of the names and addresses of the Interested Owners, Represented Parties and Interested Parties to whom a copy of this application is being sent. Pursuant to the Revised Rules of Procedure, the list of parties is being furnished ONLY to the Commissioner of Conservation and to the District Manager of the Shreveport District of the Office of Conservation. However, the list of parties will be provided to any party requesting a copy of it. A reasonable effort was made to ascertain the names and addresses of all Interested Owners, Interested Parties and Represented Parties.

Finally, enclosed is our check on behalf of the applicant in the amount of \$755.00 made payable to the Office of Conservation and representing the required hearing application fee.

Sincerely,

LISKOW & LEWIS

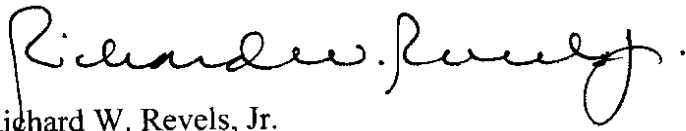

Richard W. Revels, Jr.

RWRjr:dbf
Enclosures

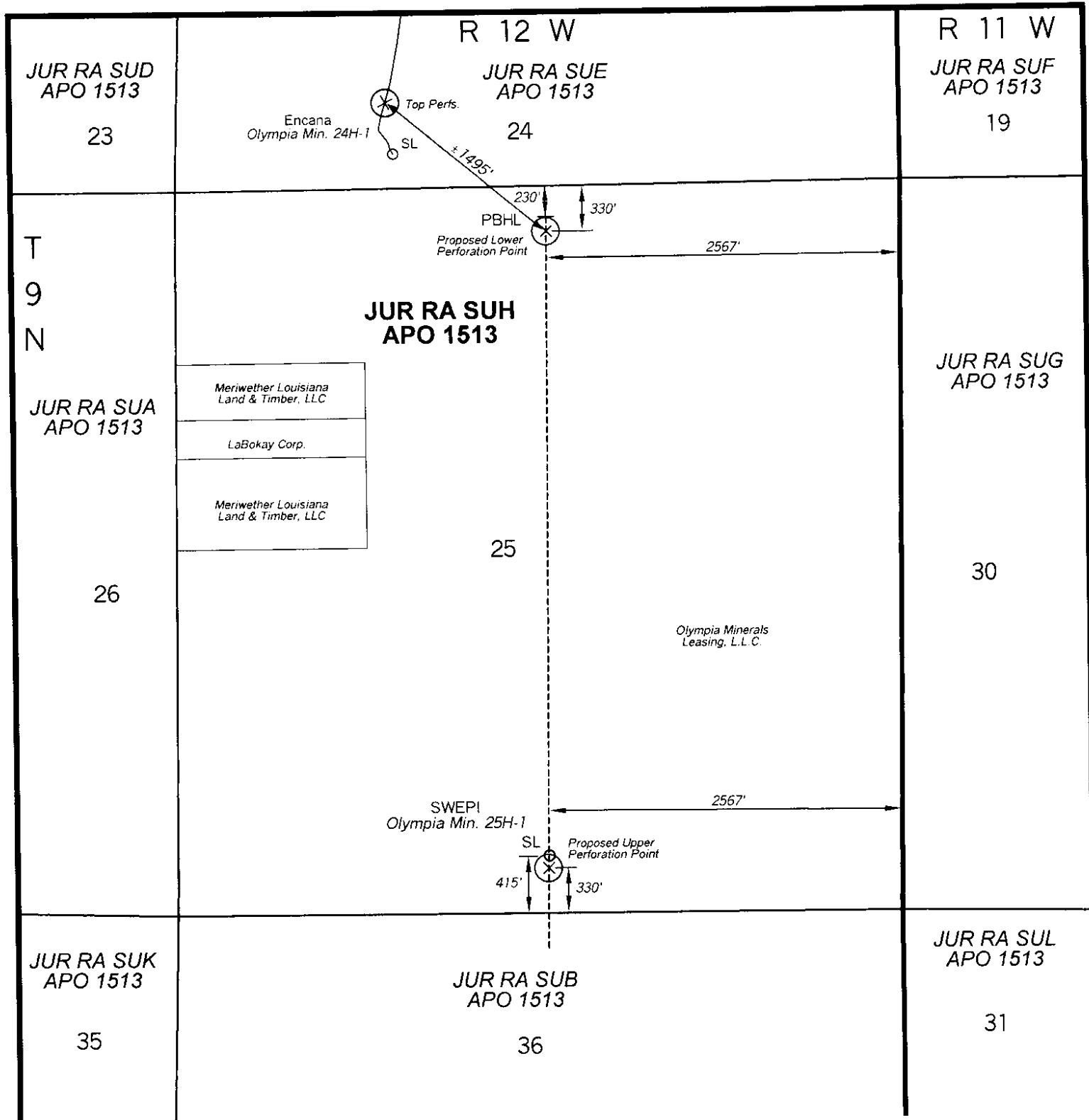

EXHIBIT NO.
DOCKET NO.

DATE:

ENCANA OIL & GAS (USA) INC.

**BAYOU SAN MIGUEL FIELD
SABINE PARISH, LOUISIANA**

**PROPOSED UNIT WELL AT
AN EXCEPTIONAL LOCATION
JUR RA SUH**

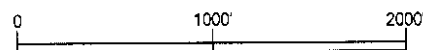

W. H. ROBBINS & ASSOCIATES LLC
CONSULTING GEOLOGISTS
Lafayette, Louisiana (337) 232-5004

Note: Only Haynesville wells shown.